



Offices also at: Wilmslow, Macclesfield, Hale, Sale, Chorlton, Glossop, Manchester & Salford

www.jordanfishwick.co.uk  
wilmslow@jordanfishwick.co.uk

01625 532000

36-38 Alderley Road, Wilmslow, Cheshire, SK9 1JX

These particulars are believed to be accurate but they are not guaranteed and do not form a contract. Neither Jordan Fishwick nor the vendor or lessor accept any responsibility in respect of these particulars, which are not intended to be statements or representations of fact and any intending purchaser or lessee must satisfy himself by inspection or otherwise as to the correctness of each of the statements contained in these particulars. Any floorplans on this brochure are for illustrative purposes only and are not necessarily to scale.

Whilst every attempt has been made to ensure the accuracy of the floor plan contained here, measurements of doors, windows, rooms and any other items are approximate and no responsibility is taken for any error, omission, or mis-statement. This plan is for illustrative purposes only and should be used as such by any prospective purchaser. The services, systems and appliances shown have not been tested and no guarantee as to their operability or efficiency can be given

Made with Metropix ©2019

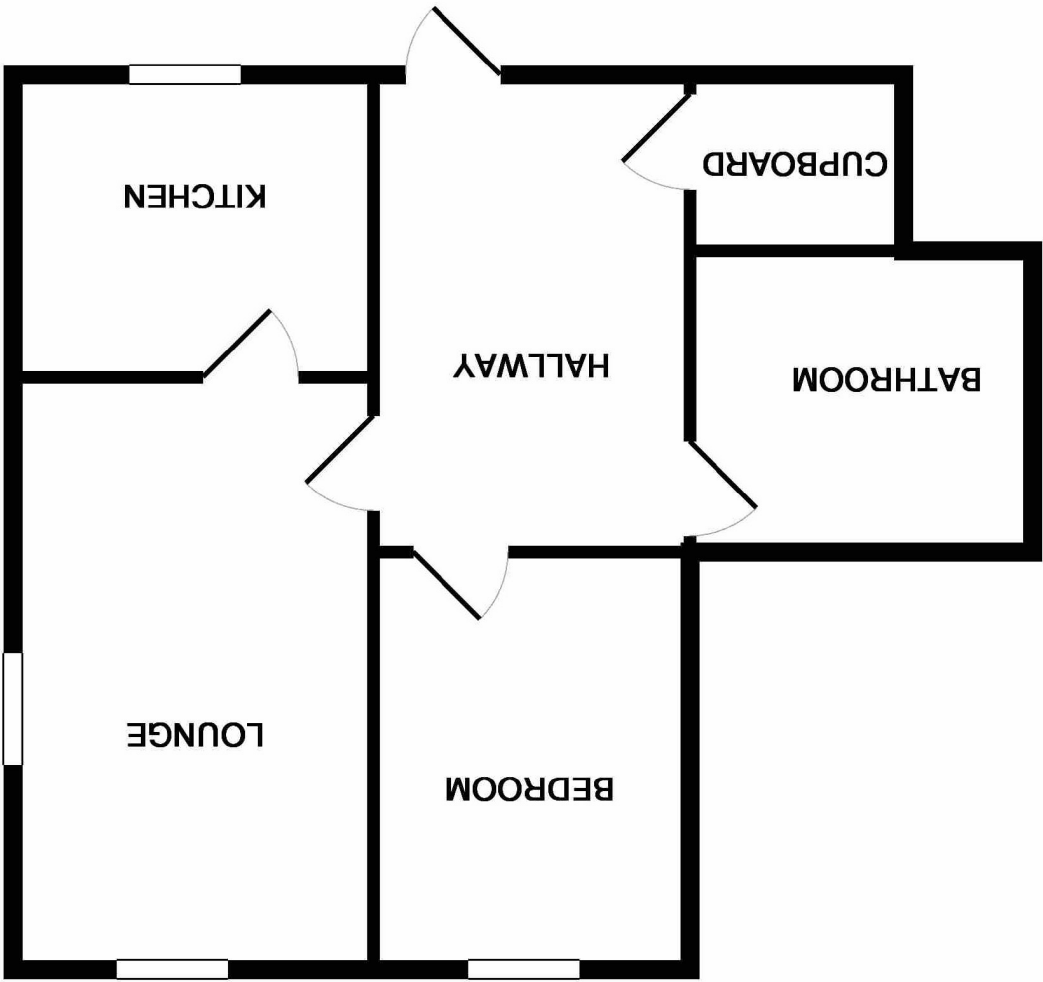

*jordan*fishwick

WILMSLOW  
2 Newbury Court, WILMSLOW, SK9 5JD





Newbury Court, WILMSLOW  
SK9 5JD  
£650 Per calendar month



**The Property**

WILMSLOW - PART FURNISHED AVAILABLE MID DECEMBER A ground floor apartment in a quiet residential area. The accommodation which is warmed by night storage heaters comprises:- entrance hall, sitting room overlooking the communal garden area, fitted kitchen with electric cooker, automatic washing machine and fridge. Double bedroom with wardrobes and bathroom with shower. Communal gardens. Private Off Road Parking. £650.00pcm Contact Wilmslow 01625 536300

**Directions**

From our Wilmslow office proceed along Alderley Road in a southerly direction to the Kings Arms roundabout. Take the third exit into Bedells Lane, and turn left before the Carters Arms into Chapel Lane. Take the next turning on the right hand side into Lindfield Estate South and the property will be identified by our For Let board

- ONE BEDROOM APARTMENT
- PART FURNISHED
- OFF ROAD PARKING
- COMMUNAL GARDENS

Postcode - SK9 5JD

EPC Rating - D

Floor Area - sq ft

Local Authority -

Council Tax - Band

