



Abingdon Road
Wolverhampton
WV1 2PS

Asking Price Of £135,000



No Chain - Two bedroom semi-detached home with good size accommodation comprising hallway, living room, kitchen, conservatory, two bedrooms and shower room. There is a driveway providing off road parking and to the rear is a generous garden.

APPROACH

The property is approached via a brick paved driveway providing off road parking.

ENTRANCE HALL

Staircase to the first floor landing and doors to the kitchen and living room.

LIVING ROOM 16' 10" x 9' 6" (5.14m x 2.91m)

Double glazed bow window to the front, double glazed sliding patio door to the rear and a sliding door into the kitchen.

KITCHEN 16' 10" x 12' 1" (5.14m x 3.69m max, 2.7m min)

Double glazed windows to the front and rear, part tiled walls and a range of wall, drawer and base units with roll edge work surfaces over incorporating stainless steel sink and drainer unit with mixer tap. There is space for a cooker, fridge freezer, washing machine and tumble dryer. A part glazed doors lead into the conservatory and a side veranda.

CONSERVATORY 9' 5" x 9' 3" (2.89m x 2.83m)

Double glazed to the side and rear and door to the rear garden.

SIDE VERANDA

Double glazed obscure window to the rear, part glazed door to the rear, part glazed door to the front and base units with roll edge work surfaces above.

FIRST FLOOR LANDING

Loft access hatch, airing cupboard and doors to:

BEDROOM ONE 16' 9" x 8' 11" (5.12m x 2.74m)

Double glazed windows to the front and rear.

BEDROOM TWO 10' 11" x 9' 7" (3.34m x 2.94m)

Double glazed window to the front and storage cupboard.

SHOWER ROOM Double glazed obscure window to the rear. ceiling down lighters, towel rail, corner shower enclosure with electric shower, and vanity unit with sink and mixer tap above.

W.C

Double glazed obscure window to the rear, part tiled walls and low level w.c.

REAR GARDEN

To the rear of the property is a very good size paved garden.



Asking Price Of £135,000

Ground Floor



First Floor

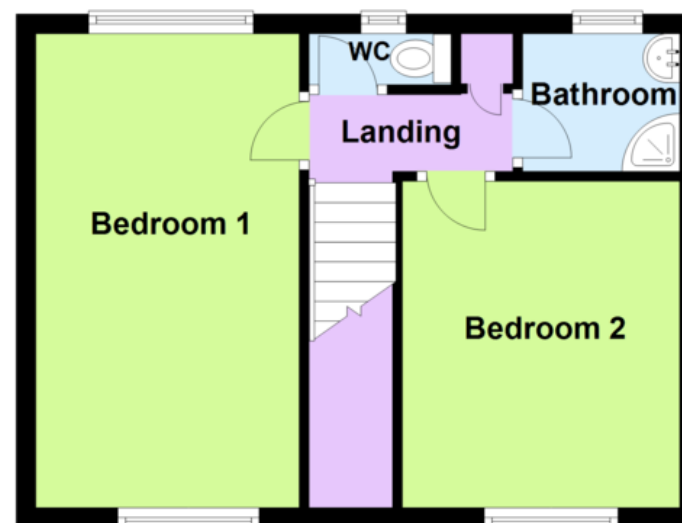

13 Waterloo Road, Wolverhampton WV1 4DJ Fax: 01902 712956 Email: info@swfestateagents.co.uk

Residential Sales • Valuers • Residential Lettings • Property Management

Tel: 01902 575555 www.swfestateagents.co.uk

rightmove
find your happy

