

Kennedys'

EST. 2004

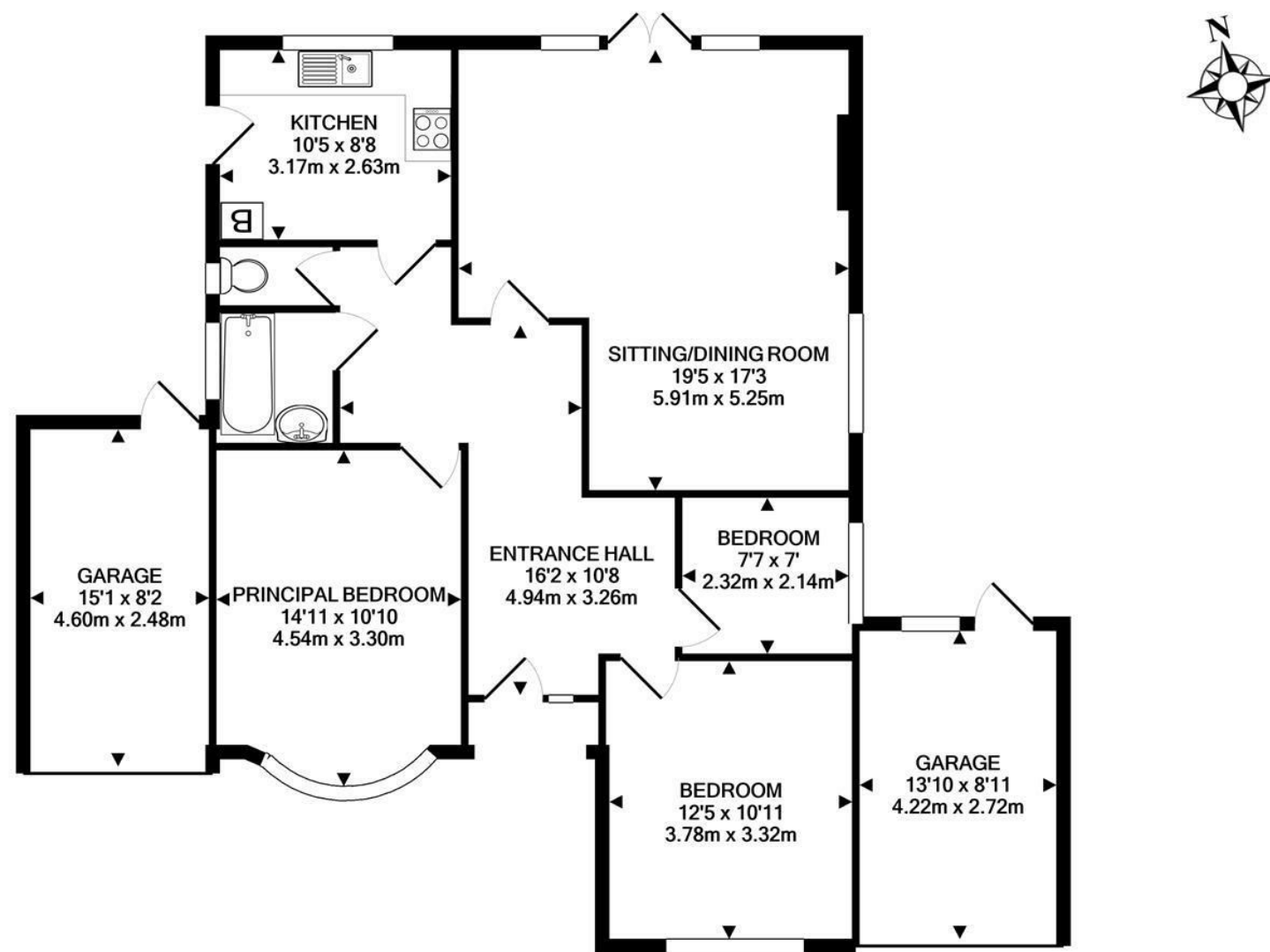

TOTAL APPROX. FLOOR AREA 1185 SQ.FT. (110.1 SQ.M.)  
 Whilst every attempt has been made to ensure the accuracy of the floor plan contained here, measurements of doors, windows, rooms and any other items are approximate and no responsibility is taken for any error, omission, or mis-statement. This plan is for illustrative purposes only and should be used as such by any prospective purchaser. The services, systems and appliances shown have not been tested and no guarantee as to their operability or efficiency can be given  
 Made with Metropix ©2021

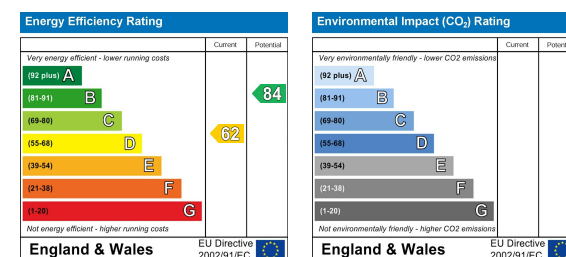

Kennedys'  
 EST. 2004

16 | White Beam Way | Tadworth | Surrey  
 KT20 5DL

48 Walton Street, Tadworth, KT20 7RT  
 Tel: 01737 817718 Email: info@kennedys-ipa.co.uk  
 www.kennedys-ipa.co.uk - Kennedys' Residential Ltd

These particulars, whilst believed to be accurate are set out as a general guide only for guidance and do not constitute any part of an offer or contract. Intending purchasers should not rely on them as statements of representation of fact, but must satisfy themselves by inspection or otherwise as to their accuracy. No person in Kennedys' has the authority to make or give any representation or warranty in respect of the property.





## 16 | White Beam Way | Tadworth | Surrey | KT20 5DL

Situated and well located on this popular cul-de-sac on the edge of the Epsom Downs and a short walk into Tadworth village is this deceptively substantial three-bedroom detached bungalow benefitting from an exceptional corner plot with two attached single garages and private driveway.

### Property Description

This delightful bungalow offers well-proportioned accommodation comprising, very spacious entrance hall, two good sized double bedrooms and one single bedroom, a family bathroom and separate W.C, spacious sitting/dining room with French doors onto the garden and fitted kitchen with side access onto a separate terrace.

The property is in immaculate condition and benefits from an upgraded boiler and upvc windows and doors to the rear and already offers well laid out spacious accommodation, however, if so desired this property lends itself to being re-configured and extended to create a wonderful contemporary home – a truly fabulous opportunity.

The loft space is un-boarded but partially insulated and offers good head room.

Outside, the property offers parking for two cars, and side access to the rear. The garages, both have rear access from the garden, which is a real feature of this property, currently its mainly laid to lawn with some established mature trees and lends itself to further landscaping. There is a terrace to one side of the property and a lean to shed for garden storage.

We highly recommend an internal viewing of this property to fully appreciate what is on offer.

Tadworth village is within a short walk and is well served by local shops and facilities including independent traders such as butcher, fishmonger, baker, dry cleaners and vet as well as a choice of restaurants, village supermarket and mainline train station to London.

There are a variety of schools within the area including Tadworth Primary School, Chinthurst Prep School, Tadworth & Walton on the Hill Primary Schools and the renowned City of London Freeman's School and Epsom College. Golfers are well catered for in the area, with a choice of challenging courses, including the famous Walton Heath Golf Club, where David Lloyd George and Winston Churchill were members. With the Epsom Downs, and the famous racecourse so close to home, equestrian facilities are in abundance and the surrounding landscape is criss-crossed with bridleways and footpaths to explore. Cycling is also very popular in the area; nearby Box Hill is famous for its challenging climb, as well as its far-reaching panoramic views. For more extensive shopping Epsom Town Centre, Banstead and Reigate are only a short drive away and offer a good combination of both High Street and independent shops, Cinemas as well as restaurants and bars.

**Price: £735,000**

