



Flat 1st Floor Lancaster Grove, , London NW3 4EX

This one-of-a-kind two-bedroom flat has been styled to feature contemporary interiors and eclectic furnishings. Open lounge/dining room was designed to present a vast amount of space and light throughout, and further benefits from a smart home system including an inbuilt audio system. Fully integrated kitchen is complemented with marble countertops, a smart fridge, and a breakfast bar.

Two large double bedrooms boost of storage, with the master bedroom being en-suite with a walk-in wardrobe. The apartment is styled with solid wood Herringbone flooring, free-standing ceramic bathtub, Grohe Sanitaryware, and other fixtures and fittings from Buster and Punch, Hermes, and Armani Casa. The apartment is also fitted with high spec

- Solid Wooden Flooring
- Double Glazing
- Unique Design
- Smart Home Audio System
- Enhanced Security System
- Central Location
- Furnished/Unfurnished
- Period House
- Walk-in wardrobe & Built-in Storage

£3,948 Per Month

Floor Plan

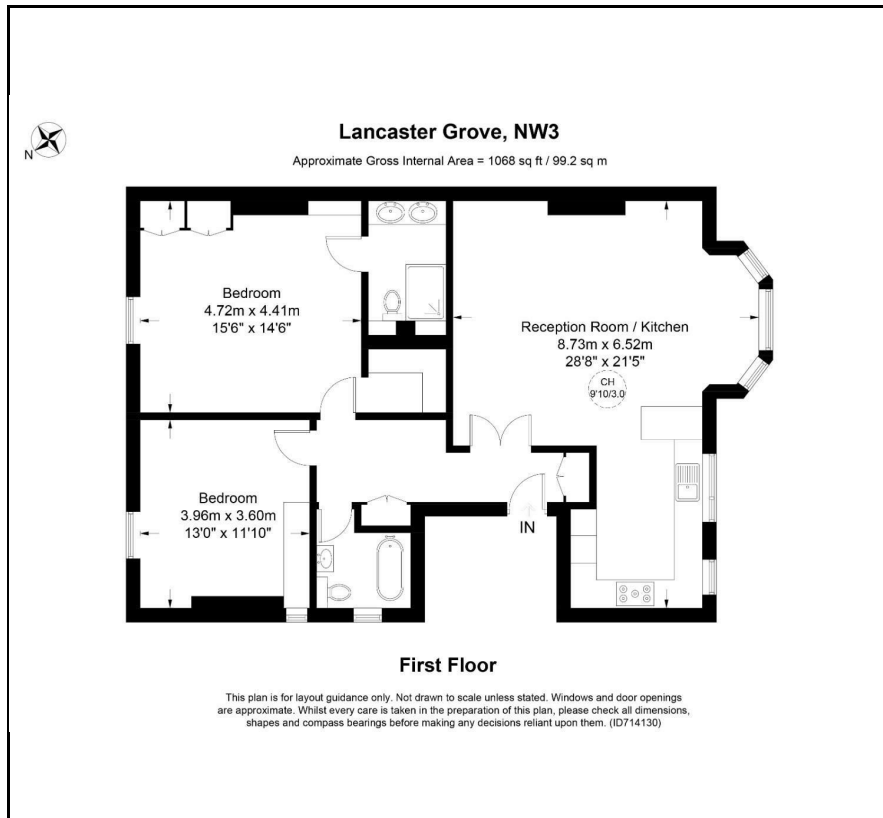

Area Map



Energy Efficiency Graph

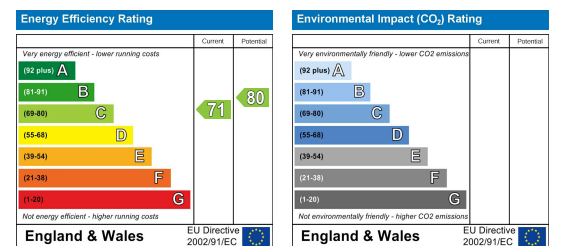

Viewing

Please contact our AZ Real Estate Office on 0203 871 4077 if you wish to arrange a viewing appointment for this property or require further information.

double glazed sash windows and an integrated security system.

Lancaster Grove is ideally located in the heart of Belsize Park with easy to both the Jubilee Line (Swiss Cottage - 0.5 miles) and the Northern Line (Belsize Park - 0.5 miles). Belsize Terrace with its charming shops, cafes and restaurants are within easy reach.



These particulars, whilst believed to be accurate are set out as a general outline only for guidance and do not constitute any part of an offer or contract. Intending purchasers should not rely on them as statements of representation of fact, but must satisfy themselves by inspection or otherwise as to their accuracy. No person in this firm's employment has the authority to make or give any representation or warranty in respect of the property.