



59 Benbow Quay, Coton Hill, Shrewsbury, SY1 2DL

1 bedroom apartment — £135,000 Leasehold

59 Benbow Quay, Coton Hill, Shrewsbury, SY1 2DL

Coopergreenpooks.co.uk

£135,000 Leasehold—1 bedroom apartment

Coopergreenpooks.co.uk/property/22431

A spacious town centre apartment offering well planned accommodation, occupying an elevated position within this popular modern development with fantastic views of the River Severn to front and towards Haughmond Hill to the rear.

KEY FEATURES

- Entrance hall with storage cupboard and telephone entry system
- Lovely light open plan living/dining area overlooking the river and playing fields beyond
- Fitted kitchen with integrated appliances
- Good sized master bedroom with built in wardrobes and views to rear
- Bathroom with vanity unit and shower
- uPVC double glazed windows and electric heating
- Private allocated parking space
- Attractive communal gardens for residents use
- A stone's throw from a range of bars, restaurants, the train station and main shopping areas

Cooper Green Pooks
3 Barker Street
Shrewsbury
SY1 1QF

www.cgpooks.co.uk
sales@cgpooks.co.uk
01743 276666



THIRD FLOOR

APPROX. 51.8 SQ. METRES (557.1 SQ. FEET)

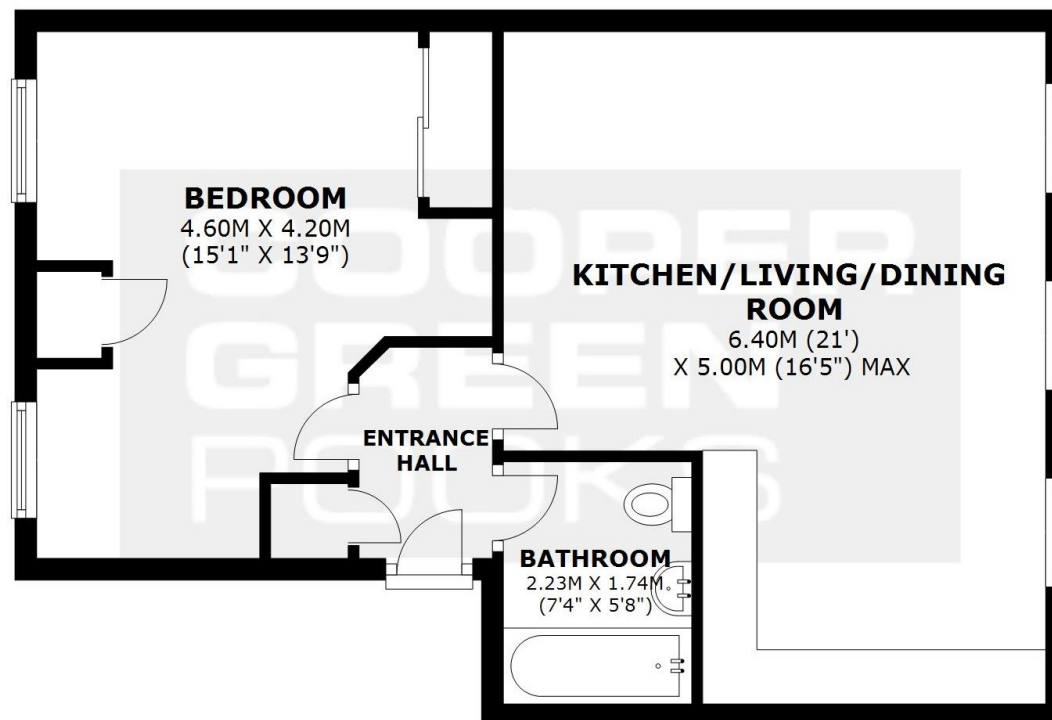

TOTAL AREA: APPROX. 51.8 SQ. METRES (557.1 SQ. FEET)

We accept no responsibility for any mistake or inaccuracy contained within the floorplan. The floorplan is provided as a guide only and should be taken as an illustration only. The measurements, contents and positioning are approximations only and provided as a guidance tool and not an exact replication of the property.
Plan produced using PlanUp.





59 Benbow Quay, Coton Hill, Shrewsbury, SY1 2DL

Coopergreenpooks.co.uk

£135,000 Leasehold—1 bedroom apartment

Coopergreenpooks.co.uk/property/22431



Tenure	Leasehold
Lease	186 years from July 2018
Ground rent	£100pa
Service charge	£1083pa
Local Authority	Shropshire Council
Council Tax	A
Services	Mains water, electricity and drainage are connected

rightmove

onTheMarket.com



RICS

59 Benbow Quay, Coton Hill, Shrewsbury, SY1 2DL

Coopergreenpooks.co.uk

£135,000 Leasehold—1 bedroom apartment

Coopergreenpooks.co.uk/property/22431

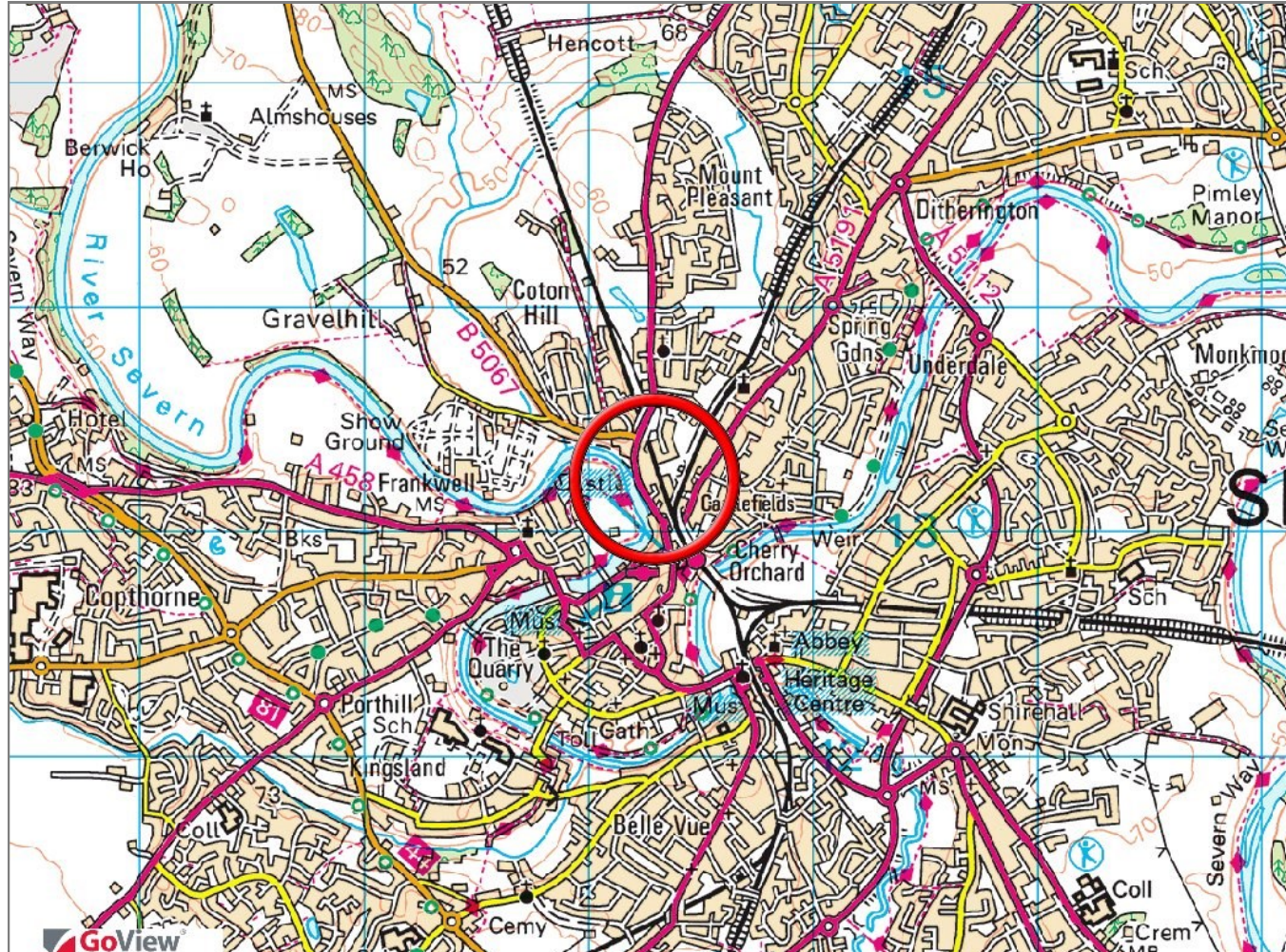

IMPORTANT NOTICE: Cooper Green Pooks for themselves and for the lessors or vendors of this property whose agents they are give notice that: 1 No appliances, services or service installations have been tested and no warranty as to suitability or serviceability is implied. Any prospective purchaser or lessee is advised to obtain verification from their surveyor or solicitor. 2. The particulars are set out as a general outline only for the guidance of the intended purchasers or lessees and do not constitute, nor constitute part of, an offer or contract. 3. All descriptions, reference to condition and necessary permissions for use and occupation and other details are given in good faith and are believed to be correct but any intending purchasers or lessees should not rely on them as statements or representation of fact but satisfy themselves by inspection or otherwise as to the correctness of each of them. 4. No person in the employment of Cooper Green Pooks has any authority to make or give any representation or warranty whatsoever in relation to this property. 5. All rentals and prices are quoted exclusive of Stamp Duty, legal and surveyors fees and any other associated purchasers or lessees costs. 6. Floor plans are indicative only and should not be relied on. 7. The plan showing the boundary of the property is indicative only and has not been checked against the legal title so should not be relied on. 8. All dimensions, floor areas and site areas are only approximate and should not be relied on. Dimensions are generally maximum room dimension.