

Property Connections



Estate Agent

01506 650 550



132 Glenburn Gardens, Whitburn

GROUND FLOOR

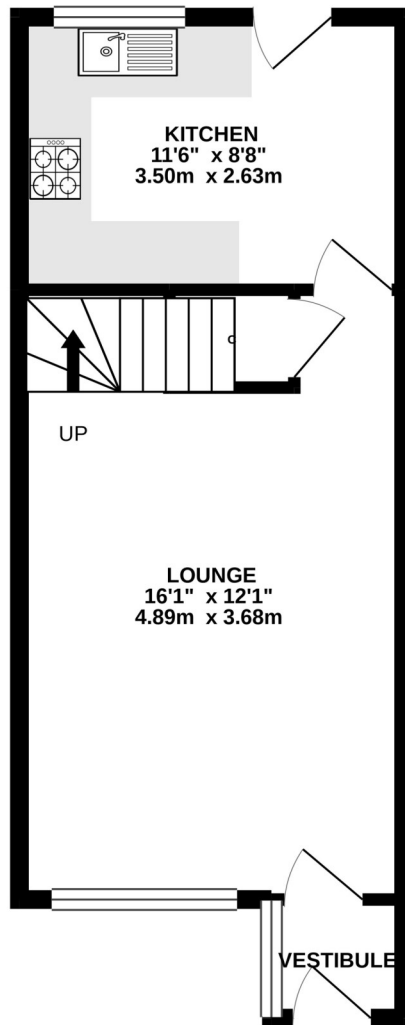

1ST FLOOR

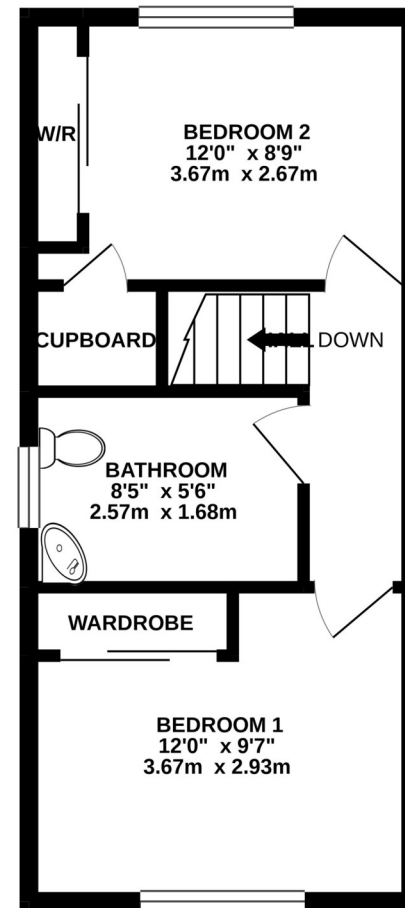

Offering excellent accommodation over two levels, this 2 bedroom semi-detached home with west facing rear garden and driveway is well presented and will make an ideal purchase for a first time buyer or empty nester.

The well proportioned lounge overlooks the front aspect and is complete with neutral décor and carpet flooring, with stairs leading to the upper apartments and cupboard offering excellent storage.





The dining kitchen is fitted with an excellent range of base and wall mounted units with contrasting worktop and splashback.

Integrated appliances include the gas hob with electric oven and hood and there are appliance spaces for free standing washing machine and fridge freezer. Door to rear garden.



Bedroom one is a double bedroom overlooking the front aspect, with fitted mirror fronted wardrobes, fresh décor and carpet flooring.





Bedroom two is also a double bedroom with built in storage, overlooking the rear aspect, and is again finished with light décor with carpet flooring.

The shower room has an opaque glazed window for natural daylight and is fitted with a white suite, with full height wall tiling, and wet room floor. Shower and screen.





Externally, the front garden is fully enclosed and laid to lawn with the slabbed, shared accessed driveway, leading to the single garage. The west facing rear garden is hard landscaped with mono block pavers for ease of maintenance. There are two garden sheds which are included in the sale.

Included in the sale are all fitted floor coverings, window blinds, integrated kitchen appliances, and the garden sheds.

Whilst the above particulars are believed to be correct, they are not warranted and do not form part of any contract.