



57 Glebe Villas, Hove BN3 5SL

Offers In Excess Of £600,000

- THREE BEDROOMS
- BATHROOM
- KITCHEN/BREAKFAST ROOM
- LIVING ROOM
- DINING ROOM
- REAR GARDEN
- UPVC DOUBLE GLAZED WINDOWS
- GAS CENTRAL HEATING

This semi-detached family home offers good size three bedroom accommodation being presented in good decorative order with the kitchen/breakfast room having bi-fold doors on to the rear garden. There are two separate reception rooms to the ground floor and a modern bathroom on the first floor. Being sold with no onward chain.

Situated in this desirable location just off New Church Road within walking distance of Hove and Portslade mainline stations. Hove lagoon and seafront are also within easy reach as are a variety of eateries, cafes and shopping facilities. Bus services run close by offering access into the City Centre.

The accommodation with approximate room measurements comprises:-

ENTRANCE HALL

Engineered wood floor, radiator downstairs storage.

LIVING ROOM 14'9 x 13'4

Open fireplace with mantle over and tiled hearth, UPVC double glazed bay window, radiator, coving.

DINING ROOM 11'2 x 10'0

UPVC double glazed window, radiator.

KITCHEN/BREAKFAST ROOM 16'7 x 9'10

Incorporating stainless steel 1½ bowl sink unit with drainer and mixer tap, adjacent laminate work surface with cupboards and drawers under, matching eye level wall cupboards, inset four ring ceramic hob with extractor over, eye level double oven, integrated fridge/freezer and dishwasher, cupboard housing gas fired boiler, UPVC double glazed window, radiator, double bi-fold door to garden, engineered wood floor.

FIRST FLOOR

LANDING

Hatch to loft with pull down ladder, Velux window, power and light.

BEDROOM 1 16'10 x 14'11

UPVC double glazed bay window, radiator, coving.

BEDROOM 2 11'2 x 10'0

UPVC double glazed window, radiator.

BEDROOM 3 13'7 x 9'11

UPVC double glazed window, radiator.

BATHROOM

White suite comprising panelled bath with mixer tap, separate shower over, glazed shower screen, wash hand basin with unit under, low level w.c., heated ladder style towel rail, tiled floor, part tiled walls, UPVC double glazed frost window.

GARDEN

Enclosed paved rear garden.

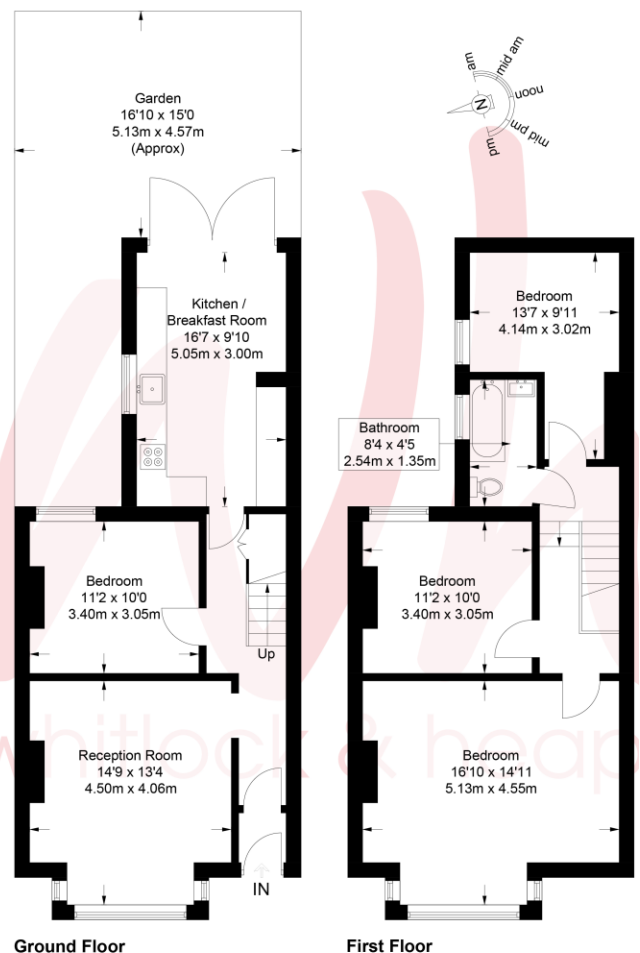

Approximate Gross Internal Area = 1160 sq ft / 107.8 sq m

Illustration for identification purposes only, measurements are approximate, not to scale. © Whitlock and Heaps 2020

Portslade Branch

48 Boundary Road, Portslade BN3 4EF
 portslade@whitlockandheaps.co.uk
 01273 422706

Hove Branch

65 Sackville Road, Hove BN3 3WE
 hove@whitlockandheaps.co.uk
 01273 778577



Disclaimer: Whitlock & Heaps have produced these particulars in good faith and they are set out as a general guide. Accuracy is not guaranteed, nor do they form part of any contract. If there is any particular aspect of these details which you require any confirmation, please do contact us, especially if contemplating a long journey. All measurements are approximate. Fixtures and fittings, other than those mentioned above, to be agreed with the seller. Any services, systems or appliances at the property have not been tested.