

11 Morpeth Terrace, North Shields



Guide price £55,000 to £60,000

*** Guide £55 000 - £60 000 *** For sale with NO ONWARD CHAIN, this two bedroom LOWER FLAT, offers refurbished accommodation and will make a great 1st buy. The bathroom and kitchen have been refitted and the flat has been re-decorated and newly carpeted throughout. There is a private yard to the rear.

Morpeth Terrace is a short walk away from a Percy Main METRO , and there is a regular bus service to Newcastle City and The Coast. North Shields town centre offers all necessary amenities and there are schools local too.

The flat has a 999 year lease from 2007 with a "peppercorn" ground rent. Council tax band A, Energy Rating C, Call next2buy Ltd to arrange a viewing 0191 2953322.

The Property Comprises

Entrance

UPVc door into hallway - radiator, storage cupboard. Newly decorated and carpeted.

Living Room

14'5" x 12'0" (4.40 x 3.67) UPVc double glazed window and radiator. Newly decorated and carpeted.



Kitchen

8'11" x 7'9" (2.73 x 2.37) UPVc double glazed window and door to the rear yard. Newly fitted with a range of floor and wall units, counters and sink, electric hob, extractor hood and oven.



Bathroom

4'4" x 9'1" (1.32 x 2.76) UPVc double glazed window, radiator, tiled walls and floor and refitted with a white suite and a shower over the bath.



Bedroom 1

13'6" x 12'6" (4.11 x 3.82) UPVc double glazed bow window and radiator. Newly decorated and carpeted.



Bedroom 2

11'3" x 6'9" (3.43 x 2.07) UPVc double glazed window and radiator. Newly decorated and carpeted.



Externally

There is a private yard to the rear.



FLOOR PLANS

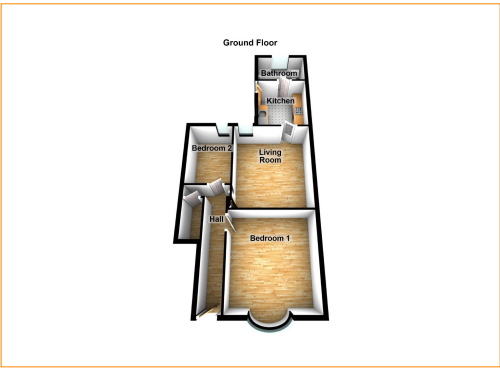

These plans are intended as a guide only, they are NOT TO SCALE. They are provided to give an overall impression of room layout and should not be taken as being scaled drawings.

ENERGY EFFICIENCY AND ENVIRONMENTAL IMPACT

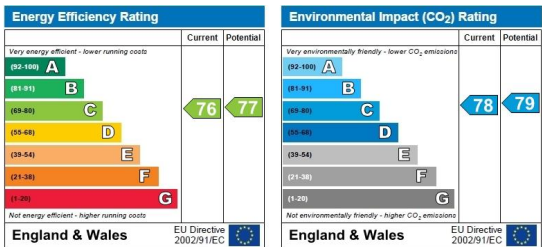

VIEWING ARRANGEMENTS

To arrange a viewing, please call 0191 2953322 or e-mail us; info@next2buy.com

Open Hours;

Monday 9am - 6pm

Tuesday 9am - 6pm

Wednesday 9am - 6pm

Thursday 9am - 6pm

Friday 9am - 6pm

Saturday 9am - 4pm

N/B The mention of any appliances and/or services within these particulars does not imply that they are in full and efficient working order.

VIEWING APPOINTMENT

TIME

DAY/DATE

VENDORS NAME (S)

QR CODE

You may download, store and use the material for your own personal use and research. You may not republish, retransmit, redistribute or otherwise make the material available to any party or make the same available on any website, online service or bulletin board of your own or of any other party or make the same available in hard copy or in any other media without the website owner's express prior written consent. The website owner's copyright must remain on all reproductions of material taken from this website.

www.next2buy.com

136/138 station road
wallsend, NE28 8QT

tel: 0191 295 3322