



3 The Arc, St Andrews Ridge, Swindon, SN25 4EJ

- AVAILABLE NOW
- Detached House
- Four Bedrooms
- 19ft Kitchen/Diner
- 19ft Living Room
- En-Suite To Master
- Garage & Driveway Parking
- High Quality Fixture & Fittings
- NO PETS
- Excellent Location

£1,400 PCM



*** AVAILABLE NOW *** Primary Homes & Lettings are delighted to offer this stunning four bedroom detached property offered unfurnished. The accommodation briefly comprises of entrance hallway, cloakroom, living room, kitchen/diner, master bedroom (with en-suite shower), three further bedrooms and bathroom. Property also benefits from driveway parking, garage, low maintenance rear garden, gas central heating and uPVC double glazing. Located in the popular area of St Andrews Ridge within easy access to the local shops, schools and transport links such as the A419. Must be viewed.



PRIMARY HOMES & LETTINGS

Tel: 01793 641 641

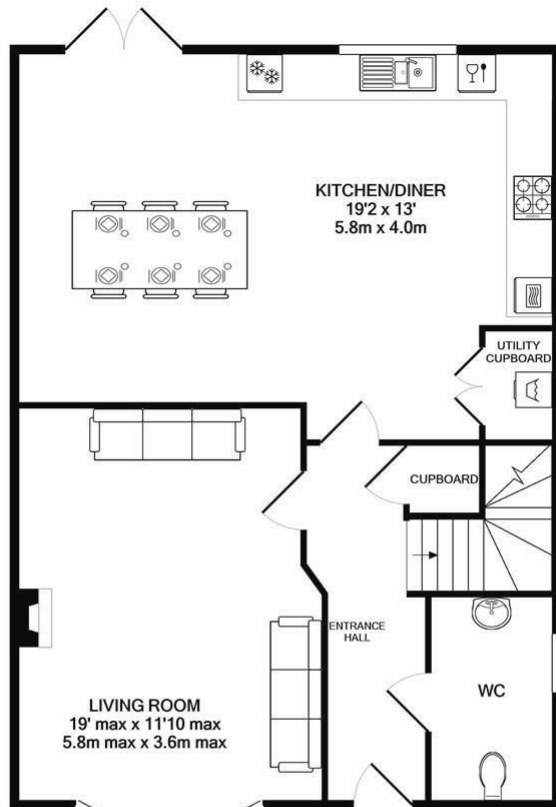

GROUND FLOOR

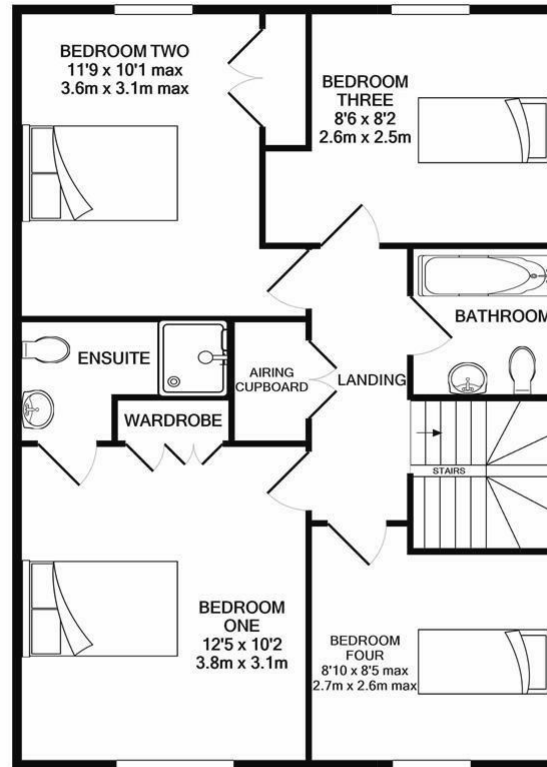

1ST FLOOR

FOR ILLUSTRATION ONLY
TOTAL APPROX. FLOOR AREA 1163 SQ.FT. (108.0 SQ.M.)

Whilst every attempt has been made to ensure the accuracy of the floor plan contained here, measurements of doors, windows, rooms and any other items are approximate and no responsibility is taken for any error, omission, or mis-statement. This plan is for illustrative purposes only and should be used as such by any prospective purchaser. The services, systems and appliances shown have not been tested and no guarantee as to their operability or efficiency can be given
Made with Metropix ©2020

