

SIGNATURE

NORTH EAST

OFFICIALLY RATED THE NO.1 ESTATE AGENT IN THE NORTH EAST





 Northumberland Close, North Shields NE30 1BQ

Northumberland Close, North Shields NE30 1BQ

£250,000

Signature are thrilled to bring to the sales market three luxury new-build mews houses situated on Northumberland Close, North Shields on the prestigious Northumberland Square development.

This home comprises of a living room, a beautiful neutral tone fitted dining kitchen, two double bedrooms, a family bathroom, an ensuite and a W.C.

This particular property also benefits from downstairs storage, a rear garden and allocated parking.

North Shields offers a wide range of amenities including the regenerated North Shields Fish Quay housing a cosmopolitan mix of elite dining and brasseries, the attractively developed picturesque marina and Tynemouth Village, one of the most prestigious and desirable areas in the North East. North Shields is conveniently located close to the award-winning coastline, with good road/rail links putting it within easy reach of Newcastle City Centre and the Northumberland countryside. North Shields has been granted £2 million funding to revitalise the town, including restoring key heritage buildings and building high-quality housing.

EPC is an estimate only.



PLEASE NOTE THAT THE VENDOR HAS CERTIFIED THE PROPERTY INFORMATION AND IMAGES.

PROPERTY FLOORPLAN

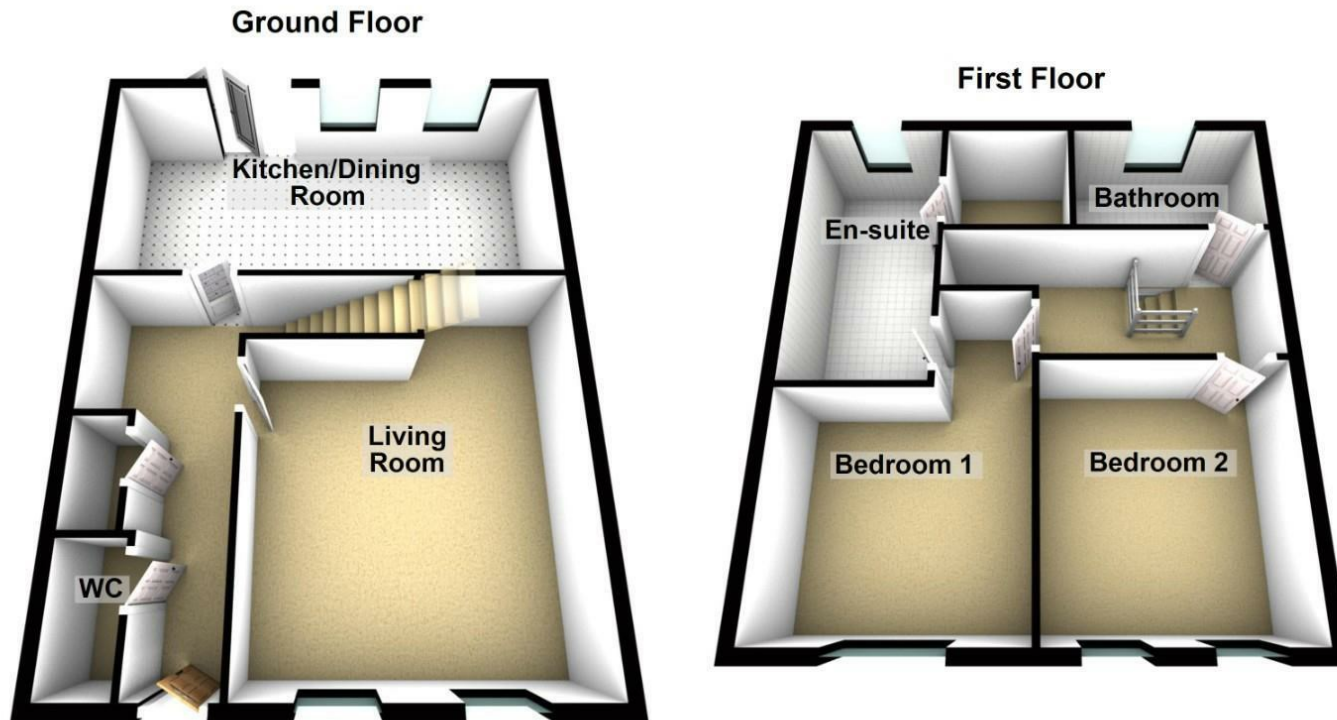

Please be advised the floorplans are not drawn to scale and are to be used to give an idea of the layout of the property.
Plan produced using PlanUp.

Measurements:

Living Room
18'4" x 14'5"

Kitchen / Dining Room
22'6" x 11'2"

Bedroom One
14'8" x 11'0"

Bedroom Two
11'1" x 11'0"

Bathroom
9'1" x 5'6"

En Suite
13'7" x 6'7"

Energy Efficiency Rating

	Current	Potential
Very energy efficient - lower running costs		
(92 plus) A		
(81-91) B		84
(69-80) C		
(55-68) D		
(39-54) E		
(21-38) F		
(1-20) G		
Not energy efficient - higher running costs		

England & Wales

EU Directive
2002/91/EC







More 5 Star Customer Reviews than any other Agent based in the North East on allAgents.co.uk



SALES

LETTINGS

FINANCE

LAW

WE COVER THE WHOLE OF THE NORTH EAST

Whitley Bay
0191 251 3344

Cramlington
01670 897 213

Tynemouth
0191 296 6689

Morpeth
01670 513 966

Ponteland
01661 820 082

Wallsend
0191 432 4151

Alnwick
01665 511 800

Heaton
0191 432 4275

Forest Hall
0191 266 9966

Other locations
0191 640 3523

Newcastle
0191 640 2284

Durham
0191 303 8252

Gosforth
0191 640 3523

Sunderland
0191 543 6390

Whickham
0191 432 5102

Gateshead
0191 432 4294

Jesmond
0191 281 1037

Killingworth
0191 640 3602

Ryton
0191 413 9845

Head Office &
Lettings
0191 253 4815

*Highest recommended 5-star reviews than any other Estate Agent based in the North East on allAgents.co.uk - The UK's Largest Customer Review Website for the Property Industry & Awarded Best Estate Agency 2018 & 2019 - North East England by SME News