



Marsham Court, Westminster
London SW1P

GARTONJONES.COM



Marsham Court, Westminster London, SW1P

GARTON JONES.COM

49 Marsham Street Sales +44 (0) 20 7340 0480
London westminster@gartonjones.com
SW1P 3DP www.gartonjones.com

£755,000 Share of Freehold

A well presented 2 bedroom apartment located on the 3rd floor of this very sought after Art Deco development in the heart of Westminster. The apartment is approx. 743 Square Feet and is sold with vacant possession with the accommodation comprising of a reception room, separate good size kitchen, two double bedrooms and bathroom. Residents will benefit from an onsite 24 hour concierge and lift to all floors. Marsham Street is extremely well placed for access to the transport links of Pimlico, St James' Park, Westminster and Victoria. Marsham Court is located close to the banks of the River Thames and is surrounded by an array of iconic London attractions as well as institutions like the Tate Gallery and Chelsea College of Arts. A plethora of hotels, eateries and retail shops which include The Goring, St Ermins', The Ivy Victoria, Timmy Green and Flight Club to name just a few

Service Charges: £7600 Per Annum (Including Heating and Hot Water)
Ground Rent: TBC
Long Leasehold: 963 Years Remaining

- 743 sq.ft (69sq.m)
- 3rd Floor (With Lift)
- 2 Bedroom Apartment
- Reception Room
- Separate Integrated Kitchen
- Modern Bathroom
- 24 Hour Concierge
- Sold With Vacant Possession
- Close to Local Amenities Including Shops, Restaurants & Transport Links
- Walking Distance to Pimlico, St James' Park, Westminster and Victoria Station



EPC certificate available on request.

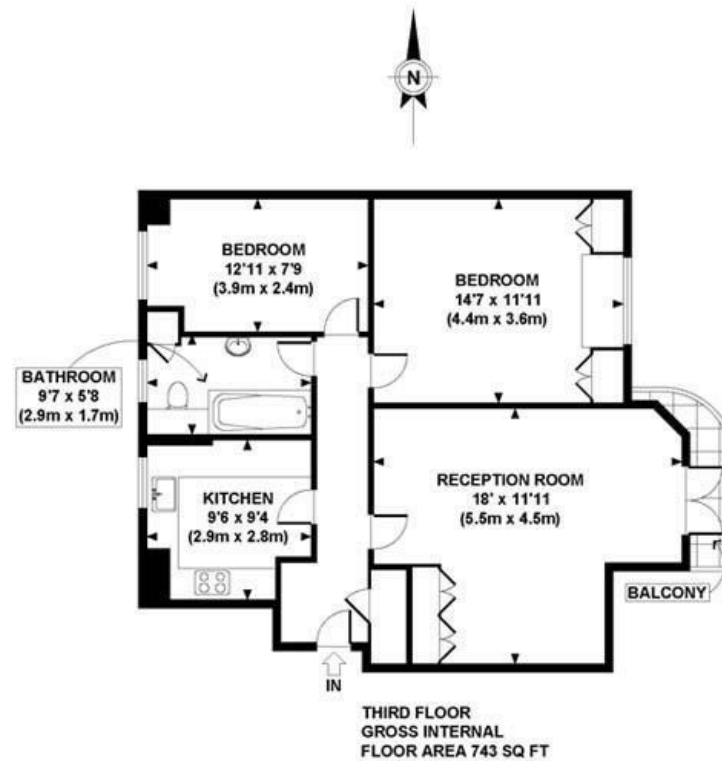

APPROX. GROSS INTERNAL FLOOR AREA 743 SQ FT / 69 SQ M
Ref: MJGJW - 020810 Copyright photoplan.co.uk
Floorplans are for identification and guideline purposes only, not to scale.
Compliant with RICS code of measuring practice.

