



SALES

LETTINGS

MANAGEMENT

chiswick@tatepartnership.co.uk

020 8996 0000

TATEPARTNERSHIP.CO.UK



Chiswick High Road, W4

£450,000

Newly decorated and ready to occupy, we offer for sale this First Floor, well proportioned apartment, located in the heart of Chiswick. Converted about 20yrs ago from an office building, these apartments benefit from larger than average rooms and higher ceilings. This one bedroom apartment has; Entrance Hall, Living Room, separate Kitchen, Double Bedroom, Bathroom. Double glazed windows. Gas central heating. There is a communal lift to all floors and a private car park with allocated parking. Step out onto Chiswick High Road, ultimately convenient for transport, shopping and dining.

Chiswick High Road, W4

Floor Plan

Approximate gross internal area
55 sq m / 589 sq ft

Chiswick High Road, W4

Approximate Gross Internal Area = 54.7 sq m / 589 sq ft

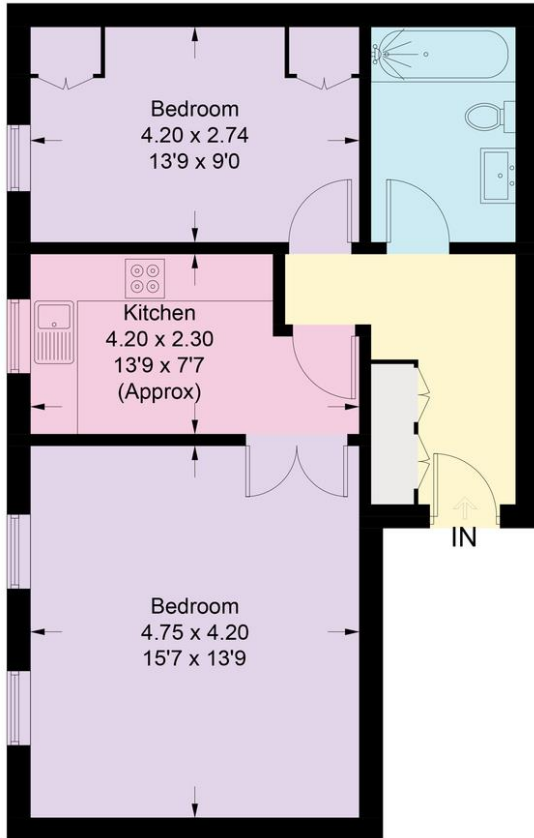

Illustration for identification purposes only, measurements are approximate, not to scale. floorplansUsketch.com © (ID714236)

EPC

