



CRAIGMOUNT, RADLETT

£1,300

CRAIGMOUNT

Radlett, Hertfordshire WD7 7LW

A bright and spacious first floor flat in the heart of the popular Radlett. This property benefits from a large open plan modern kitchen and dining area. Adjacent to the kitchen diner is a good sized spacious lounge, ideal for entertainment or a family area alike. Two large double bedrooms along with a family bathroom complete this apartment. Located on a quiet no through road in a popular development, the apartment is within walking distance of Radlett High Street and Station and various local amenities situated along the high street. Available immediately. Unfurnished. Parking available.



- 2 Double Bedrooms
- Large Kitchen Diner
- Good sized Lounge
- Bathroom
- First floor flat
- Unfurnished
- Available immediately

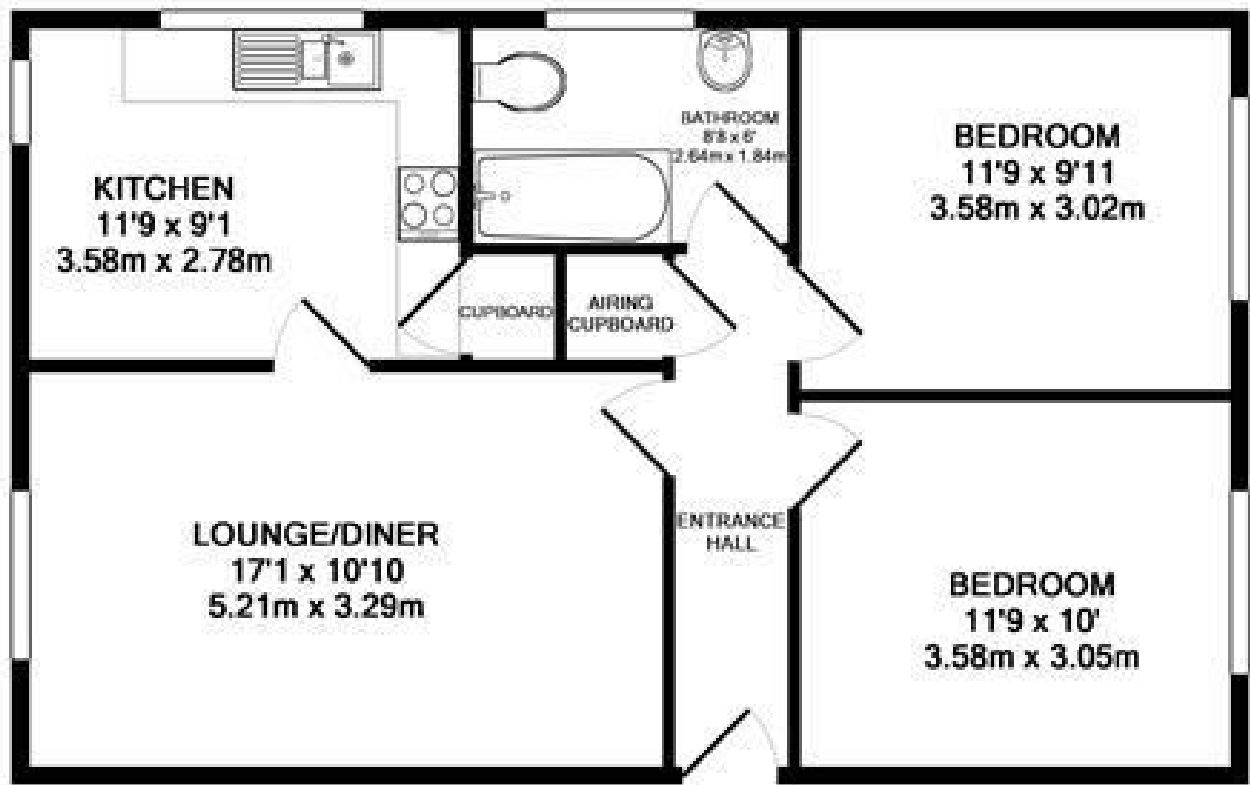

TOTAL APPROX. FLOOR AREA 640 SQ.FT. (59.5 SQ.M.)

Whilst every attempt has been made to ensure the accuracy of the floor plan contained here, measurements of doors, windows, rooms and any other items are approximate and no responsibility is taken for any error, omission, or mis-statement. This plan is for illustrative purposes only and should be used as such by any prospective purchaser. The services, systems and appliances shown have not been tested and no guarantee as to their operability or efficiency can be given.

Made with Metropix ©2018

Energy Efficiency Rating		Environmental Impact (CO ₂) Rating	
	Current	Potential	
Very energy efficient - lower running costs			
(92 plus) A			
(81-91) B			
(69-80) C			
(55-68) D			
(39-54) E			
(21-38) F			
(1-20) G			
Not energy efficient - higher running costs			
England & Wales	73	82	
	EU Directive 2002/91/EC		
Very environmentally friendly - lower CO ₂ emissions			
(92 plus) A			
(81-91) B			
(69-80) C			
(55-68) D			
(39-54) E			
(21-38) F			
(1-20) G			
Not environmentally friendly - higher CO ₂ emissions			
England & Wales	71	79	
	EU Directive 2002/91/EC		



