



6 The Avenue, Doncaster, DN5 0NR
Offers In Region Of £70,000 Freehold

MARTIN&CO

The Avenue, Bentley

2 Bedrooms, 1 Bathroom

Offers In Region Of £70,000

- Two Bedrooms mid terrace
- Perfect starter home
- Courtyard garden with out buildings
- Close to bus route
- Close to Bentley train station
- Close To Local Amenities
- Close to schools

Attention investors/ first time buyers: This 2 bedroom mid terrace house is a perfect starter home, situated close to local amenities and a short walk away to Bentley Train Station making it ideal for any commuter.

The property briefly comprises a spacious lounge with large front facing window and under stair cupboard, A further pantry area at the rear of the property , kitchen on the

%epcGraph_c_1_363%



ground floor, A master bedroom, second double bedroom and bathroom.

three piece suit and over bath shower

There is a courtyard garden with further out buildings for plenty of storage.

View now so not to miss out.

LOUNGE 12' 6" x 14' 11" (3.83m x 4.55m) A spacious lounge with front facing window, under stair cupboard and easy access to the kitchen.

KITCHEN 8' 11" x 8' 0" (2.73m x 2.46m) With a range of white wall and base units with grey work tops

BEDROOM ONE 12' 7" x 11' 9" (3.84m x 3.60m)
Master bedroom front facing with cupboard

BEDROOM TWO 7' 11" x 11' 4" (2.42m x 3.46m)
Second bedroom to the rear of the property.

BATHROOM 7' 4" x 8' 1" (2.25m x 2.48m) With white







GROUND FLOOR
363 sq.ft. (33.7 sq.m.) approx.

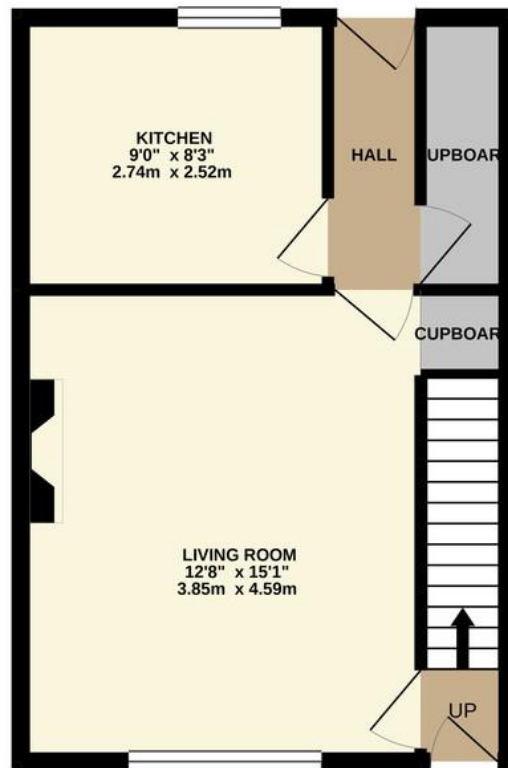

1ST FLOOR
358 sq.ft. (33.3 sq.m.) approx.

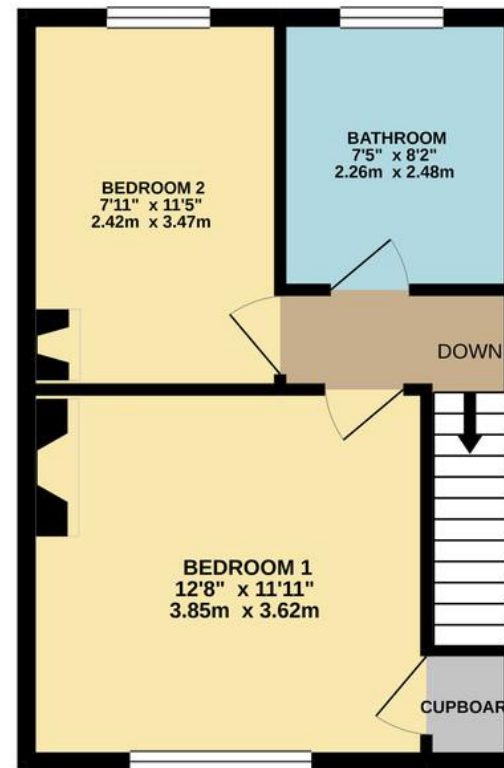

Martin & Co Doncaster

38 Hall Gate • Doncaster • DN1 3NR
T: 01302 343 494 • E: doncaster@martinco.com

01302 343 494

<http://www.martinco.com>



Accuracy: References to the Tenure of a Property are based on information supplied by the Seller. The Agent has not had sight of the title documents. A Buyer is advised to obtain verification from their Solicitor. Items shown in photographs including but not limited to carpets, fixtures and fittings are not included unless specifically mentioned within the sales particulars. They may however be available by separate negotiation. Buyers must check the availability of any property and make an appointment to view before embarking on any journey to see a property. No person in the employment of the agent has any authority to make any representation about the property, and accordingly any information given is entirely without responsibility on the part of the agents, sellers(s) or lessors(s). Any property particulars are not an offer or contract, nor form part of one. **Sonic / Laser Tape:** Measurements taken using a sonic / laser tape measure may be subject to a small margin of error. **All Measurements:** All Measurements are Approximate. **Services Not tested:** The Agent has not tested any apparatus, equipment, fixtures and fittings or services and so cannot verify that they are in working order or fit for the purpose. A Buyer is advised to obtain verification from their Solicitor or Surveyor. **Mortgage & Financial Advice:** The Martin & Co mortgage service is provided by London & Country Mortgages the UK's largest Independent Fee-Free mortgage broker of Beazer House, Lower Bristol Road, Bath, BA2 3BA. Authorised and regulated by the Financial Conduct Authority. Their FCA number is 143002. YOUR HOME IS AT RISK IF YOU DO NOT KEEP UP REPAYMENTS ON A MORTGAGE OR OTHER LOANS SECURED ON IT. Full written quotation available on request. A suitable life policy may be required. Loans subject to status. Minimum age 18. If you are making a cash offer, we shall require written confirmation of the source and availability of your funds in order that our client may make an informed decision

