



7 Alsop Close, Houghton Regis, Bedfordshire, LU5 5JT
£235,000



7 Alsop Close, Houghton Regis, Bedfordshire, LU5 5JT

***** EXCLUSIVE TO P&R PROPERTY SALES ** NO UPPER CHAIN ** GARAGE AND PARKING NEXT TO PROPERTY *** EXCELLENT LOCATION ** 3 BEDROOMS ** GARAGE ** WELL PRESENTED THROUGHOUT ** GREAT GARDENS ** MODERN KITCHEN **.** This lovely home benefits from accommodation comprising entrance hall, lounge, dining room, fitted kitchen, 3 bedrooms, bathroom, gas central heating, double glazed windows, front & rear gardens and garage.

GROUND FLOOR

ENTRANCE HALL

LOUNGE 11'7" X 14'11" (3.52M X 4.54M)

DINING ROOM 10'10" X 8'11" (3.31M X 2.71M)

KITCHEN/BREAKFAST ROOM 10'10" X 8'11" (3.31M X 2.71M)

1ST FLOOR

LANDING

BEDROOM 1 10'1" X 11'4" (3.08M X 3.46M)

BEDROOM 2 9'0" X 11'4" (2.75M X 3.46M)

BEDROOM 3 7'2" X 9'3" (2.18M X 2.81M)

BATHROOM

OUTSIDE

FRONT & REAR GARDENS

GARAGE IN BLOCK



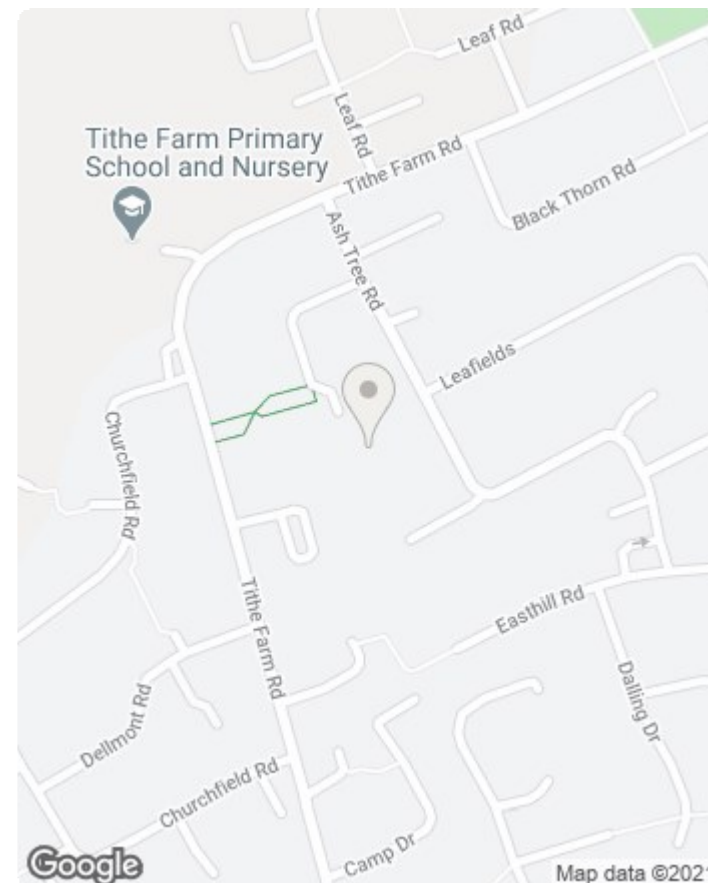
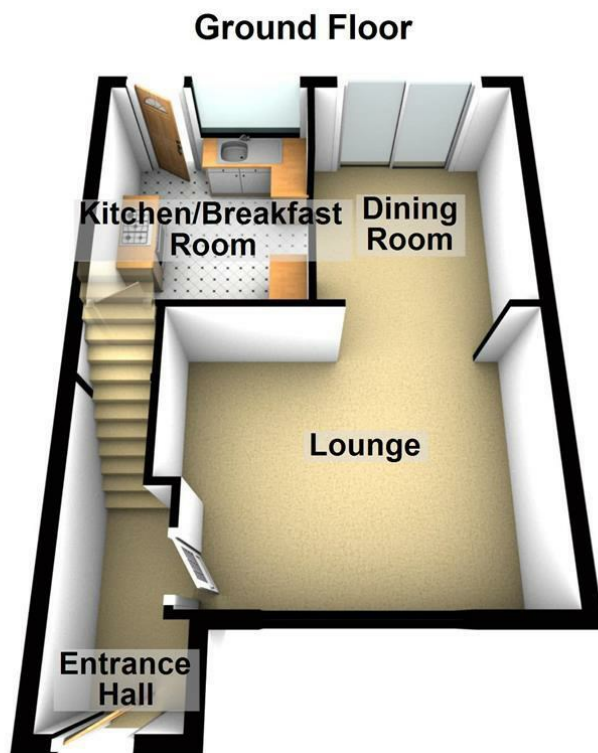

Energy Efficiency Rating		
	Current	Potential
Very energy efficient - lower running costs		
(92 plus) A		
(81-91) B		
(69-80) C		
(55-68) D		
(39-54) E		
(21-38) F		
(1-20) G		
Not energy efficient - higher running costs		
England & Wales		EU Directive 2002/91/EC

