



14 Mapperley Drive

Wakes Meadow, Northampton

oriordanbond



14 Mapperley Drive

Wakes Meadow

Northampton NN3 9UF

ASKING PRICE £239,995

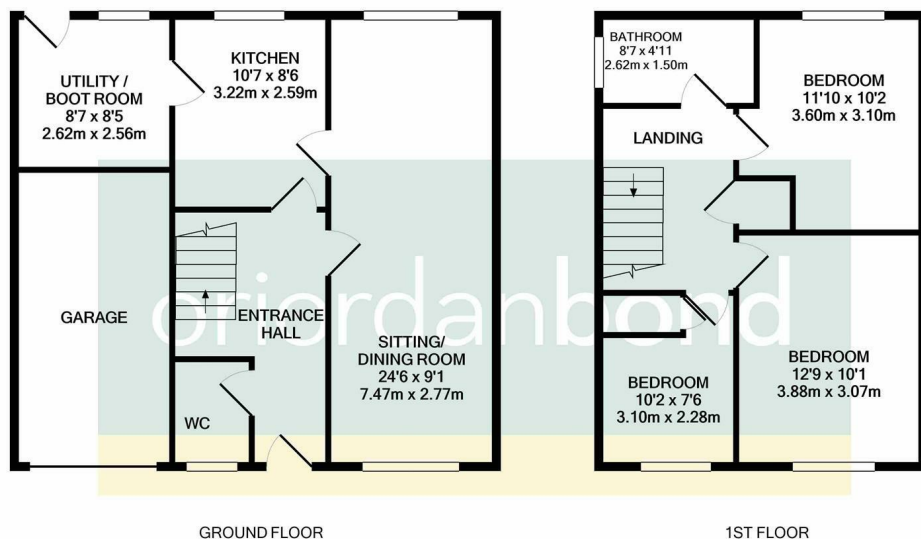

TOTAL APPROX. FLOOR AREA 1000 SQ.FT. (92.9 SQ.M.)

Whilst every attempt has been made to ensure the accuracy of the floor plan contained here, measurements of doors, windows, rooms and any other items are approximate and no responsibility is taken for any error, omission, or mis-statement. This plan is for illustrative purposes only and should be used as such by any prospective purchaser. The services, systems and appliances shown have not been tested and no guarantee as to their operability or efficiency can be given

Made with Metropix ©2020

Additional information

- Council Tax Band: C
- Energy Efficiency Rating: D

Viewing

Viewing strictly by appointment – details below

Disclaimer

O'Riordan Bond Estate Agents Limited has not tested apparatus, equipment, fittings or services and so cannot verify they are in working order. The buyer is advised to obtain verification from their solicitor or surveyor.

O'Riordan Bond Weston Favell

01604 784007

westonfavell@oriordanbond.co.uk