



Goldhawk Road, London, W6 0SA

£435,000

**WHITMAN & CO.**

SALES · LETTINGS · COMMERCIAL

- Secure and spacious one bedroom purpose built flat
- Juliet balcony
- Situated close to High Road and tube station
- Presented in excellent order
- Ideal first time or investment purchase
- Share in freehold

Tenure - Leasehold with share of freehold  
 Lease length - 996+ Years remaining  
 Ground Rent - Peppercorn  
 Service Charge - £960 pa  
 Local Authority - Hammersmith & Fulham  
 Council Tax - Band D (£1,124 pa)

## THE PROPERTY

A secure and spacious one bedroom purpose built flat presented in excellent order throughout and ideally located for all amenities.

17' reception room, fully integrated kitchen, 17' double bedroom, luxury white bathroom suite, Juliet balcony. Share in the freehold. Ideal opportunity for first time buyers and investors. Situated within close proximity of Stamford Brook tube station and the extensive facilities on Chiswick High Road.

## Goldhawk Road, W12

Approximate gross internal area

44.96 sq m / 484 sq ft



Key :  
 CH - Ceiling Height

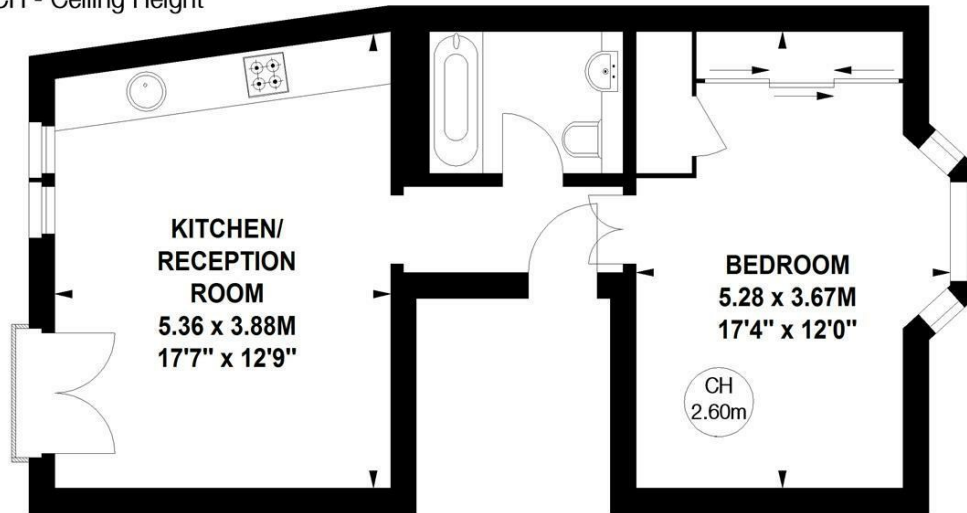

### First Floor

Not to scale, for guidance only and must not be relied upon as a statement of fact.  
 All measurements and areas are approximate only

## SITUATION



5-7 Turnham Green Terrace, Chiswick, London, W4 1RG

Tel 020 8747 8800

E-mail [sales@whitmanandco.com](mailto:sales@whitmanandco.com)

Website [www.whitmanandco.com](http://www.whitmanandco.com)