

Saxton Mee



Saxton Mee



Saxton Mee



Saxton Mee

Hunshelf Bank Stocksbridge Sheffield S36 2BS
£650,000



Hunshelf Bank

Sheffield S36 2BS

£650,000

A FABULOUS 4/5 BEDROOM STONE BUILT DETACHED FARMHOUSE WITH PLANNING PERMISSION TO EXTEND, INCLUDING AND A ONE BEDROOM COACH HOUSE AND STABLES. Farmhouse: entrance hall, two reception rooms, open plan dining kitchen, utility and WC. First floor: three double bedrooms. Second floor: part converted loft space. The Coach House has a beautiful fitted modern and contemporary kitchen, lounge, bedroom and WC with planning permission for a two storey dwelling to the side to create a further bedroom.

- FABULOUS OPPORTUNITY
- SUPERB PANORAMIC VIEWS
- APPROXIMATELY 18 ACRES
- 4/5 BEDROOM DETACHED FARMHOUSE
- COACH HOUSE
- STONE BARN WITH PLANNING PERMISSION.
- SURROUNDED BY GREENBELT FIELDS
- 4/5 BEDROOM DETACHED FARMHOUSE WITH PLANNING PERMISSION
- STABLES





A large barn provides useful storage space. Stables. The land is approximately 14.5 acres. Superb panoramic views towards Stocksbridge and Deepcar. Surrounded by greenbelt fields. Rare opportunity to acquire these properties set in this idyllic position.

PLANNING PERMISSION NUMBER 14/00628/FUL

OUTSIDE

A large barn provides useful storage space. Stables. The land is approximately 14.5 acres. Superb panoramic views towards Stocksbridge and Deepcar. Surrounded by greenbelt fields. Rare opportunity to acquire these properties set in this idyllic position. EPC Rating E.

PLANNING PERMISSION NUMBER 13/01206/FUL - FARMHOUSE

Whilst we endeavour to make our sales particulars fair, accurate and reliable, they are only a general guide to the property. If there is any point which is of particular importance to you, please contact the relevant office. The Agents have not tested any apparatus, equipment, fittings or services and so cannot verify they are in working order. The buyer is advised to obtain verification. All plans, floor plans and maps are for guidance purposes only and are not to scale. Please note all measurements are approximate and should not be relied upon as exact. Under no circumstances should they be relied upon as exact or for use in planning carpets and other such fixtures, fittings or furnishings. YOUR HOME IS AT RISK IF YOU DO NOT KEEP UP REPAYMENTS ON A MORTGAGE OR OTHER LOAN SECURED ON IT.

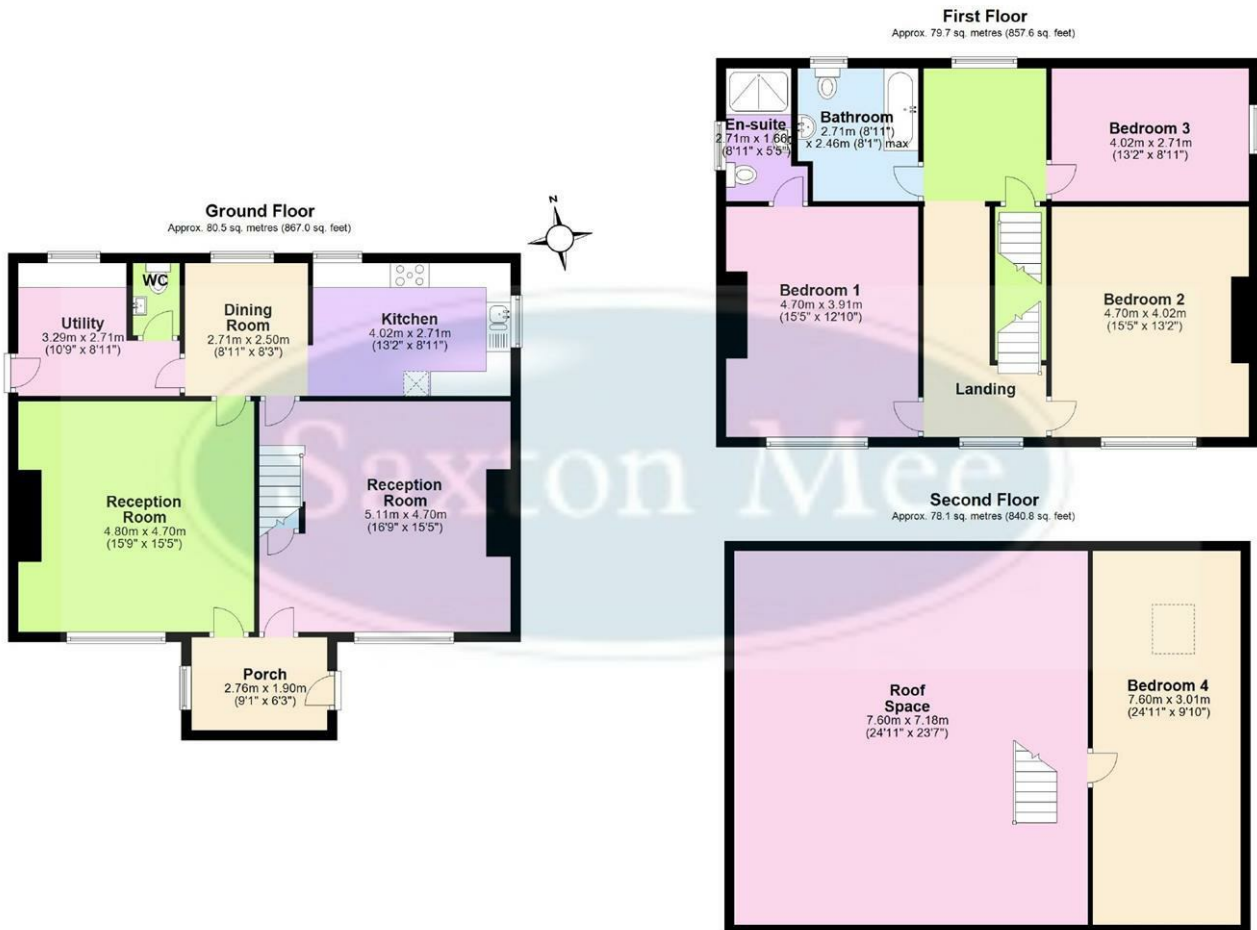

Total area: approx. 238.3 sq. metres (2565.4 sq. feet)

Floor plans are for guidance purposes only and under no circumstances should they be relied upon for use in planning carpets and other such fixtures fittings or furnishings. All measurements are approximate. Plan produced using PlanUp.

Crookes
Hillsborough
Stocksbridge

245 Crookes, Sheffield S10 1TF
82 Middlewood Road, Sheffield S6 4HA
462 Manchester Road, Sheffield S36 2DU

T: 0114 266 8365
T: 0114 231 6055
T: 0114 287 0112

www.saxtonmee.co.uk

