



Regal Close, Whitechapel E1 5JB

£2,900 Per Month\* Fees apply

**KURTIS**  
PROPERTY

- Beautifully Refurbished Four Double Bedroom House
- Modern Fitted Kitchen & Reception Room
- Contemporary Main Bathroom
- Close to Brick Lane, Shoreditch & Spitalfields Market
- Unfurnished/Part Furnished
- Split Over Three Floors
- Downstairs Toilet with Separate Shower Room
- Conveniently Located for Transport Links
- Gas Central Heating & Double Glazing
- Ideal For Sharers

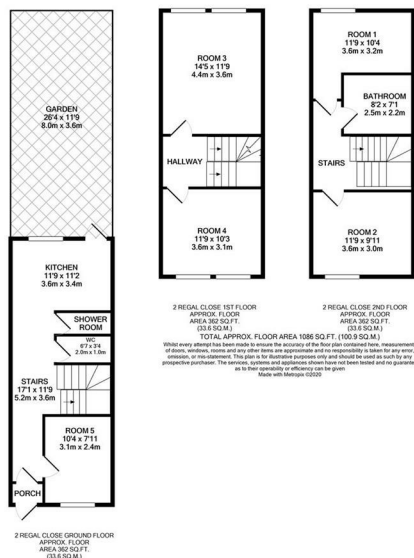

## THE PROPERTY

A beautifully fully refurbished FOUR DOUBLE BEDROOM, one reception room house split over three floors situated within a secure cul-de-sac. The property comprises a modern fitted kitchen, downstairs toilet with a separate shower room and a contemporary main bathroom. The property is in a prime location conveniently located for transport links to Whitechapel Station (0.2 Miles), Aldgate East Station (0.5 Miles), Bethnal Green Station (0.6 Miles) and close to a wide range of vibrant amenities such as the popular Brick Lane, Shoreditch and Spitalfields Market. This property is ideal for Sharers. Benefits include gas central heating, double glazing throughout & free parking. Offered either furnished/part furnished/unfurnished, available now.

## SITUATION

## Directions

600 Green Lane, Ilford, IG3 9SQ  
020 8598 2214  
info@kurtisilford.co.uk  
www.kurtisproperty.co.uk

**KURTIS**  
PROPERTY