

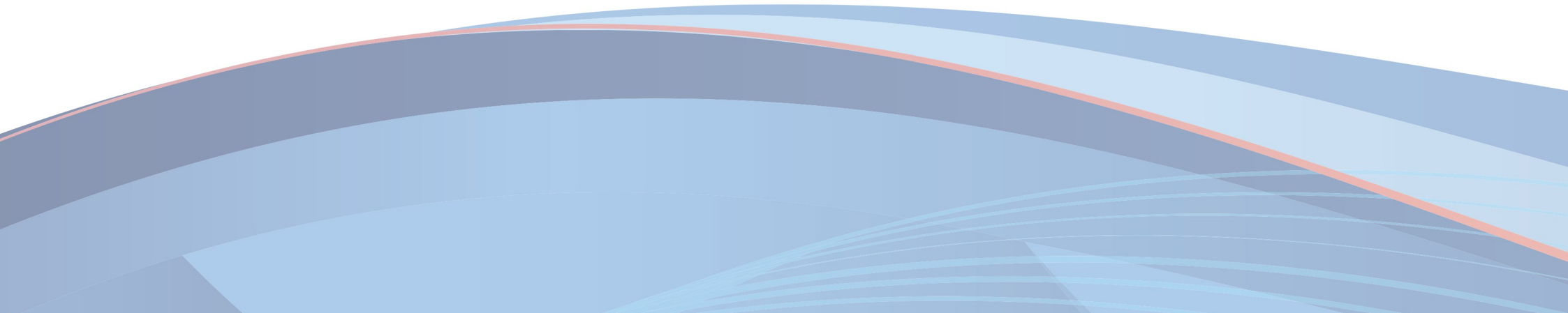

20 Stone Close, Salisbury, SP5 1TN

Guide Price £370,000







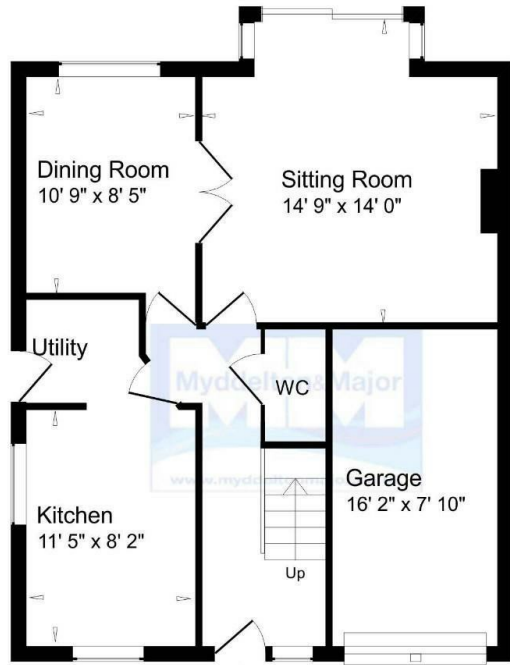

Ground Floor

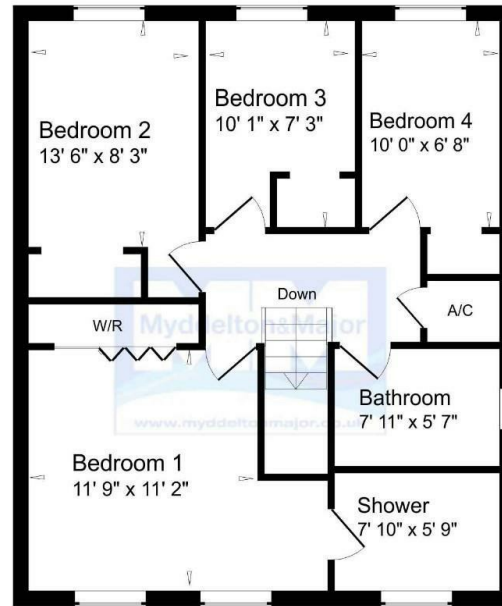

First Floor

Approximate Gross Internal Floor Area 1,175 Sq. Ft./ 109 Sq. M

Measurements quoted are to IPMS: Residential 2
For indicative purposes only. Copyright Jemesis Ltd 2018
Drawing Number : 164-0038

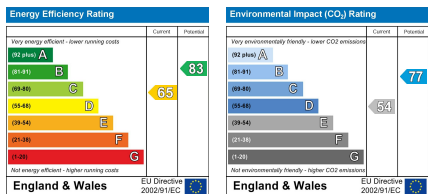

49 High Street Salisbury Wiltshire SP1 2PD

01722 337575

www.myddeltonmajor.co.uk

Myddelton & Major for themselves and for the vendors or lessors of this property whose agents they are give notice that: – i) the particulars are set out as a general outline only for the guidance of intended purchasers or lessees, and do not constitute part of an offer or contract.

ii) all descriptions, dimensions, reference to condition and necessary permissions for use and occupation, and other details are given without responsibility and any intending purchasers or tenants should not rely on them as statements or representations of fact, but must satisfy themselves by inspection or otherwise as to the correctness of each of them. iii) no person in the employment of Myddelton & Major has any authority to make or give any representation or warranty whatever in relation to this property.