



*jordanfishwick*

MANCHESTER  
37 Potato Wharf



**37 Potato Wharf, Manchester  
M3 4BD**  
£700 Per calendar month



### **The Property**

Please follow link to video walk-through... [https://youtu.be/ZOMuoEhQA\\_8](https://youtu.be/ZOMuoEhQA_8)

Available Now! This 4th floor one bedroom apartment has been finished to a high standard throughout and is located a short distance from Deansgate. Tiled floor in the entrance hall with storage cupboard. The living room is spacious with a modern kitchen and built in appliances including dish washer, washing machine and fridge/freezer with breakfast bar. The bedroom is a good size with free standing wardrobes and a stylish bathroom. Council Tax Band C. EPC rating C. Minimum 12 month tenancy.

### **Directions**

Potato Wharf is located in Castlefield, just a short walk from Deansgate and Spinningfields

- Available Now
- Fourth Floor Apartment
- One Bedroom
- Popular Development
- Short Walk To Deansgate
- Furnished
- No Parking
- Council Tax Band C

**Postcode** - M3 4BD

**EPC Rating** - C

**Floor Area** - sq ft

**Local Authority** - Manchester Council

**Council Tax** - Band C



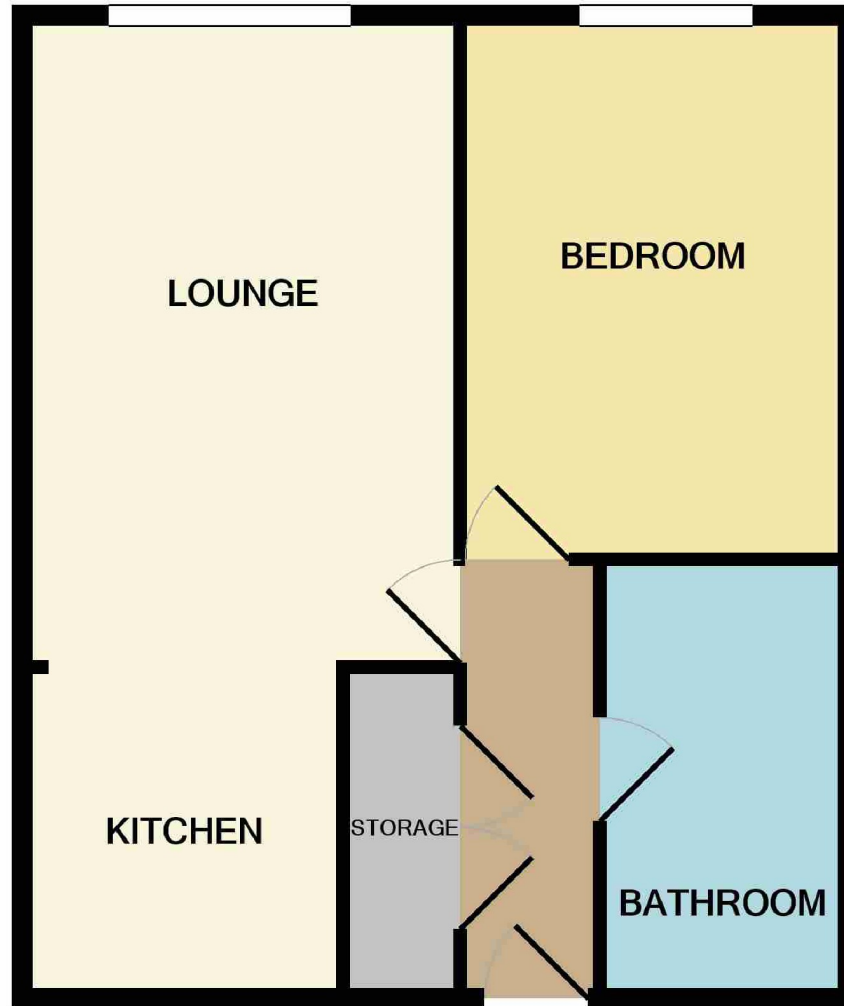

Measurements are approximate. Not to scale. Illustrative purposes only  
Made with Metropix ©2019