

moores
estateagents.com



Dovecote Cottage, Ketton

Stamford, PE9 3TA

Three Bedrooms, Barn Conversion With Detached Dovecot

Offers In Excess Of £575,000 | For Sale



Dovecote Cottage, Ketton

Stamford, PE9 3TA

Three Bedrooms, Barn Conversion With Detached Dovecot

Offers In Excess Of £575,000 | For Sale

Features

Attractive Barn Conversion

Character Features

Detached Dovecot With
Annex/Conversion Potential

Sought After Village Location

Three Spacious Bedrooms with
en-suites

Private Driveway & Off Road
Parking

A beautiful barn conversion situated in a tucked away location in the sought after village of Ketton. The property has flexible and spacious accommodation throughout and retains a wealth of character and original features including exposed stonework and vaulted ceilings, briefly comprising; a reception hallway, sitting room, conservatory, kitchen, a downstairs bedroom with en-suite, a cloakroom and utility room. To the first floor there are two large bedrooms both with ensuite and vaulted ceilings. The property also benefits from a detached dovecote in the grounds.

The property is entered via a spacious reception hallway via double doors, stone stairs give access to the first floor, a door provides access to the sitting room with double doors opening up to a private courtyard garden with a pond, pizza oven and pagoda and a further door leads to the inner hallway with a utility room, cloakroom and a ground floor bedroom with shower room and separate WC.

The sitting room is approximately 27' x 16' with exposed beams to ceiling, exposed stonework, double doors giving access to a rear courtyard garden, a picture window overlooking the rear garden and double doors giving access to the conservatory. Off the sitting room at the rear of the property is a farmhouse style kitchen fitted with a range of base and wall units in a shaker style, tiled flooring and a Range cooker. A stable door gives to the garden and double doors give access back to the conservatory.

The conservatory sits at the rear of the property and has flagstone flooring, panoramic views over the gardens and French doors leading onto the patio area.

On the first floor a spacious landing with vaulted ceilings and Velux windows gives access to a storage cupboard and two large double bedrooms both with en-suite facilities. The first floor features vaulted ceilings throughout and has a wealth of character including exposed beams to ceiling.

Internal inspection is highly recommended to appreciate all that this beautiful home has to offer!



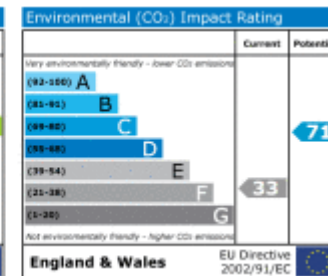
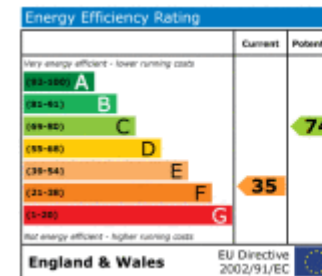
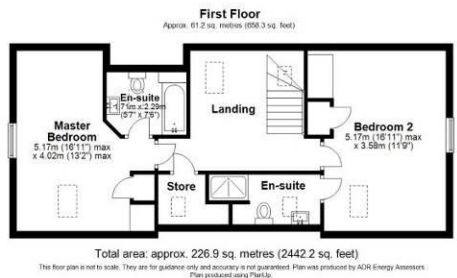

Re-locating buyers with **Douglas & Gordon** having 14 offices across London

Moore V Ltd trading as Moores Estate Agents gives notice that: 1. These particulars do not constitute an offer or contract or part thereof. 2. All descriptions, photographs and plans are for guidance only and should not be relied upon as statements or representations of fact. All measurements are approximate and not necessarily to scale. Any prospective purchaser must satisfy themselves of the correctness of the information within the particulars by inspection or otherwise. 3. Moore V Ltd trading as Moores Estate Agents does not have any authority to give any representations or warranties whatsoever in relation to this property (including but not limited to planning/building regulations), nor can it enter into any contract on behalf of the Vendor. 4. Moore V Ltd trading as Moores Estate Agents does not accept responsibility for any expenses incurred by prospective purchasers in inspecting properties which have been sold, let or withdrawn. 5. If there is anything of particular importance to you, please contact this office and we will try to have the information checked for you.

25 Burton Street, Melton Mowbray 01664 491610	36 High Street, Oakham 01572 757979	2 Orange Street, Uppingham 01572 821935	1 Sheep Market, Stamford 01780 484555	London Platform, Peterborough Station 01733 788888	London Platform, Grantham Station 01476 855618
---	---	---	---	--	--

Follow us on... Facebook Twitter