





### **HALL**

The front door leads into this impressive hallway which has access to the WC and kitchen and stairs to the first floor.

### **WC**

Fitted with a white WC and white wash hand basin, there is a UPVC window to the side.

### **KITCHEN/ DINER**

12' 9" x 15' 7" (3.9m x 4.76m) A generous room located at the rear of the ground floor fitted with a range of wall and floor mounted units in an ivory shaker style with contrasting black work surfaces. There is a brand new single electric oven and a five burner gas hob above. A modern black extractor fan with neon blue lighting highlights the recently fitting modern tiling to the splashback. Fully integrated is a fridge freezer and a dryer with space for a washing machine. The sink is beneath the window which overlooks the rear garden accessed by the double UPVC doors. To the other side of the side is a generous space for a dining table and chairs.



### **FIRST FLOOR LANDING**

Providing access to the Lounge, WC, Bedroom two and Bedroom three. A staircase then leads up to the second floor.

### **LOUNGE**

15' 2" x 15' 8" (4.63m x 4.79m) Situated at first floor level the generous lounge is located at the rear of the house with a large UPVC window with radiator beneath.

## **WC**

Recently painted in a modern grey colour there is a white WC and white wash hand basin with radiator to the wall.

## **BEDROOM 2**

11' 7" x 8' 7" (3.54m x 2.63m) Fitted with a good sized built in wardrobe this room has a front facing UPVC window and radiator to the wall.

## **BEDROOM 4**

7' 10" x 6' 8" (2.4m x 2.05m) With a UPVC window to the front and a radiator beneath.

## **SECOND FLOOR LANDING**

This landing provides access to two bedrooms and the bathroom as well as the loft. There is a storage cupboard and a UPVC window to the side.

## **BEDROOM 1**

15' 5" x 8' 10" min (4.7m x 2.7m min) This bedroom is on the second floor and has velux windows, space for wardrobes, radiator to the wall and access to the En-Suite.

## **ENSUITE**

Fitted with a shower cubicle with mains fed shower, white wash hand basin and white WC. There is a velux window with a radiator below.

## **BEDROOM 3**

10' 9" x 8' 10" (3.28m x 2.7m) The dormer window lights up the room with a radiator beneath.



## **BATHROOM**

7' 1" x 6' 5" (2.18m x 1.97m) Located at the front of the house on the second floor it is fitted with a large white bath, white WC and white wash hand basin.







### **GA RA GE**

The integral garage is boarded to the walls and has an up and over door with light and power.

### **EXTERNAL**

The front of the property has a driveway and the enclosed rear garden is mainly laid with Indian stone providing a low maintenance with a raised patio seating area, fenced to all sides with a gate. There is an outside tap, double electric point and an outside light.

GUIDE PRICE £200,000 - £210,000



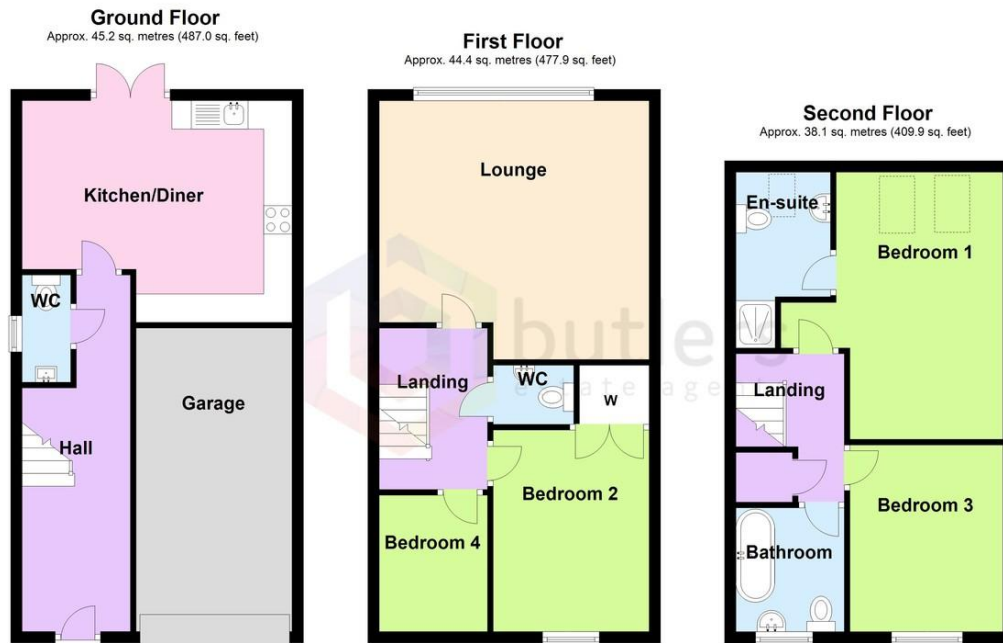

Total area: approx. 127.7 sq. metres (1374.8 sq. feet)

Whilst every attempt has been made to ensure the accuracy of this floorplan, all measurements and items on the plan should not be relied upon and no responsibility will be taken for any errors or omissions. The floorplan is owned by Butlers Estate Agents Ltd and should not be copied or reproduced without relevant authority.  
Plan produced using PlanUp.

