

OPENING DOORS SINCE 1843

Loveitts^{est. 1843}
THE ESTATE AGENTS

62 Brewer Road
Bulkington, CV12 9RF

£199,950



62 Brewer Road

Bulkington, CV12 9RF

This well presented and spacious semi detached property is situated in the much sought after village of Bulkington and in brief comprises open canopy porch, entrance hall with staircase to the first floor, lounge, spacious dining kitchen with a range of eye and base level beechwood style units, first floor landing, three bedrooms with built in cupboards and a family bathroom having a modern white coloured suite and electric shower unit. The property also benefits from gas fired central heating and PVCu double glazing. Outside the front garden is laid to lawn with a pebble stone driveway providing off road parking for vehicles. To the side of the property there are outbuildings including a store, outhouse W.C and workshop. The rear garden is enclosed being laid mainly to lawn with shrub borders and a paved patio. Internal viewing is highly recommended and the property is also being offered for sale with no upward chain.





This well presented and spacious semi detached property is situated in the much sought after village of Bulkington and in brief comprises open canopy porch, entrance hall with staircase to the first floor, lounge, spacious dining kitchen with a range of eye and base level beechwood style units, first floor landing, three bedrooms with built in cupboards and a family bathroom having a modern white coloured suite and electric shower unit. The property also benefits from gas fired central heating and PVCu double glazing. Outside the front garden is laid to lawn with a pebble stone driveway providing off road parking for vehicles. To the side of the property there are outbuildings including a store, outhouse W.C and workshop. The rear garden is enclosed being laid mainly to lawn with shrub borders and a paved patio. Internal viewing is highly recommended and the property is also being offered for sale with no upward chain.



- Spacious Semi Detached
- Lounge
- Dining Kitchen
- Three Bedrooms
- Modern Bathroom
- GFCH & PVCu D/Glazing
- Front & Rear Gardens
- Off Road Parking
- No Upward Chain

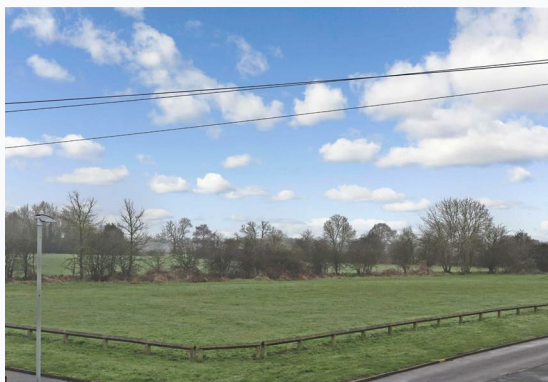

Floor Plan

Area Map



Ground Floor

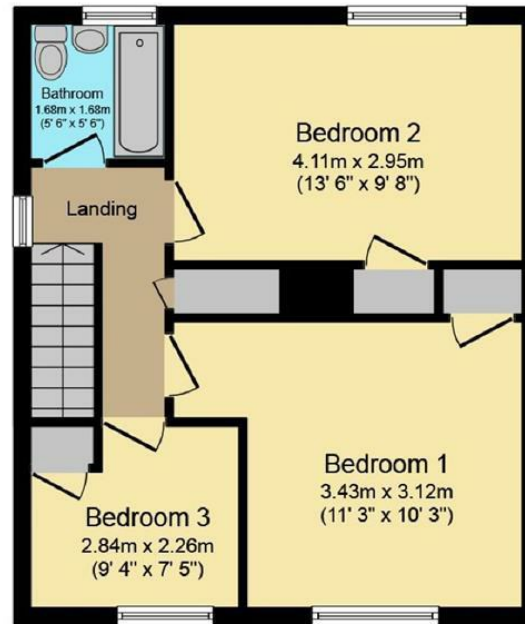

First Floor

Total floor area 99.0 sq. m. (1,066 sq. ft.) approx

This Floor Plan is for illustration purposes only and may not be representative of the property. The position and size of doors, windows and other features are approximate. Unauthorized reproduction prohibited. © PropertyBOX



Energy Efficiency Rating

	Current	Potential
Very energy efficient - lower running costs		
(92 plus) A		
(81-91) B		
(69-80) C		
(55-68) D		
(39-54) E		
(21-38) F		
(1-20) G		
Not energy efficient - higher running costs		
	51	75
England & Wales EU Directive 2002/91/EC		



Nuneaton
39 Church Street, Nuneaton CV11 4AD
024 7634 7676

Registered in England & Wales Company no. 7558151