



GEORGES
LTD

HAMPSHIRE HOUSE,
LONDON, W2
Asking Price £1,350,000 Leasehold

T. +44 (0) 20 7935 0011
E. enquire@napierwatt.co.uk
WWW.NAPIERWATT.CO.UK

NAPIER WATT

PROPERTY CONSULTANTS

Description

Napier Watt are pleased to offer this spacious (1,280 sqft / 118sqm) three bedroom, three bathroom lower ground floor apartment set within this prestigious purpose built block built in 1889 and set directly opposite and with direct views over Hyde Park and within easy reach of the Marble Arch and Oxford Street.

The building benefits from a grand communal entrance lobby with 24 hour portage, lifts.

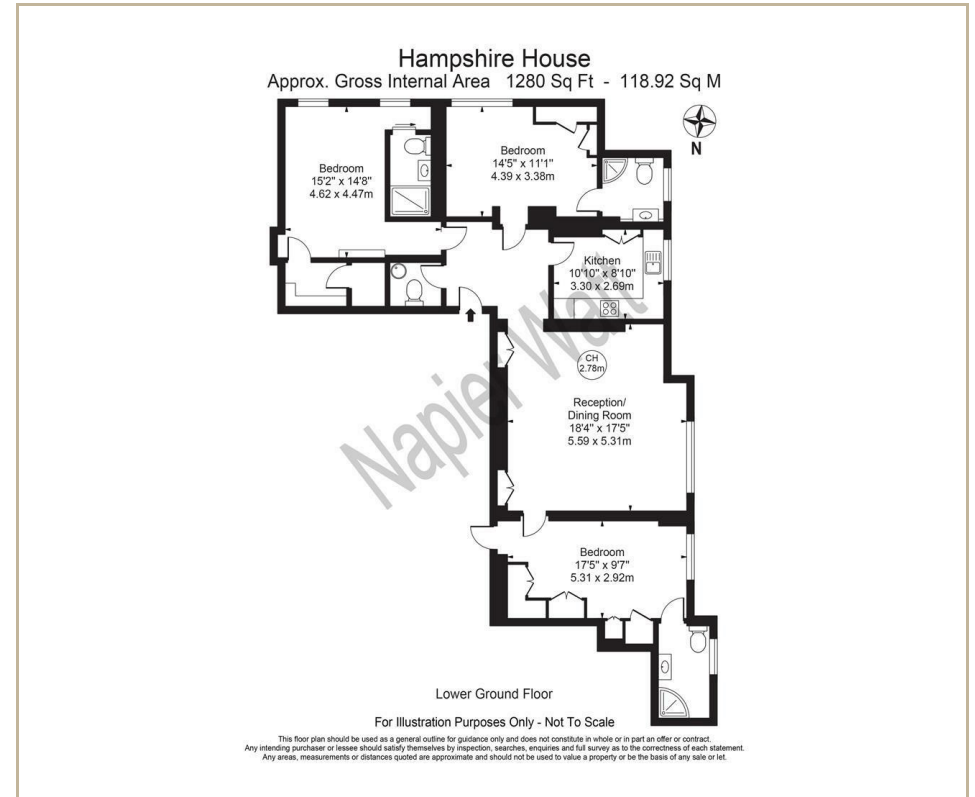

TERMS

Leasehold 171 years remaining

For Clarification we wish to inform prospective purchasers that we have prepared these sales particulars as a general guide. We have not carried out a survey, nor tested the services, appliances and specific fittings. Room sizes are approximate and rounded: they are taken between internal wall surfaces and therefore include cupboards/shelves, etc. Accordingly, they should not be relied upon for carpets and furnishings. Formal notice is given that all fixtures and fittings, carpeting, curtains/blinds and kitchen equipment, whether fitted or not, are deemed to be removable by the vendor unless specifically itemised within these sales particulars.

T. +44 (0) 20 7935 0011
E. enquire@napierwatt.co.uk
WWW.NAPIERWATT.CO.UK

NAPIER WATT
PROPERTY CONSULTANTS