



## Chamberlain Road | London | W13

£800,000

A four-bedroom, Victorian home that has been refurbished and extended to the highest of standards, spanning over three floors, ensuring a modern environment perfect for family living and entertaining.

In close proximity to Fielding School and situated just off Midhurst Rd, you are located on a quiet residential road in the heart of Northfields and close to its many attractions of independent traders, cafes and open spaces.

- Four bedrooms
- Victorian home
- Stunning condition
- High quality interiors
- Two bathrooms and separate WC



## Chamberlain Road

Approximate Gross Internal Area  
1281 sq ft - 119 sq m

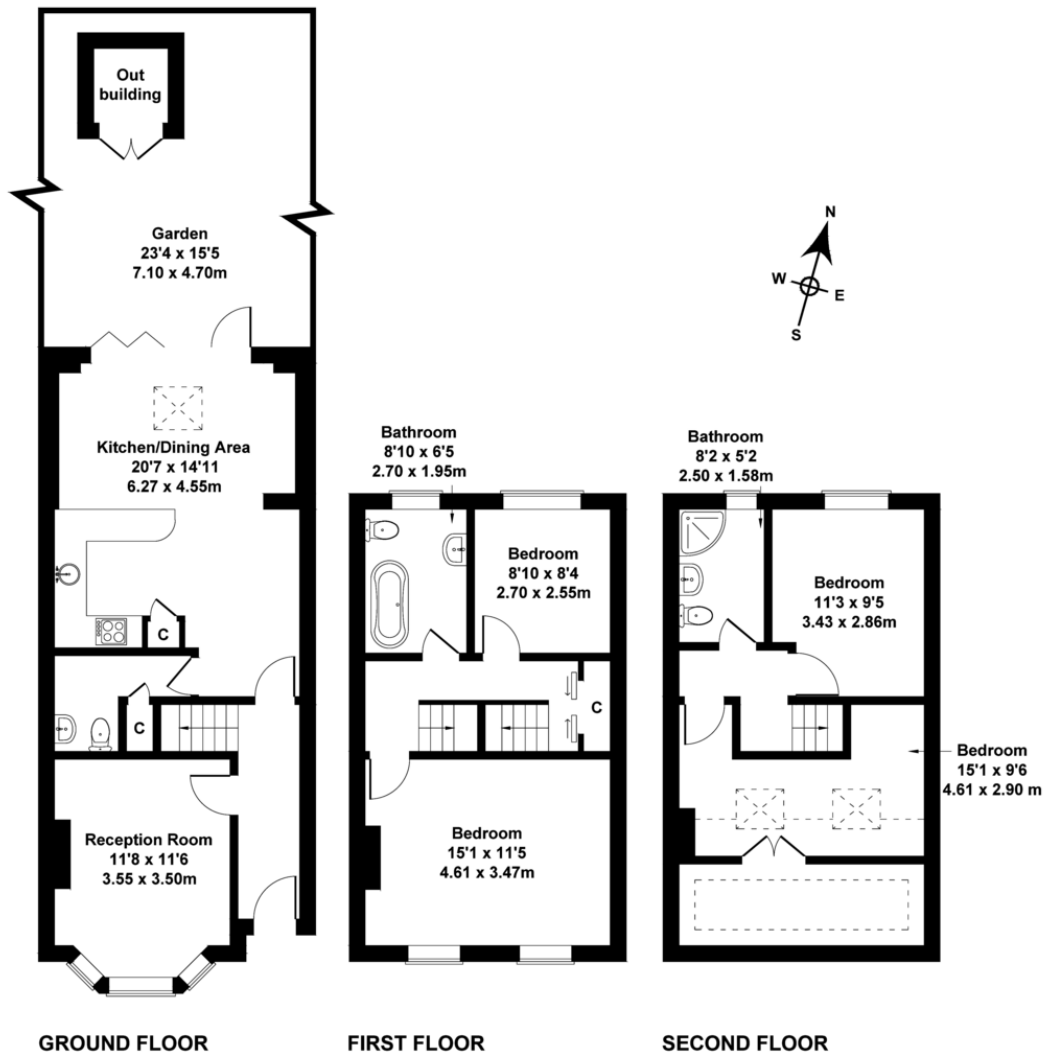

Not to Scale. Produced by The Plan Portal 2021  
For Illustrative Purposes Only.

## Contact Details

24 Station Parade  
Ealing  
London  
W5 3LD

[www.goviewlondon.co.uk](http://www.goviewlondon.co.uk)  
[sales@goviewlondon.co.uk](mailto:sales@goviewlondon.co.uk)  
020 8992 0333

Agents Note: Whilst every care has been taken to prepare these sales particulars, they are for guidance purposes only. All measurements are approximate are for general guidance purposes only and whilst every care has been taken to ensure their accuracy, they should not be relied upon and potential buyers are advised to recheck the measurements