



THOMAS HOUSE THORNFIELD ROAD,
BRENTRY, BS10 6FD

GOODMAN
& LILLEY



BUILT IN 2015 THIS SUPERB TWO DOUBLE BEDROOM APARTMENT WITH COMMUNAL GARDENS AND ALLOCATED PARKING IS LOCATED IN THE REPTON GRANGE DEVELOPMENT WHICH OFFERS A SELECTION OF HIGH SPECIFICATION HOUSES.

Location

Excellent situated centrally between the shops / amenities of both Westbury-on-Trym village and Cribbs Causeway shopping mall, and with excellent public transport routes to all parts of Bristol.

Accommodation

Communal Entrance

With entry phone system and stairs up to the apartment. On the top level there is an ample sized cupboard space shared with the opposite flat.

Entrance Hallway

Providing a spacious entrance to the apartment with a built in cupboards, karndean flooring, radiator and doors to all rooms.

Open Plan Living Area

Incorporating the kitchen and living space featuring karndean flooring, radiator and inset spot lighting throughout. There is a superb sitting area with ample space for sofas, a dining area with space for a table, and a wonderful kitchen area with modern fitted wall and base units, integrated appliances, ample work surfacing and a sink.

Master Bedroom

A generous master bedroom with its own separate central heating and space for wardrobes and dressing table, double glazed windows to rear aspect.

Second Bedroom

Double bedroom with double glazed window to the rear and a radiator.

Bathroom

Fitted with a modern white suite comprising paneled bath with bluetooth shower fitted over, wash basin and concealed cistern WC, tiled splashbacks and a centrally heated towel rail/radiator.

Outside

Communal Gardens

Lawn areas maintained by the management company.

Parking

There is an allocated parking space to the front of the building.

-
- ****NO ONWARD CHAIN****
 - Two Double Bedrooms
 - High EPC Rating
 - Allocated Parking
 - Good Condition
 - Bosch Kitchen Appliances
 - Communal Garden



£250,000



Floor Plan

Approx. 61.2 sq. metres (658.4 sq. feet)

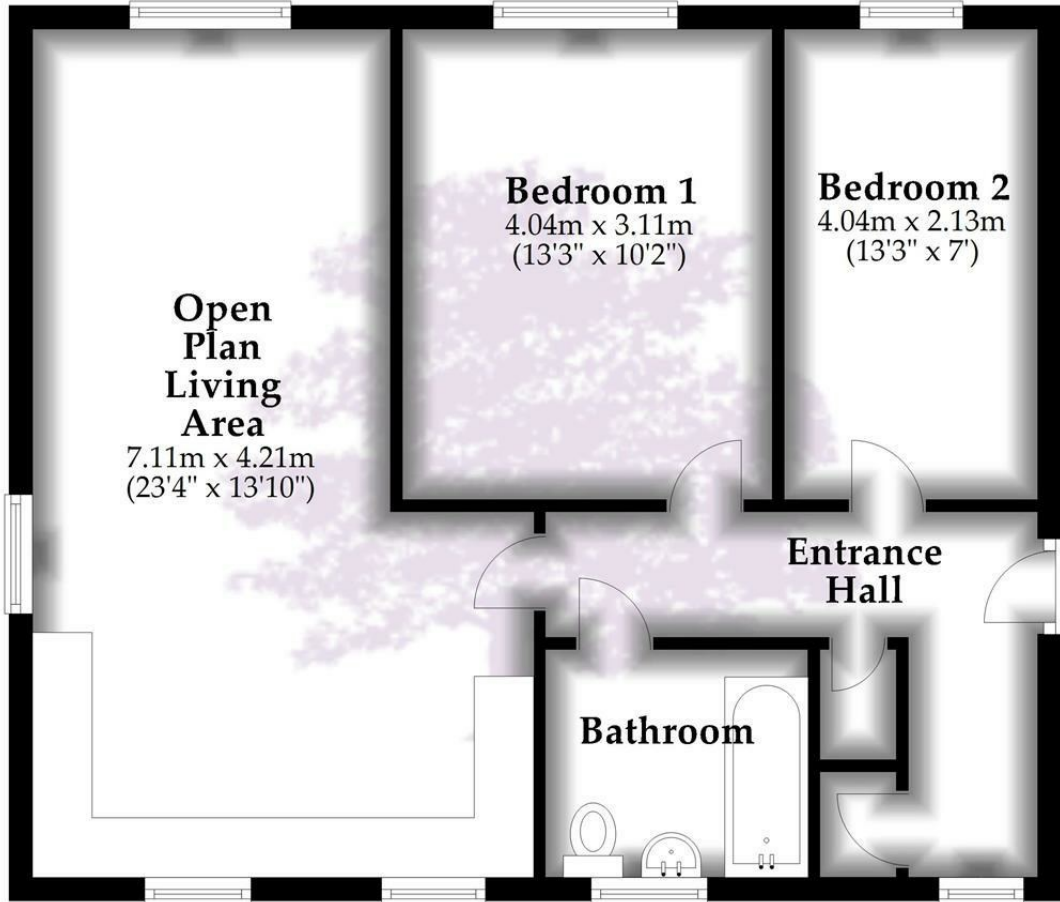

Total area: approx. 61.2 sq. metres (658.4 sq. feet)

HENLEAZE - 0117 2130777
henleaze@goodmanlilley.co.uk

PORTISHEAD - 01275 430440
sales@goodmanlilley.co.uk

SHIREHAMPTON - 0117 2130333
shire@goodmanlilley.co.uk

Zoopla.co.uk

rightmove



WWW.GOODMANLILLEY.CO.UK

These particulars are for general guidance only. They do not form or constitute any part of an offer or contract. Goodman & Lilley has not carried out structural surveys of the property. The services, appliances or specific fittings mentioned in these details have not been tested. Every attempt is made to ensure accuracy, however all photographs, measurements, floor plans and distances are for illustrative purposes only. They must not be relied upon when purchasing carpets and or other fixtures & fittings. Lease details, service charges and ground rents are given as a guide only. They should be checked and confirmed by a licensed solicitor prior to exchange of contracts. The copyright of all details, photographs and floor plans remain exclusive to Goodman & Lilley.