



jordanfishwick

CASTLEFIELD
St Georges Island



St Georges Island, Castlefield
M15 4GS
 Price £185,000



The Property

CASH BUYERS ONLY! Video tour - <https://www.youtube.com/watch?v=FPxv59vKs6E>
 Jordan Fishwick are pleased to offer for sale this beautifully presented LARGER AND LIGHTER THAN AVERAGE two bedroom apartment in the popular St Georges Island development. This corner apartment is located on the seventh floor of block 3 and offers views towards the west towards Salford Quays and views to the east over the canal. The apartment has been well maintained over the years and is ready to move straight in to. The apartment briefly comprises of: entrance hall, living room/kitchen with access to balcony, 2 double bedrooms and family bathroom. The apartment also benefits from concierge service.

Directions

St Georges Island is located just 15 minutes walk from Deansgate and offers easy access to Salford Quays and the ring road.

- CASH BUYERS ONLY
- Two Bedroom Apartment
- 7th Floor
- Full Length Balcony
- Well Presented Throughout
- Nice Views
- Castlefield Location
- EPC Rating D

Postcode - M15 4GS

EPC Rating -

Floor Area - sq ft

Local Authority - Manchester City Council

Council Tax - Band C



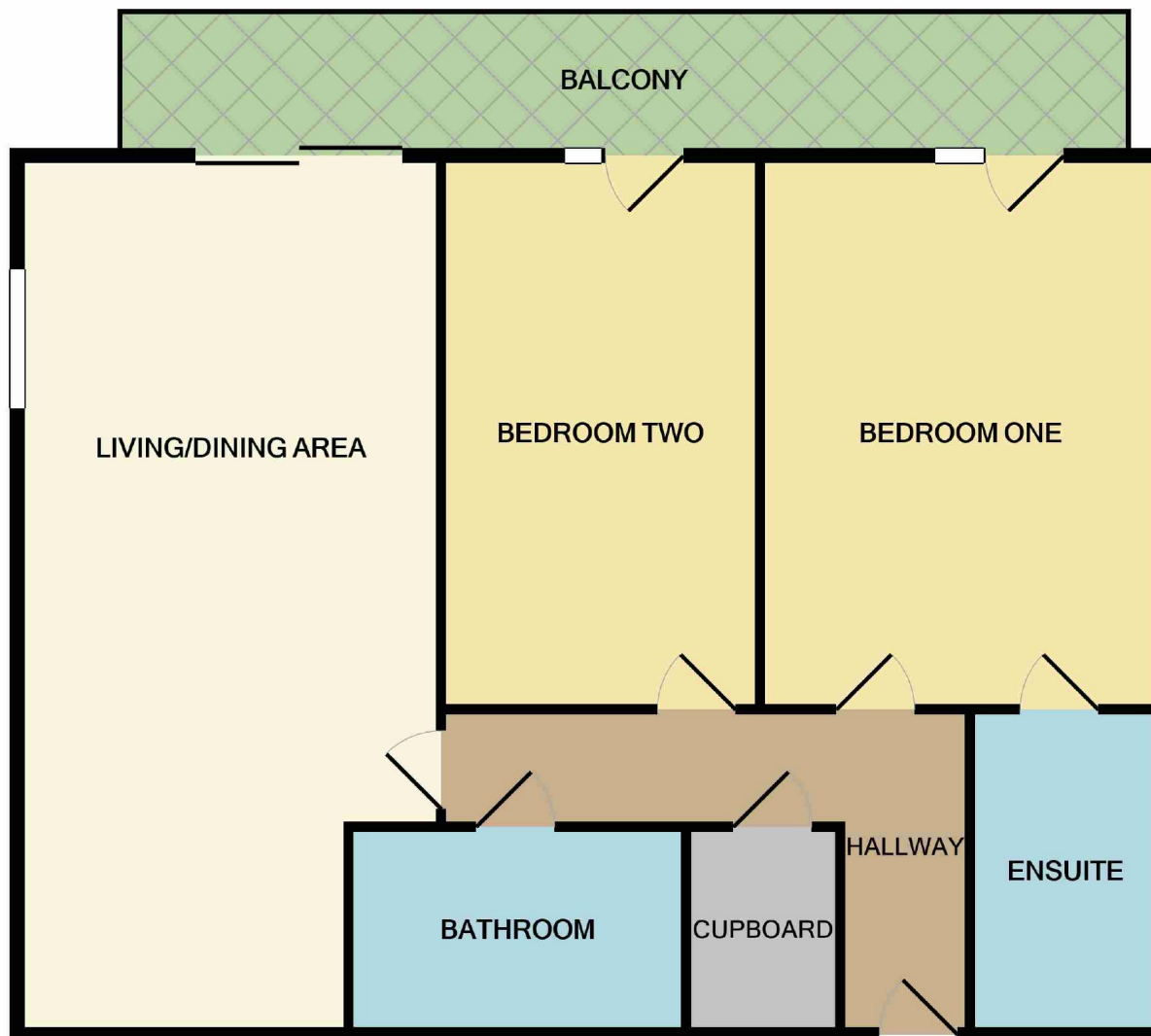

Measurements are approximate. Not to scale. Illustrative purposes only
Made with Metropix ©2021



These particulars are believed to be accurate but they are not guaranteed and do not form a contract. Neither Jordan Fishwick nor the vendor or lessor accept any responsibility in respect of these particulars, which are not intended to be statements or representations of fact and any intending purchaser or lessee must satisfy himself by inspection or otherwise as to the correctness of each of the statements contained in these particulars. Any floorplans on this brochure are for illustrative purposes only and are not necessarily to scale.

Offices also at:
Chorlton | Didsbury | Disley | Glossop | Hale | Macclesfield | Manchester | Sale | Wilmslow | Withington

68 The Arches, Whitworth Street West, Manchester, M1

0161 833 9499

manchester@jordanfishwick.co.uk
www.jordanfishwick.co.uk