



- Large 1 double bedroom ground floor apartment
- Close to Exeter & bus route nearby
- Off road parking for one vehicle
- Open plan kitchen/living area with separate utility room
- Communal gardens, with countryside views



£595 PCM

HELMORES
SINCE 1699

FLAT 14 TURLAKE HOUSE

Cowley EX5 5ER



The house is situated about 1.5 miles from Exeter's City Centre. It is located in the lovely hamlet of Cowley. The apartment comprises of a large open plan kitchen/living area, separate utility room (with plumbing for washing machine), large double bedroom and en-suite shower room.

Outside there is one designated parking space, communal gardens surrounding the property and an area for hanging out washing. Just across the road is Bernaville Garden Centre with its café and restaurant. There is also a lovely pub, serving locally produced food throughout the day. A bus stop is found a short walk from the property, with regular buses going to Crediton & Exeter.

Viewings available from the 18th January onwards so please contact us and we can arrange a viewing for you

TERMS : 6 months minimum

Unfurnished

No pets

No Smoking property

Rent : £595 PCM

Deposit : £595

Available : Early February

Council Tax : A

Heating : Electric

EPC : E

DIRECTIONS : From Exeter proceed towards Barnstaple on the A377 Crediton road. Over Cowley Bridges, and take the first sign right (signed Upton Pyne / Brampford Speke) and then immediately left into Turlake House drive.

I'm INTERESTED to look! What next?

We'll fix you a viewing appointment - phone, email or call into the office (we're open 7 days a week) with some dates and times that suit you.

I want to APPLY! What next?

You'll need to complete an application form which you can be given a paper copy of or we can send you a link to your email. We also need to check your ID so that we comply with the Right to Rent check, which is a legal requirement now for all tenancies – this can be found at <https://www.gov.uk/government/publications/right-to-rent-document-checks-a-user-guide>

HELP! I need more information on the whole renting process!

We're here to hold your hand through the entire process. So, get in touch with Helmores rental dept – the team are very friendly, helpful, knowledgeable and REALLY want to HELP you find your perfect home!

You can also check out our step by step RENTING GUIDE here: <https://www.helmores.com/rent/renting-guide>

COVID-19 SAFETY POLICY

We're taking safety extremely seriously, so before making a viewing appointment for this property please read our Stay Safe policy here: [helmores.com/staysafe](https://www.helmores.com/staysafe)

If you or any of your household have symptoms of Covid-19 or have been asked to self-isolate please stay at home.

Ground Floor

Approx. 42.2 sq. metres (454.7 sq. feet)

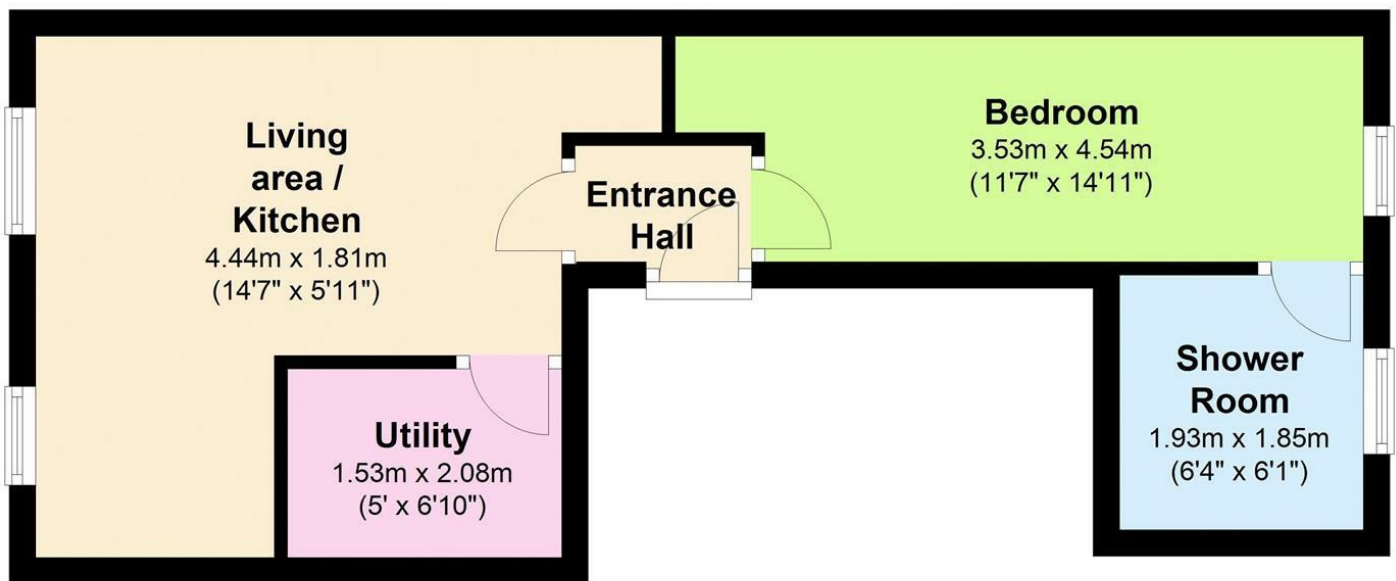

Total area: approx. 42.2 sq. metres (454.7 sq. feet)



111-112 High Street, Crediton
Devon, EX17 3LF
www.helmores.com



TO VIEW CALL 01363 777 999

property@helmores.com