

Apartment 11

Penn Road
Penn
Wolverhampton
WV4 4HP
Asking Price Of £130,000



Beautifully presented first floor apartment situated in a sought after location convenient for transport links and a variety of local shops. Offering spacious accommodation throughout the property comprises entrance hall, impressive living/dining room, re-fitted kitchen, two bedrooms, and bathroom. A garage is located in a nearby block to the rear. The property is to be sold with an extended lease term and has gas central heating and double-glazing.

ENTRANCE HALL

Radiator, tiled floor, useful store cupboard, loft access hatch.

LIVING/DINING ROOM 22' 0" x 14' 1" (6.71m x 4.3 maxm)

The attractive living room has a double glazed window to the front, two radiators and bi-fold doors giving access to the kitchen.

KITCHEN 8' 10" x 8' 7" (2.7m x 2.62m)

Double glazed window to the front, tiled floor and a range of contemporary fitted wall, drawer and base units with block work surface above incorporating a white composite sink with mixer tap. There is a built-in electric oven with ceramic hob above, integrated dishwasher and plumbing for a washing machine.

BEDROOM ONE 12' 4" x 10' 10" (3.78m x 3.31m)

Double glazed window to the rear and radiator.

BEDROOM TWO 8' 10" x 6' 6" (2.7m x 1.99m)

Double glazed window to the rear, radiator and built in wardrobe.

BATHROOM

Tiled floor, part tiled walls, towel rail, panelled bath with electric shower above, fitted vanity unit with shelving and inset sink and w.c.

GARAGE

Located in a nearby block to the rear.

TENURE Leasehold



Asking Price Of £130,000

Ground Floor

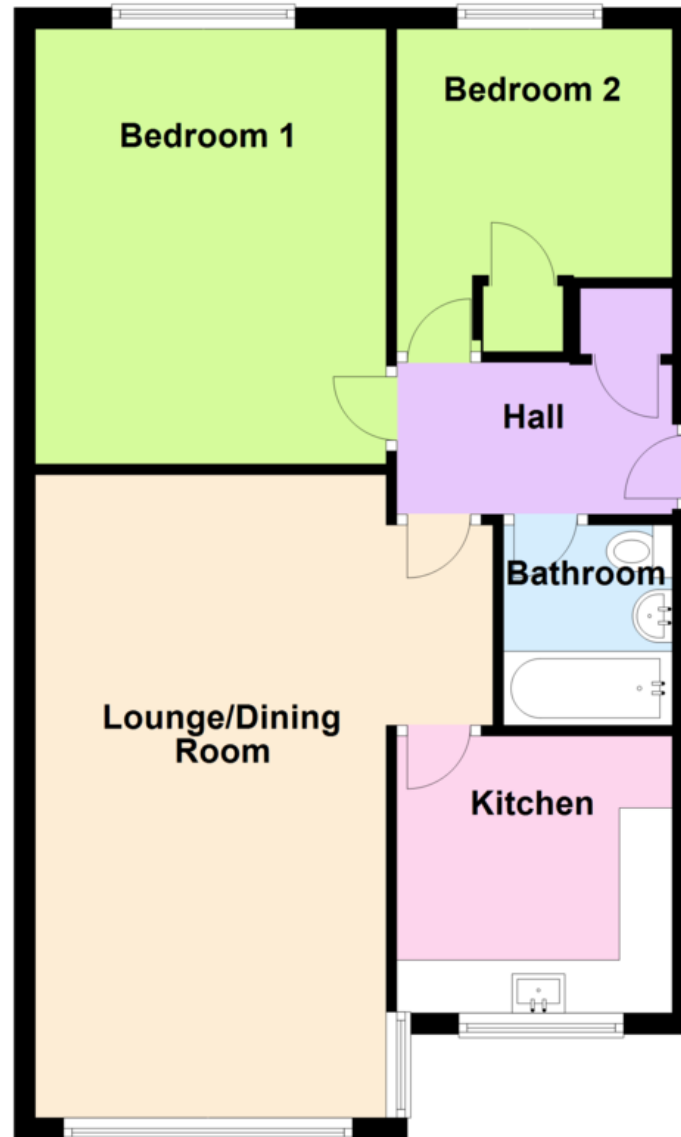

13 Waterloo Road, Wolverhampton WV1 4DJ Fax: 01902 712956 Email: info@swfestateagents.co.uk

Residential Sales • Valuers • Residential Lettings • Property Management

Tel: 01902 575555 www.swfestateagents.co.uk

rightmove 
find your happy

