

241 Deansgate, Manchester, Lancashire, M3 4EL

Tel: 0161 637 8336

Email: contactus@ascendproperties.com

www.ascendproperties.com

Ascend

Built on higher standards



Number One, Pink, Salford

£750 PCM

This one-of-a-kind 17th floor apartment is situated right in the heart of MediaCityUK - the new home of the BBC.

Step inside the spacious entrance hall and you'll see that this popular pad has bags of style, with a fresh contemporary design throughout. Just down the hall you'll find the open-plan lounge/kitchen/dining area where you'll have more than enough room to entertain guests and friends. You even have access to your own private balcony where you can get some cracking views and experience the breeze and buzz of the Quay. This apartment also benefits from two gorgeous double bedrooms and two bathrooms - each built to shiny, high standards.

Located just minutes away from the nightlife of the Quays, you really couldn't be better located for both work and play. The Metrolink station is literally right on your doorstep, so travelling into the city centre couldn't be easier. This one is set to be super-popular, so make sure you give us a call soon.

If you're interested in having a closer look, or have any questions, do get in touch. And just so you know, the pictures for this apartment are for marketing purposes only. The internal fixtures, fittings and furnishings may vary.

Available 17th May 2021



Living room and kitchen
14'0" x 11'1" (4.27 x 3.40)

A modern and bright living room and kitchen with wood flooring throughout. A fully fitted kitchen with all white goods fitted.

Master bedroom
19'1" x 8'7" (5.82 x 2.64)

A great sized master bedroom that's carpeted and benefits from a modern en suite.

Bedroom two
15'6" x 6'5" (4.73 x 1.97)

A cosy second bedroom easily fitting all bedroom furniture in and once again carpeted.

Master bathroom
7'4" x 7'0" (2.26 x 2.15)

A modern 3 piece suite neutral in colour and generous in size

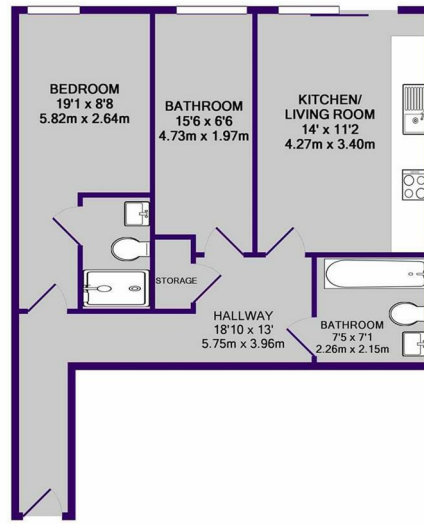

TOTAL APPROX. FLOOR AREA 627 SQ.FT. (58.2 SQ.M.)
Whilst every attempt has been made to ensure the accuracy of the floor plan contained here, measurements of doors, windows, rooms and any other items are approximate and no responsibility is taken for any error, omission, or mis-statement. This plan is for illustrative purposes only and should be used as such by any prospective purchaser. The services, systems and appliances shown have not been tested and no guarantee as to their operability or efficiency can be given
Made with Metropix ©2016



Energy Efficiency Rating		Environmental Impact (CO ₂) Rating	
Current	Potential	Current	Potential
81	81	90	90