



Oxford Road, Gloucester GL1 3EE

£1,300 PCM



Oxford Road, Gloucester GL1 3EE

• Student Property • Four Double Bedrooms • Part-Furnished • Communal Lounge • Rear Garden • EPC Rating D57



Unit C Barge Arm East, Gloucester Docks, GL1 2DQ

01452 398010

docks@naylorpowell.com

www.naylorpowell.com

£1,300 PCM

Kitchen

9'6" x 11'11" (2.90 x 3.65)

Lounge

11'7" x 11'11" (3.55 x 3.65)

Bedroom One

11'11" x 15'8" (3.65 x 4.80)

Bedroom Two

8'6" x 13'11" (2.60 x 4.25)

Bedroom Three

7'8" x 12'1" (2.35 x 3.70)

Bedroom Four

9'8" x 14'1" (2.95 x 4.30)

Shower Room

8'6" x 6'2" (2.60 x 1.90)

Energy Performance Rating

Current: D57. Potential: B81.

Agent Notes

Utilities are not included in the rent, tenants will be responsible for all payments.



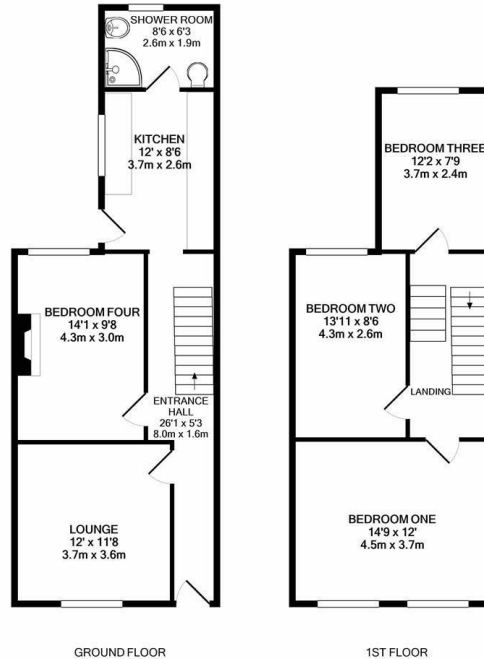

Whilst every attempt has been made to ensure the accuracy of the floor plan contained here, measurements of doors, windows, rooms and any other items are approximate and no responsibility is taken for any error, omission, or mis-statement. This plan is for illustrative purposes only and should be used as such by any prospective purchaser. The services, systems and appliances shown have not been tested and no guarantee as to their operability or efficiency can be given.
Made with Metropix ©2021

Disclaimer: These particulars do not form part of any contract and no responsibility is accepted for any errors or omissions in any statement made, whether verbally or written for or on behalf of Naylor Powell.

Floorplans have been prepared for identification purposes only, they are not to scale and no guarantee can be given as to their accuracy.

Prospective purchasers please be aware none of the appliances, boiler, heaters etc. which may have been mentioned in these particulars have been tested and no guarantee can be given that they are in working order. Prospective purchasers should arrange for such items to be tested at their own expense.

