

SIGNATURE

NORTH EAST

OFFICIALLY RATED THE NO.1 ESTATE AGENT IN THE NORTH EAST





📍 Alma Place, North Shields NE29 0LY

Alma Place

North Shields NE29 0LY

£550,000

Signature North East is proud to welcome to the sales market this immaculate four bedroom, three bathroom mid terrace family home on Alma Place, North Shields. This stunning Victorian property boasts spacious living over three extensive floors, a wealth of original features complemented with modern decor and UPVC sash windows with beautiful plantation shutters.

The property begins in a stylish entrance hallway with high ceilings, original cornicing and a cast iron radiator. From here, access to the first reception room is to the left, overlooking the front of the property. This room benefits from a large bay window with plantation shutters, a feature white marble fire surround and open fire. To the rear of the property is an additional reception room with log burner and is open to the dining kitchen, lending itself as the perfect entertaining space. The kitchen has a full range of high quality wall and floor units in a glossed finish, and a variety of integrated appliances including double oven and fridge freezer. There is also a central island with gas hob, and space for dining under the large roof lantern with bi-folding doors to the rear yard. Also on the ground floor is a handy utility room, a home office and W.C.

On the first floor, the master suite is to the front, spanning the entire width of the property, and showcasing original cornicing and ceiling rose, a feature fireplace and open access to the en-suite bathroom with Burlington sanitary wear. Also on the first floor is an additional double bedroom and the main family bathroom with free standing bath and walk in shower unit.

The second floor is home to a further two double bedrooms, one open to another stylish en-suite bathroom, a dressing room and storage within the eaves.

Externally this property benefits from a large garden with mature trees and planting to the front, with a paved yard to the rear with storage in the out house and an electric roller shutter garage door for off street parking.

PLEASE NOTE THAT THE VENDOR HAS CERTIFIED THE PROPERTY INFORMATION AND IMAGES.





Why Signature?

Signature North East reach 150,000 per month on social media. We cover 19 locations in the North East. At signature we keep our doors open from 8AM - 8PM, when other estate agents are closed. We are a customer 5 star rated agent on allagents.co.uk. With a dedicated group of negotiators across the region, to the 'behind the scenes' Head Office team, each member of staff is passionate about the industry and cares about every client; you're at the heart of everything we do!

PLEASE NOTE THAT THE VENDOR HAS CERTIFIED THE PROPERTY INFORMATION AND IMAGES.

PROPERTY FLOORPLAN

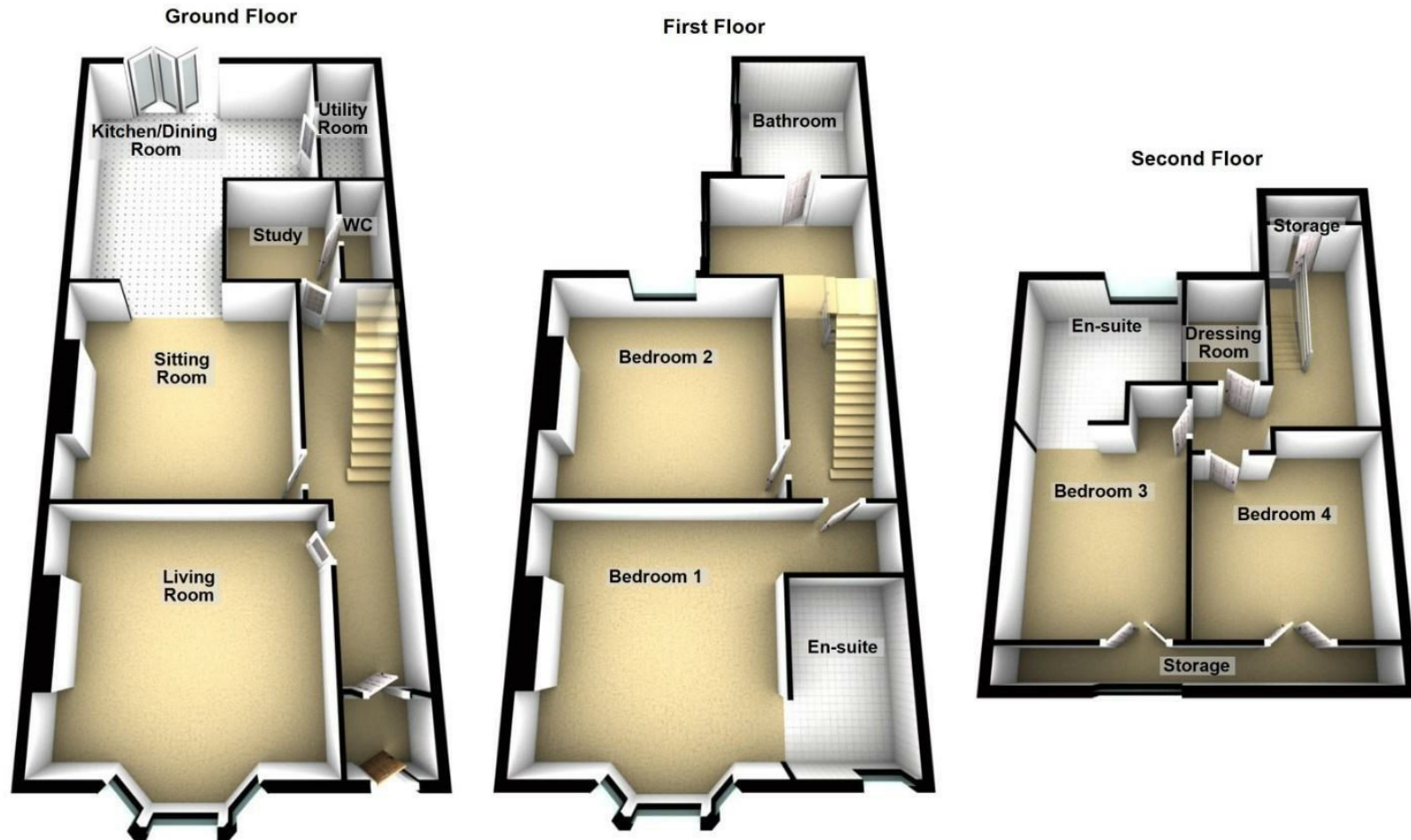

Please be advised the floorplans are not drawn to scale and are to be used to give an idea of the layout of the property.
Plan produced using PlanUp.

EPC RATING:



More 5 Star Customer Reviews than any other Agent based in the North East on allAgents.co.uk



SALES

LETTINGS

FINANCE

LAW

WE COVER THE WHOLE OF THE NORTH EAST

Whitley Bay
0191 251 3344

Cramlington
01670 897 213

Tynemouth
0191 296 6689

Morpeth
01670 513 966

Ponteland
01661 820 082

Wallsend
0191 432 4151

Alnwick
01665 511 800

Heaton
0191 432 4275

Forest Hall
0191 266 9966

Other locations
0191 640 3523

Newcastle
0191 640 2284

Durham
0191 303 8252

Gosforth
0191 640 3523

Sunderland
0191 543 6390

Whickham
0191 432 5102

Gateshead
0191 432 4294

Jesmond
0191 281 1037

Killingworth
0191 640 3602

Ryton
0191 413 9845

Head Office &
Lettings
0191 253 4815

*Highest recommended 5-star reviews than any other Estate Agent based in the North East on allAgents.co.uk - The UK's Largest Customer Review Website for the Property Industry & Awarded Best Estate Agency 2018 & 2019 - North East England by SME News