



29B Selsdon Road

London, SE27 0PQ

£1,050 PCM

A one-bedroom raised ground floor Victorian conversion, which has been neutrally decorated throughout and has a fitted contemporary kitchen. Located on a very popular tree-lined residential street.

- A RAISED GROUND FLOOR VICTORIAN CONVERSION
- ONE BEDROOM
- CENTRAL HEATING
- HIGH CEILINGS
- RECEPTION ROOM WITH BAY WINDOW
- DOUBLE GLAZED WINDOWS
- CONTEMPORARY WHITE KITCHEN WITH APPLIANCES
- BEDROOM WITH BUILT IN WARDROBES
- FITTED CARPETS
- PART/FURNISHED

Viewing

Please contact our Galloways West Norwood Office on if you wish to arrange a viewing appointment for this property or require further information.



Floor Plan

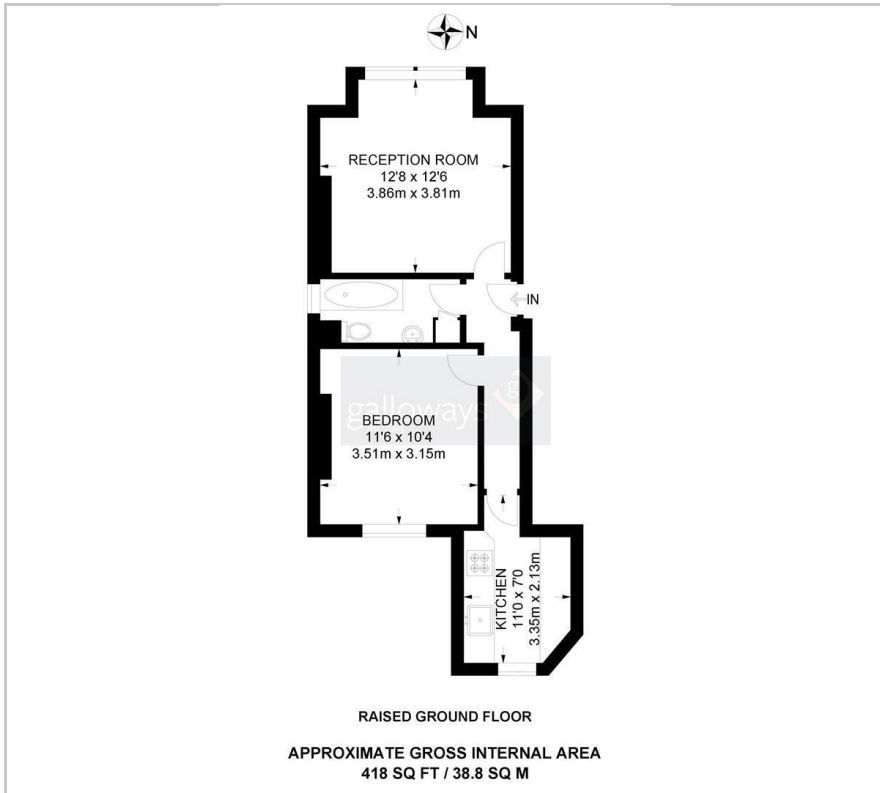

Area Map



Energy Efficiency Graph

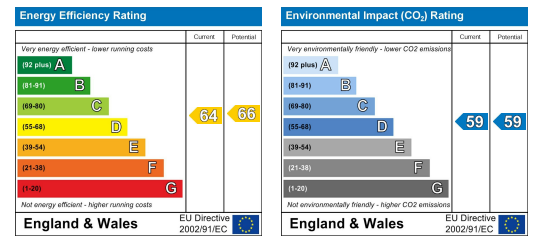

These particulars, whilst believed to be accurate are set out as a general outline only for guidance and do not constitute any part of an offer or contract. Intending purchasers should not rely on them as statements of representation of fact, but must satisfy themselves by inspection or otherwise as to their accuracy. No person in this firm's employment has the authority to make or give any representation or warranty in respect of the property.