



**2A Heath Court
Uxbridge, Middlesex UB8 1NU
£1,272 PCM**

Deposit required £1,467

**Available date 29th July
2021**

**** STUDENT LET ** -
2/3 BEDROOMS -**

The rental payments equate to approx £424 Per person per month or £98 Per person per week excluding bills (AS 3 BEDROOMS) or £116 PPPW inc bills

NuPad Limited are delighted to offer this TWO/THREE double bedroom apartment that has great links via public transport to Heathrow Airport, Ealing and beyond also London Underground station lines too Central London.

The accommodation briefly comprises entrance hallway, large LOUNGE/BEDROOM 3, fitted KITCHEN, TWO DOUBLE BEDROOMS and BATHROOM, gas central heating, double glazed windows.

2A Heath Court, Uxbridge, Middlesex UB8 1NU



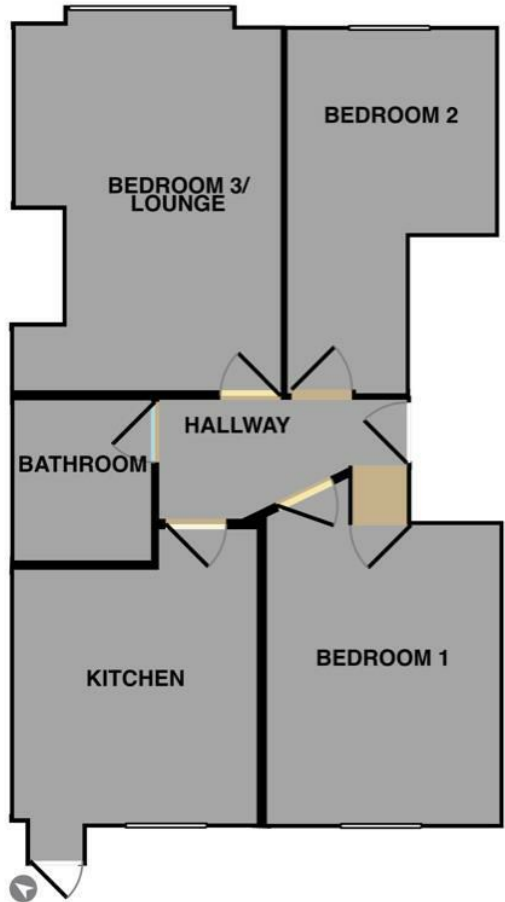

Energy Efficiency Rating		Current	Potential
Very energy efficient - lower running costs			
(92 plus) A			
(81-91) B			
(69-80) C			
(55-68) D		61	64
(39-54) E			
(21-38) F			
(1-20) G			
Not energy efficient - higher running costs			
England & Wales		EU Directive 2002/91/EC	

Environmental Impact (CO ₂) Rating		Current	Potential
Very environmentally friendly - lower CO ₂ emissions			
(92 plus) A			
(81-91) B			
(69-80) C			
(55-68) D		56	60
(39-54) E			
(21-38) F			
(1-20) G			
Not environmentally friendly - higher CO ₂ emissions			
England & Wales		EU Directive 2002/91/EC	