



## 2 Hartforde Road , Borehamwood, WD6 5JU

**Offers In The Region Of £585,000**



ZUPLEX are proud to present this amazing , 4 bedroom house offering immaculately presented living accommodation and a south facing garden. No onward chain!

Executive 4 bedroom home with luxury fittings and a feeling of brand-newness.

There are 4 large double bedrooms, an open-plan generous living space, a stylish modern kitchen with an island and with all the appliances integrated including a substantial double fridge. The Italian travertine stone floor gives it all a luxury look. The entire house is fitted with spotlights and fire doors. 2 bedrooms possess their own en-suite.

Ground floor



## Area Map



## Floor Plans

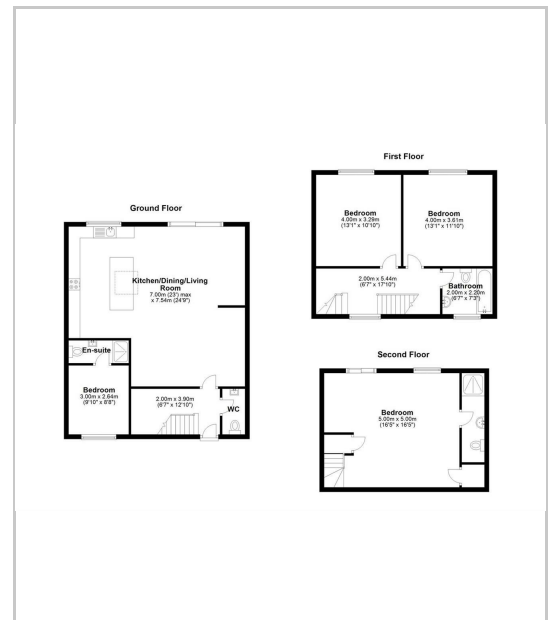

## Energy Efficiency Graph



These particulars, whilst believed to be accurate are set out as a general outline only for guidance and do not constitute any part of an offer or contract. Intending purchasers should not rely on them as statements of representation of fact, but must satisfy themselves by inspection or otherwise as to their accuracy. No person in this firm's employment has the authority to make or give any representation or warranty in respect of the property.