



101 Warehouse Court, No 1 Street,  
Woolwich, London, SE18 6FD  
Asking Price £500,000

**COCKBURN**  
ESTATE AND LETTINGS AGENTS

Two bedroom apartment set within a beautiful riverside development with the added bonus of being offered to the market CHAIN FREE. Comprising two double bedrooms (master en-suite), open plan living/dining area, integrated kitchen, family bathroom and private balcony. There is also secure underground parking. Close by you have Woolwich town centre and fantastic transport links with the DLR on your doorstep keeping you connected with London. Crossrail is coming to the area soon. 988 years remaining on the lease. Service charge is approximately £3,000 per annum and the ground rent is £400 per annum.



## No 1 Street, London, SE18

Total = 710 sq ft / 65.9 sq m

For identification only - Not to scale

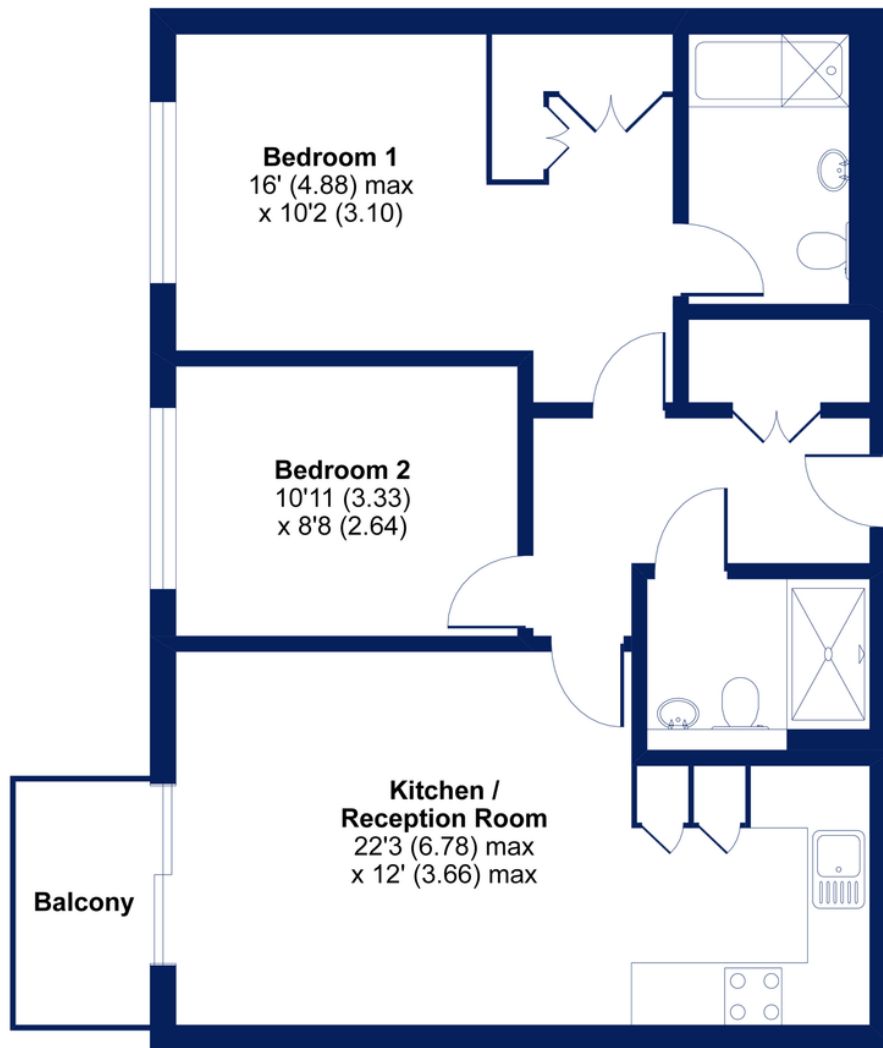

**4th FLOOR**



Floor plan produced in accordance with RICS Property Measurement Standards incorporating International Property Measurement Standards (IPMS2 Residential). © nichecom 2021. Produced for Cockburn Estates Agents. REF: 682337



### Cockburn EA

38 Mottingham Road, Mottingham,  
London, SE9 4QR

t: **020 8857 8857**  
[cockburn-online.co.uk](http://cockburn-online.co.uk)

IMPORTANT: we would like to inform prospective purchasers that these sales particulars have been prepared as a general guide only. A detailed survey has not been carried out, nor the services, appliances and fittings tested. Room sizes should not be relied upon for furnishing purposes and are approximate. If floor plans are included, they are for guidance only and illustration purposes only and may not be to scale. If there are any important matters likely to affect your decision to buy, please contact us before viewing the property.