



Dunedin
Sales & Lettings

7 WOODHAM CLOSE, RUBERY, BIRMINGHAM, B45 9YP
£260,000





DESCRIPTION

The property in brief comprises entrance porch, door into garage with light & power, through lounge/dining room with bay window to front, door into conservatory at the rear, kitchen having a range of wall & base units, gas hob, electric oven, extractor, part tiled walls, tiled floor.

Stairs to first floor landing, master bedroom with built in wardrobes, double bedroom two with built in cupboard, double bedroom three, bathroom comprising a white suit, bath, separate shower cubicle, wc, sink unit, chrome heated towel rail.

OUTSIDE

The front of the property has a drive, lawn, hedged boarder, side gate to access the rear of the property.

The rear garden has a paved patio, lawn, planted boarders, outside tap, paved seating area, outside tap, brick, hedge & fenced boundaries.

LOCATION

Woodham close is a very popular sought after road. It is conveniently situated close to Rubery Great Park & village having a variety of shops, good transport links within easy access to motorway networks and Birmingham City Centre. Nearby to Longbridge retail park for shopping & restaurants.

It is within walking distance to Waseley Hills Country Park, and near by Cofton Park and the Lickey Hills are close by for walking and golf.

TENURE

The vendor has informed us the property is Freehold. Prospective purchasers are advised to verify this with their solicitor.



Woodham Close First Floor

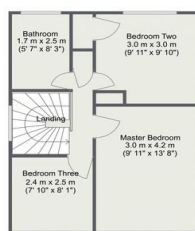

Ground Floor

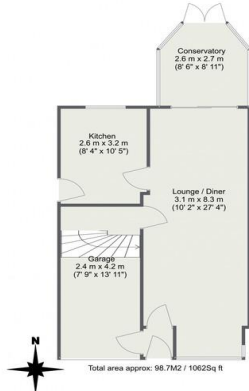

Total area approx. 98.7M2 / 1062Sq ft
For illustrative purposes only. Decorative finishes, fixtures & fittings do not represent the current state of the property. Measurements are approximate & not to scale.