



35 TUNSTALL CLOSE,  
STOKE BISHOP, BS9 1HR

---

GOODMAN  
& LILLEY



SITUATED IN THE POPULAR RESIDENTIAL AREA OF STOKE BISHOP IS THIS DELIGHTFUL ONE DOUBLE BEDROOM GROUND FLOOR APARTMENT LOCATED IN CLOSE PROXIMITY TO NEARBY LOCAL SHOPS AND AMENITIES INCLUDING THE WONDERFUL OPEN SPACE OF DURDHAM DOWNS AND WITH GREAT CENTRAL BRISTOL ACCESS. SO WHETHER YOU'VE BEEN LOOKING FOR YOUR FIRST HOME OR AN INVESTMENT PROPERTY THIS COULD BE THE PERFECT CHOICE.

### Location

This property is in a prime position benefiting from great bus and transport links to Clifton and Bristol City Centre.

### Accommodation

#### Communal Entrance

Via a communal front door with entrance phone system to a communal hall and front door to the apartment.

#### Entrance Hallway

With radiator, built in storage cupboard and doors to:

#### Lounge / Dining Room

Double glazed window to the side looking out onto the communal gardens, dining and sitting areas, radiator and door to the kitchen.

#### Kitchen

A good sized fitted with wall and base units, work surfacing, sink unit, integrated cooking appliances, radiator, double glazed window to the front and a door to walk in storage room housing boiler.

#### Bedroom

Access from the entrance hall is a double bedroom with double glazed window to the side looking out to the communal gardens, radiator.

#### Bathroom

Fitted suite comprising paneled bath with shower over, tiled surrounds, low level WC and hand basin. Double glazed window to the front, large built in storage cupboard.

### Outside

#### Communal Gardens

Located around the buildings.

#### Parking

Resident car parking area.



GUIDE PRICE £160,000





# Floor Plan

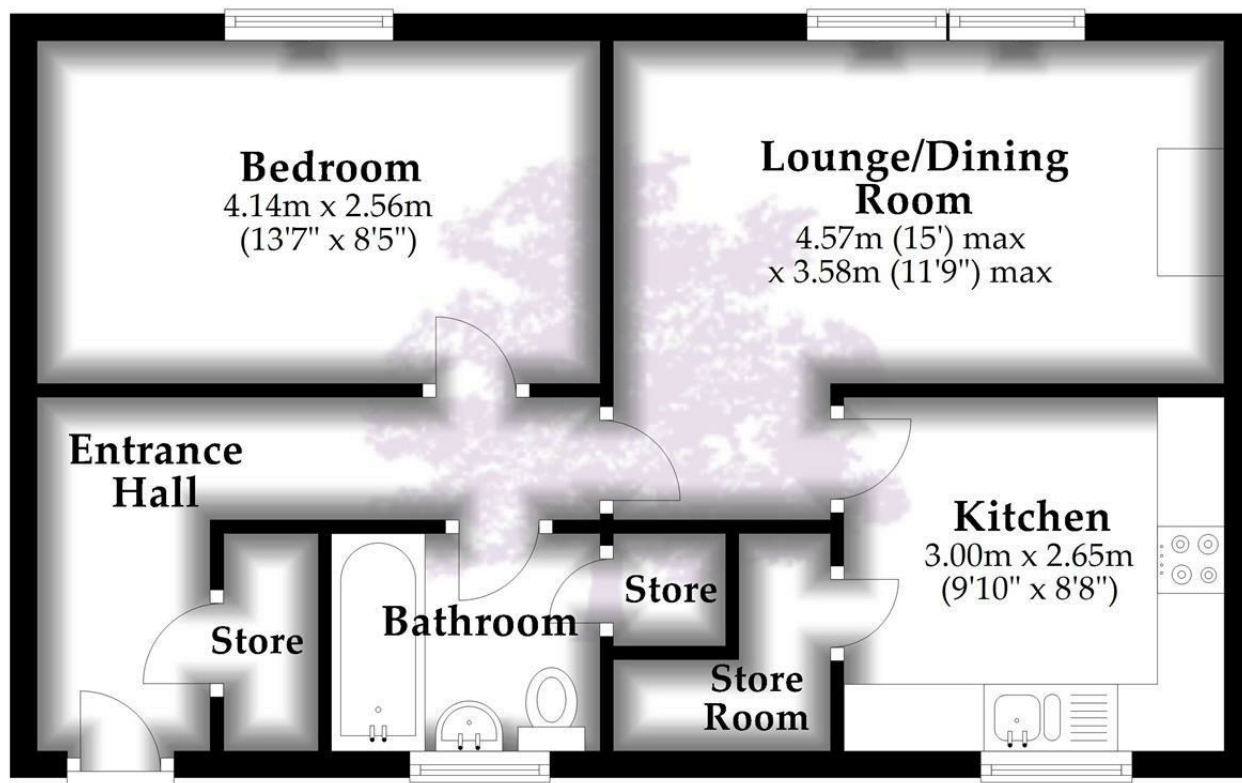

Whilst every attempt has been made to ensure accuracy of the floor plan all measurements are approximate and no responsibility is taken for any error, omission or measurement.

Plan produced using PlanUp.

**HENLEAZE** - 0117 2130777  
henleaze@goodmanlilley.co.uk

**PORTISHEAD** - 01275 430440  
sales@goodmanlilley.co.uk

**SHIREHAMPTON** - 0117 2130333  
shire@goodmanlilley.co.uk

Zoopla.co.uk

rightmove



**WWW.GOODMANLILLEY.CO.UK**

These particulars are for general guidance only. They do not form or constitute any part of an offer or contract. Goodman & Lilley has not carried out structural surveys of the property. The services, appliances or specific fittings mentioned in these details have not been tested. Every attempt is made to ensure accuracy, however all photographs, measurements, floor plans and distances are for illustrative purposes only. They must not be relied upon when purchasing carpets and or other fixtures & fittings. Lease details, service charges and ground rents are given as a guide only. They should be checked and confirmed by a licensed solicitor prior to exchange of contracts. The copyright of all details, photographs and floor plans remain exclusive to Goodman & Lilley.