

129 Queen Street, Morley, Leeds, LS27 8HE

Tel: 0113 253 4151

Email: morley@davidmoor.co.uk

Web: www.davidmoor.co.uk

**David
Moore**



8 Helston Way, Leeds

£625

- End town house,
- Three bedrooms,
- Available from 03.02.21,
- PVC double glazing,
- Night storage heating,
- Unfurnished,
- Well fitted kitchen,
- Bathroom with shower,
- Gardens front and rear,
- Close to motorways and town centre,
- EPC rating E,
- Bond £700.



8 Helston Way, Leeds

End town house,
Three bedrooms,
Available from 03.02.21,
PVC double glazing,
Night storage heating,
Unfurnished,
Well fitted kitchen,
Bathroom with shower,
Gardens front and rear,
Close to motorways and town centre,
EPC rating E,
Bond £700.

Viewing

By appointment with the Agents - Morley office.

Living room 22'2" x 10'9" (6.76m x 3.28m)

With 2 night storage heaters access to kitchen and sliding PVC double glazed patio doors leading to the rear garden

Kitchen 22'2" x 9'6" (6.76m x 2.90m)

Well fitted with inset stainless sink, laminated work surfaces, base cupboard and drawer units and matching wall cupboards. Electric integral oven, 4 ring ceramic hob and cooker hood. Under stairs cupboard, Part glazed PVC front and rear doors.

First floor landing

With airing cupboard, storage cupboard and access to first floor rooms.

Bedroom 1 11'2" x 10'9" (3.40m x 3.28m)

To the front with night storage heater and built in storage cupboard.

Bedroom 2 11'9" x 10'8" (3.58m x 3.25m)

To the rear with electric radiator.

Bedroom 3 11'2" x 6'3" (3.40m x 1.91m)

To the front with electric radiator and storage cupboard.

Bathroom

Tiled to bath and shower area with white suite of panelled bath, pedestal wash basin and low flush WC. Triton electric shower over bath, shower rail and curtain.

Outside

Lawn garden to the front with boundary hedging.

Fenced garden to the rear with paved patio, side borders and garden shed.

Disclaimer

N. B. Please note all measurements are taken by a laser tape measure, their accuracy, therefore cannot be guaranteed. All Services - Electrical or otherwise are not tested. Any references to any wood or metals e.g. Mahogany, pine, brass, copper etc. Relate only to the colour and effect and do not imply the products are made of these materials. The 3D plan is a representation of design and does not reflect fittings and finishes.

Information

David Moor are members of the Property Redress Scheme and Client Money Protect.



Ground Floor

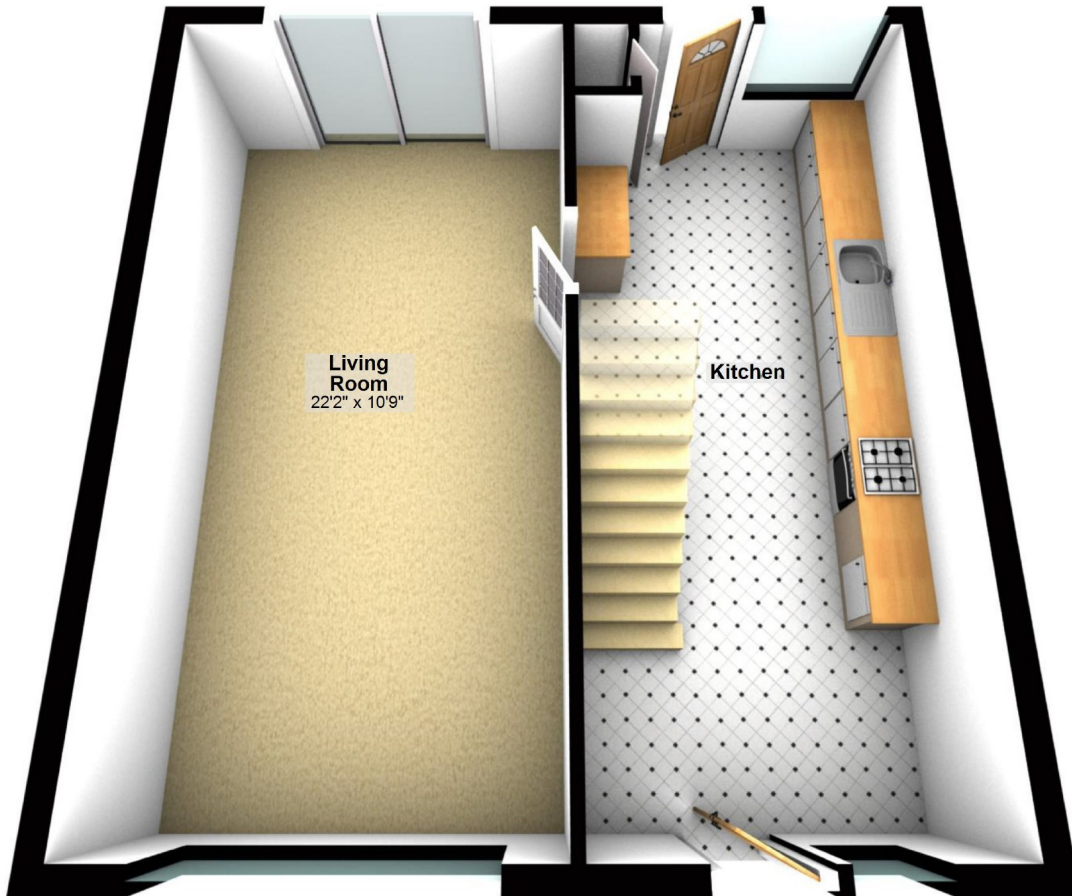

First Floor

