



Luxton Road, Ogwell, TQ12 6YQ

£725 pcm



- Mid Terrace House
- Lounge
- Newly Fitted Kitchen
- 2 Double Bedrooms
- Bathroom
- Gas Central Heating
- Upvc Double Glazing
- Patio Garden
- Allocated Parking Space
- EPC - TBC



Call 01626 883156  
to find out more

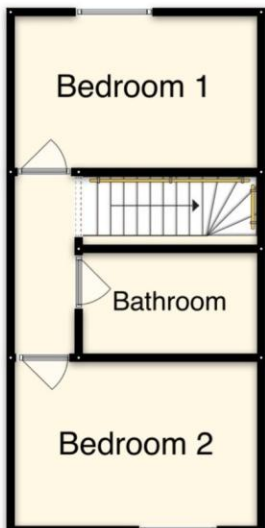
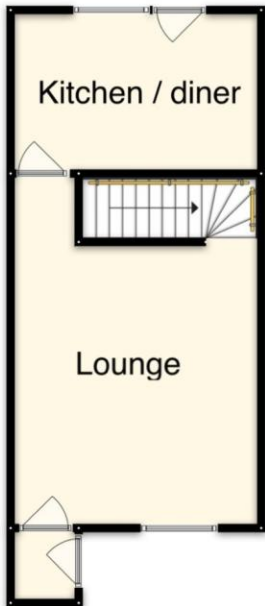

## Description

Accommodation comprises entrance porch, lounge, newly fitted kitchen / dining room, 2 double bedrooms and bathroom. Outside there are front and rear patio gardens and an allocated parking space. The property has gas central heating and upvc double glazing.

Located in Ogwell but not too far away from the bustling life of Newton Abbot. This is ideal for anyone looking for a property either close to the local primary school, or wanting good access to Newton Abbot, Totnes or the surrounding areas. Newton Abbot itself offers a comprehensive range of shops and amenities including supermarkets, cinema, health centres, library, primary and secondary schools, restaurants and churches. The town also benefits from good sporting facilities, including a well equipped sports centre with swimming pool and tennis courts. There is a mainline railway station and bus station.

## Useful Information

Council Tax Band: B £1518.22 (2020 / 2021) | Heating: Gas Central Heating | Internet: Average 33Mb - 36Mb (According to BT.com)

Based on rent of £725pcm

Holding deposit - £167 | Deposit - £836

## Directions

From Newton Abbot pick up the A381 Totnes Road. At the Ogwell roundabout take the 3rd exit (turn right) into Ogwell Road. Take the 1st left into Reynell Road and then third left into Luxton Road. The property can be found towards the top on the right hand side.

## Measurements

LOUNGE	17' 2" x 12' (5.23m x 3.66m)
KITCHEN/DINER	12' x 7' 7" (3.66m x 2.31m)
BEDROOM 1	12' x 8' 2" (3.66m x 2.49m)
BEDROOM 2	12' x 7' 8" (3.66m x 2.34m)
BATHROOM	8' 10" x 5' (2.69m x 1.52m)