



1 Lester Mews R/O 45 Frederick Street, Luton, LU2 7QJ
£825 PCM



- TWO BEDROOMS
- GAS CENTRAL HEATING
- AVAILABLE NOW

- TOWN CENTRE
- FULLY FURNISHED
- MUST BE VIEWED

- 2 MINUTE WALK TO STATION
- WHITE GOODS INCLUDED

*** P&R PROPERTY LETTINGS *** TWO BEDROOM MEWS HOUSE *** TOWN CENTRE LOCATION *** AVAILABLE FULLY FURNISHED *** 2 MINUTES WALK TO STATION AND TOWN CENTRE *** GAS CENTRAL HEATING *** AVAILABLE FOR IMMEDIATE MOVE IN *** MUST BE VIEWED *** WHITE GOODS INCLUDED ****

LIVING ROOM 11'3" X 19'2" (3.42M X 5.83M)

Two windows to front, stairs.

KITCHEN 11'3" X 6'2" (3.42M X 1.89M)

Window to front, door.

HALL

BEDROOM 1 11'3" X 11'6" (3.42M X 3.51M)

Window to front, door.

BEDROOM 2 7'8" X 6'10" (2.33M X 2.09M)

Window to front, door to:

BATHROOM

Window to front, Storage cupboard, door to:

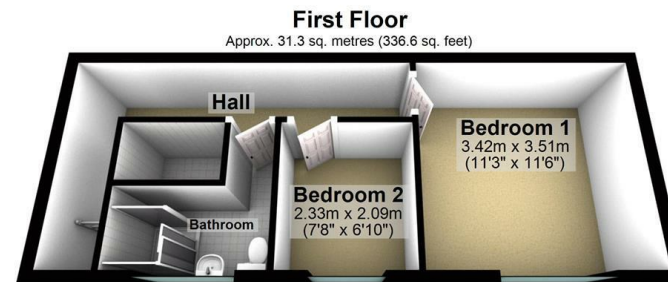
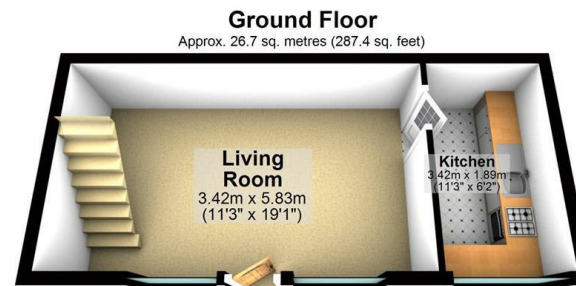

Total area: approx. 58.0 sq. metres (624.1 sq. feet)
2 Lester Mews, Luton

Energy Efficiency Rating		Current	Potential
Very energy efficient - lower running costs			
(92 plus)	A		
(81-91)	B		
(69-80)	C		
(55-68)	D		
(39-54)	E		
(21-38)	F		
(1-20)	G		
Not energy efficient - higher running costs			
England & Wales		EU Directive 2002/91/EC	