



**\*\*AVAILABLE IMMEDIATELY\*\***  
**\*\*UNFURNISHED\*\*** **\*\*OFF STREET PARKING\*\*** **\*\*PET FRIENDLY\*\*** Situated in the prestigious location of Jesmond Park West, this two bedroom apartment is found on the ground floor of the High Dene development. This smart property boasts a pleasant outlook, off street parking and is ideal for a professional couple or single occupant.



The property briefly comprises a communal entrance hallway with stairs to all floors. The apartment itself has two double bedrooms, both with fitted wardrobe space; a spacious lounge with dual aspect outlook; a modern fitted kitchen with appliances; there is also a family bathroom WC with storage cupboard. Recently redecorated and available on an unfurnished basis, this is a great apartment ideal for either a couple or single occupant.

Externally there are well kept communal gardens, one allocated off street parking space as well as off street bays for residents parking.

Available Immediately | £625pcm | Unfurnished | Ground Floor Apartment | 468 Sq ft (43.5 m2) | Lounge | Modern Kitchen | Two Bedrooms | Bathroom WC | Recently Redecorated | Pet Friendly Property | Communal Gardens | Great Location | Off Street Allocated Parking | DG & GCH | EPC Rating: C

GROUND FLOOR  
 468 sq.ft. (43.5 sq.m.) approx.

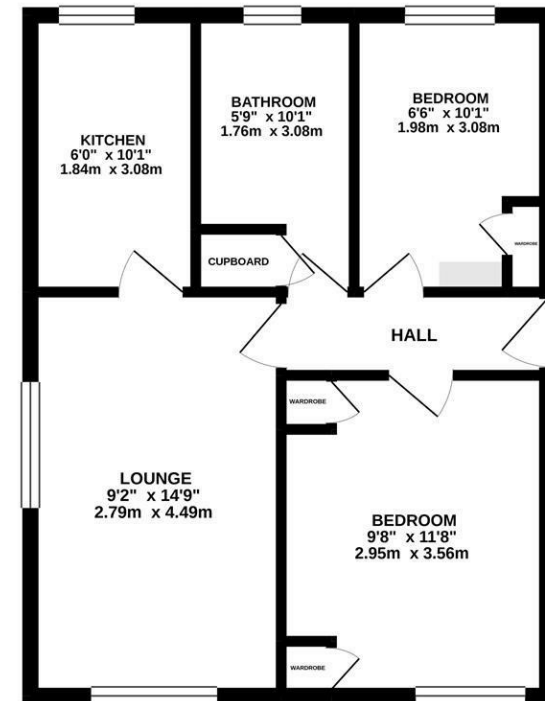

**£625 PCM**

Misrepresentation Act 1967. These particulars and the descriptions and measurements herein do not constitute representation and whilst every effort has been made to ensure accuracy, this cannot be guaranteed.

TOTAL FLOOR AREA: 468 sq.ft. (43.5 sq.m.) approx.  
 Whilst every attempt has been made to ensure the accuracy of the floorplan contained here, measurements of doors, windows, rooms and any other items are approximate and no responsibility is taken for any error, omission or mis-statement. This plan is for illustrative purposes only and should be used as such by any prospective purchaser. The services, systems and appliances shown have not been tested and no guarantee as to their operability or efficiency can be given.  
 Made with MetreX ©2023.

