

Belmont Road

Cheltenham GL52 2NJ



Rose Lawn, Belmont Road, Cheltenham, GL52 2NJ

A one bedroom ground floor apartment located in a quiet cul de sac, just a short walk to Cheltenham Town Centre. The apartment would be ideal for a first time buyer or investor with an estimated rental income of £650pcm. The accommodation briefly comprises:- an entrance hall, living room, separate kitchen with appliances which include an oven, hob and washing machine, a double bedroom and walk in shower room. The apartment further benefits from allocated off road parking, communal gardens, gas central heating and is chain free.





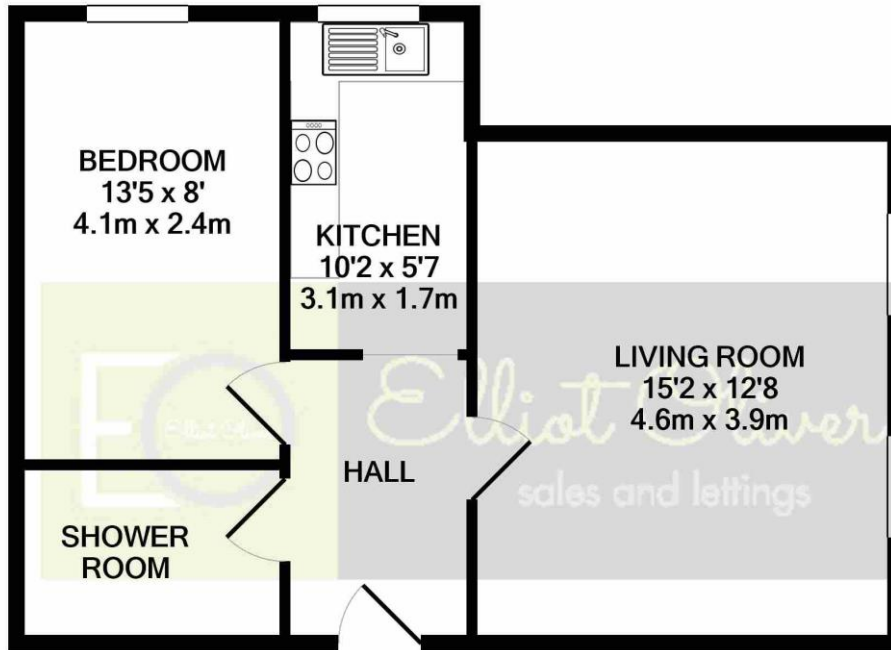

TOTAL APPROX. FLOOR AREA 447 SQ.FT. (41.5 SQ.M.)

Whilst every attempt has been made to ensure the accuracy of the floor plan contained here, measurements of doors, windows, rooms and any other items are approximate and no responsibility is taken for any error, omission, or mis-statement. This plan is for illustrative purposes only and should be used as such by any prospective purchaser. The services, systems and appliances shown have not been tested and no guarantee as to their operability or efficiency can be given

Made with Metropix ©2021

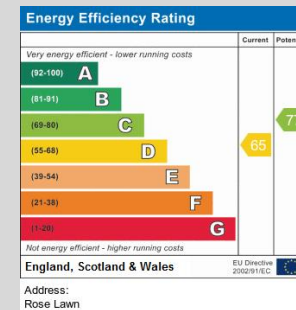

OFFICE

101 Promenade,
Cheltenham,
Gloucestershire, GL50
1NW

info@elliottoliver.co.uk