



Annandale Road, Hull, HU9 4LT  
Offers Over £100,000

  
**Philip  
Bannister**  
Estate & Letting Agents



# Annandale Road, Hull, HU9 4LT

Situated on a larger than average plot this property has recently undergone a complete renovation and is an ideal purchase for first time buyers and investors alike. With ample off street parking, stunning new kitchen and bathrooms this property must be viewed early to avoid disappointment.

## Key Features

- Newly Renovated
- Modern Kitchen
- Contemporary Bathroom
- 3 Bedrooms
- Bigger Than Average Plot
- Ample Off-Street Parking
- No Onward Chain
- Immaculately Presented
- Ideal For First Time Buyers
- EPC = D

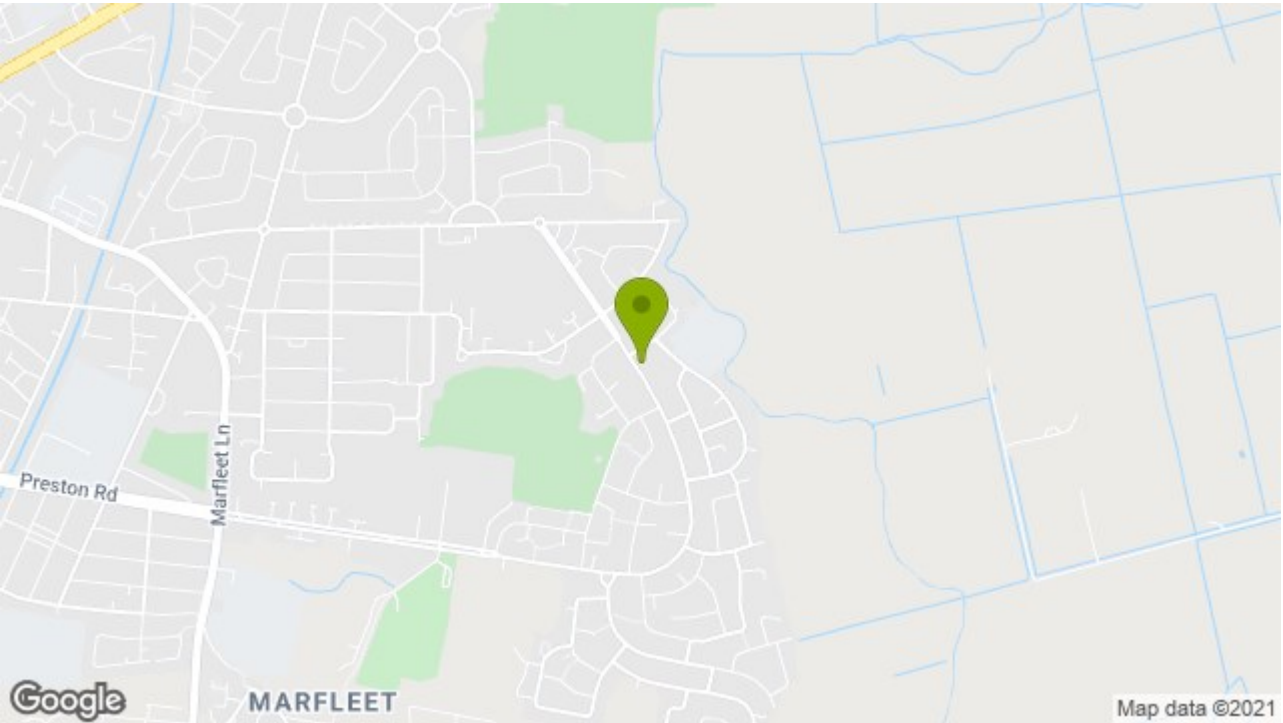
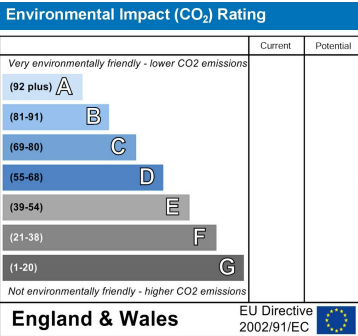
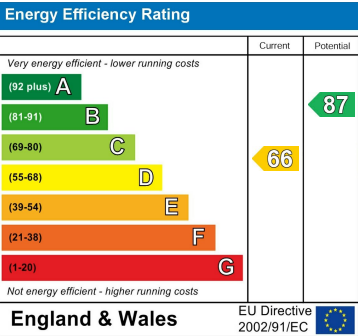





## ENTRANCE HALL

Providing access to the living room and the first floor accommodation via the staircase.

## LIVING ROOM

14'10 x 13'2 (4.52m x 4.01m )

A generously sized living space with window to the front elevation and access to a under stairs storage cupboard.

## KITCHEN

16'7 x 8'1 (5.05m x 2.46m)

Stunning newly fitted kitchen with white gloss wall and base units with contrasting work surfaces. Integrated appliances include Electric Oven and Electric Hob. Also benefitting from recessed spotlights and a vertical radiator. With French doors leading to the rear garden.

## FIRST FLOOR ACCOMMODATION;

### BEDROOM 1

13 x 11'1 (3.96m x 3.38m )

A bedroom of double proportions with two storage cupboards and a window to the front elevation.

### BEDROOM 2

11'1 x 10'2 (3.38m x 3.10m )

A further bedroom of double proportions with a window to the rear elevation.

### BEDROOM 3

7'1 x 9'11 max (2.16m x 3.02m max)

A bedroom of single proportions with a window to the front elevation.

## BATHROOM

7'10 x 5'5 (2.39m x 1.65m )

Contemporary three piece bathroom suite comprising of Panelled Bath with Overhead Shower; Vanity Sink

and WC Unit. Also benefits from recessed spotlights and a heated towel rail with a window to the rear elevation.

## EXTERNAL;

### FRONT

Providing ample off street parking with a gravelled front and turfed lawn to the side with fenced borders.

### REAR

Block paved patio, turfed lawn with fenced borders and two storage outhouses.

## GENERAL INFORMATION

SERVICES - Mains water, electricity, gas and drainage are connected to the property.

CENTRAL HEATING - The property has the benefit of a gas fired central heating system to panelled radiators.

DOUBLE GLAZING - The property has the benefit of replacement PVC double glazed frames OR The property has the benefit of sealed unit double glazing.

SECURITY - The property has the benefit of an installed burglar alarm system.

COUNCIL TAX - From a verbal enquiry/online check we are led to believe that the Council Tax band for this property is Band . (East Riding Of Yorkshire/ Hull City Council). We would recommend a purchaser make their own enquiries to verify this.

VIEWING - Strictly by appointment with the sole agents.

FIXTURES & FITTINGS - Carpets, curtains & light fittings may be purchased with the property and these will be specified upon inspection but would be subject to separate negotiation.

## VIEWINGS

## MORTGAGES

The mortgage market changes rapidly and it is vitally important you obtain the right advice regarding the best mortgage to suit your circumstances.

We are able to offer professional Mortgage Advice without any obligation. A few minutes of your valuable time could save a lot of money over the period of the Mortgage.

Professional Advice will be given by Licensed Credit Brokers. Written quotations on request. Your home is at risk if you do not keep up repayments on a mortgage or other loan secured on it.

## THINKING OF SELLING?

We would be delighted to offer a FREE - NO OBLIGATION appraisal of your property and provide realistic advice in all aspects of the property market. Whether your property is not yet on the market or you are experiencing difficulty selling, all appraisals will be carried out with complete confidentiality.

## AGENTS NOTES

Philip Bannister & Co.Ltd for themselves and for the vendors or lessors of this property whose agents they are give notice that (i) the particulars are set out as a general outline only for the guidance of intending purchasers or lessees, and do not constitute any part of an offer or contract (ii) all descriptions, dimensions, references to condition and necessary permissions for use and occupation, and other details are given in good faith and are believed to be correct and any intending purchaser or tenant should not rely on them as statements or representations of fact but must satisfy themselves by inspection or otherwise as to the correctness of each of them (iii) no person in the employment of Philip Bannister & Co.Ltd has any authority to make





or give any representation or warranty whatever in relation to this property. If there is any point which is of particular importance to you, please contact the office and we will be pleased to check the information, particularly if you contemplate travelling some distance to view the property.

### **AGENTS NOTES (continued)**

Philip Bannister & Co.Ltd for themselves and for the vendors or lessors of this property whose agents they are give notice that (i) the particulars are set out as a general outline only for the guidance of intending purchasers or lessees, and do not constitute any part of an offer or contract (ii) all descriptions, dimensions, references to condition and necessary permissions for use and occupation, and other details are given in good faith and are believed to be correct and any intending purchaser or tenant should not rely on them as statements or representations of fact but must satisfy themselves by inspection or otherwise as to the correctness of each of them (iii) no person in the employment of Philip Bannister & Co.Ltd has any authority to make or give any representation or warranty whatever in relation to this property. If there is any point which is of particular importance to you, please contact the office and we will be pleased to check the information, particularly if you contemplate travelling some distance to view the property. Philip Bannister & Co.Ltd advise they do not test fitted appliances, electrical and plumbing installation or central heating systems, nor have they undertaken any type of survey on this property. These particulars are issued on the strict understanding that all negotiations are conducted through Philip Bannister & Co.Ltd. And prospective purchasers should check on the availability of the property prior to viewing, Photograph Disclaimer - In order to

capture the features of a particular room we will mostly use wide angle lens photography. This will sometimes distort the image slightly and also has the potential to make a room look larger. Please therefore refer also to the room measurements detailed within this brochure.

In compliance with NTSEAT Guidance on Referral Fees, the agent confirms that vendors and prospective purchasers will be offered estate agency and other allied services for which certain referral fees/commissions may be made available to the agent. Services the agent and/or a connected person may earn referral fees/commissions from Financial Services, Conveyancing and Surveys. Typical Financial Services referral fee I2I Financial Planning Group Ltd £124.42, Peace of Mind Financial Solutions Ltd (figure to be updated), Foster Denovo (figure to be updated). Typical Conveyancing Referral Fee: Brewer Wallace Solicitors £100 Bridge McFarland LLP £100 Lockings Solicitors £100







GROUND FLOOR  
372 sq.ft. (34.6 sq.m.) approx.

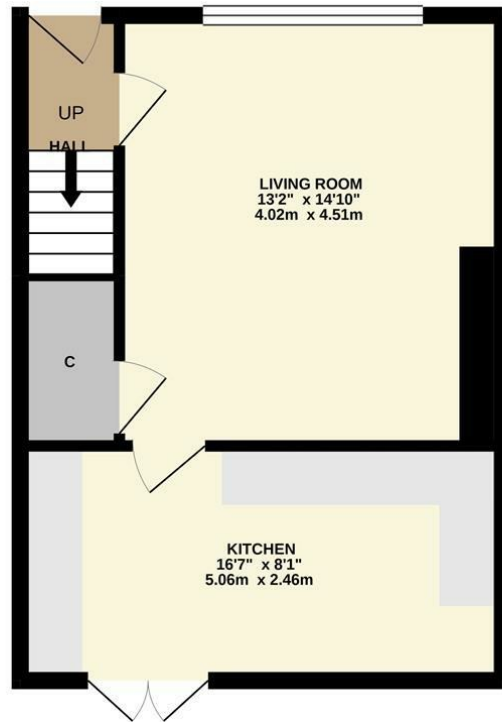

1ST FLOOR  
424 sq.ft. (39.4 sq.m.) approx.

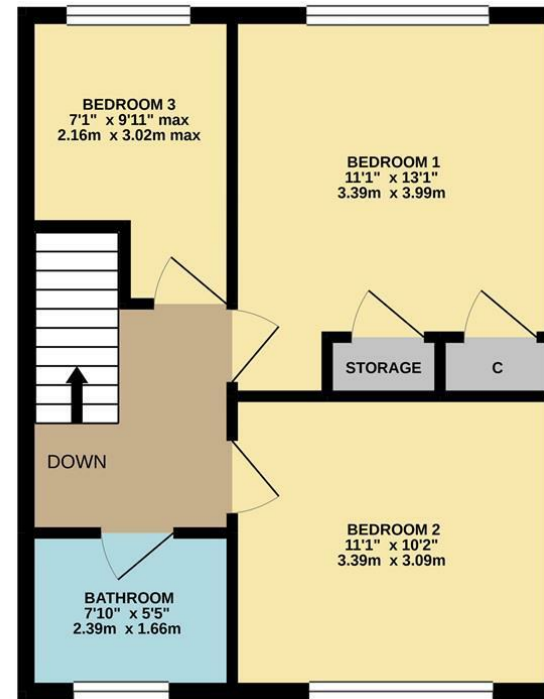

TOTAL FLOOR AREA : 796 sq.ft. (73.9 sq.m.) approx.

Whilst every attempt has been made to ensure the accuracy of the floorplan contained here, measurements of doors, windows, rooms and any other items are approximate and no responsibility is taken for any error, omission or mis-statement. This plan is for illustrative purposes only and should be used as such by any prospective purchaser. The services, systems and appliances shown have not been tested and no guarantee as to their operability or efficiency can be given.  
Made with Metropix ©2021

