



Bonehurst Road
Horley, Surrey, RH6 8GB

£1,050 pcm

Property Summary

Greenaway Residential Estate Agents are delighted to offer to let this modern and well presented two double bedroom second floor apartment, located in the desirable town of Horley.

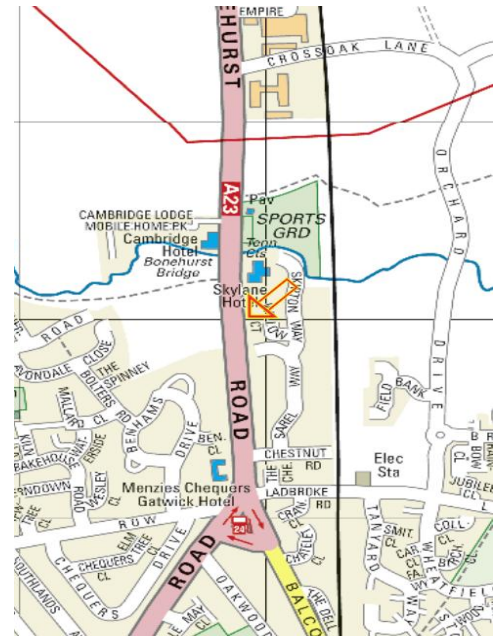
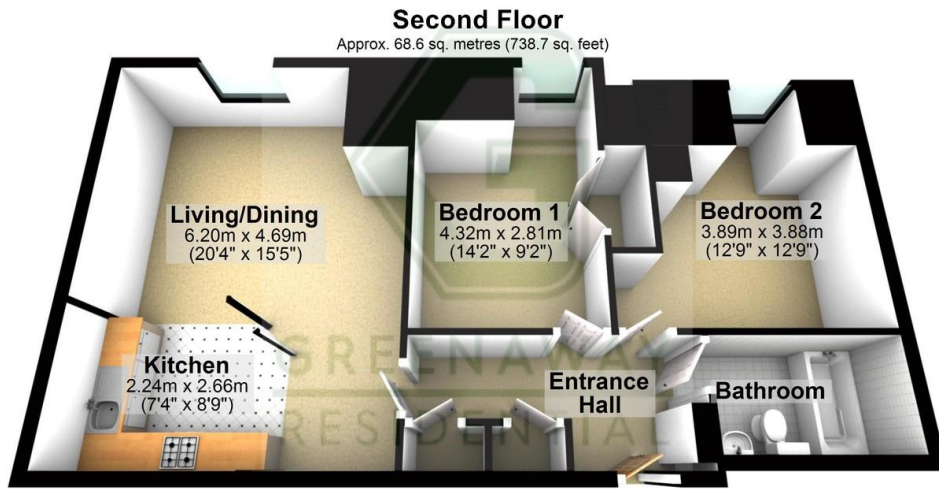

Total area: approx. 68.6 sq. metres (738.7 sq. feet)

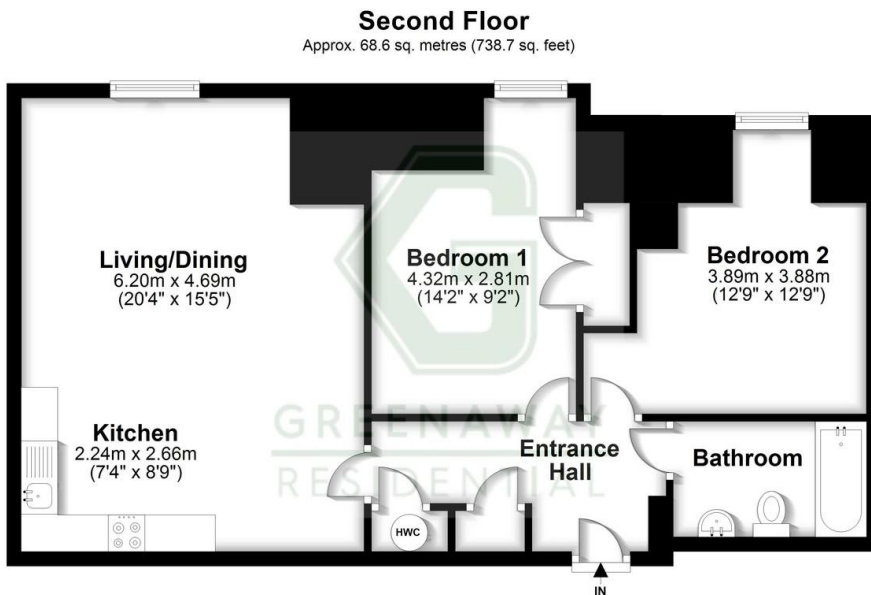

Total area: approx. 68.6 sq. metres (738.7 sq. feet)

- Modern apartment
- Open plan living/dining/kitchen area
- Radiator central heating
- 3 miles to London Gatwick Airport
- Available immediately
- Two double bedrooms
- Bathroom with shower (over the bath)
- Allocate parking space + visitors parking
- 1 mile to Horley train station
- Unfurnished

Boscobel House
109 High Street
Crawley, West Sussex
RH10 1DD

www.greenawayresidential.com
info@greenawayresidential.com
01293 561188

Agents Note: Whilst every care has been taken to prepare these particulars, they are for guidance purposes only. All measurements are approximate and for general guidance purposes only and whilst every care has been taken to ensure their accuracy, they should not be relied upon and potential tenants are advised to recheck the measurements