



- Modern House

Entrance hall

Cloakroom

Kitchen

Lounge

Landing

Bedroom One

Bedroom Two

Bathroom

Garden

Allocated parking

Date created

28.01.2021

Agents Note

Should your offer be accepted

In line with The Money Laundering Regulations 2007 we are duty bound to carry out due diligence on all of our clients to confirm their identity. In the first instance, we will carry out a traditional method in which you will have to produce multiple utility bills and a photographic ID. We will also use an electronic verification system alongside obtaining your identity documents. This system allows us to verify you from basic details using electronic data, however it is not a credit check of any kind so will

- Two Double bedrooms

have no effect on you or your credit history. You understand that we will undertake a search with Experian for the purposes of verifying your identity. To do so, Experian may check the details you supply against any particulars on any database (public or otherwise) to which they have access. They may also use your details in the future to assist other companies for verification purposes. A record of the search will be retained.

EPC B84

- Very well presented

Available upon request

DIRECTIONS

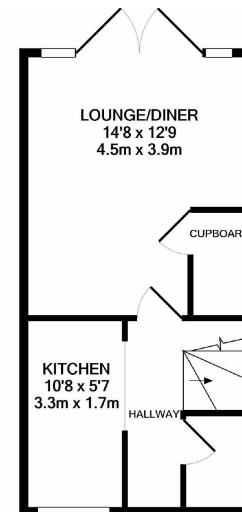
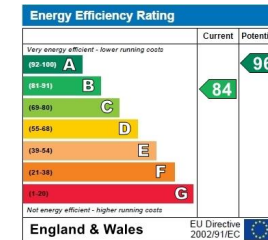

GROUND FLOOR
APPROX. FLOOR
AREA 322 SQ.FT.
(29.9 SQ.M.)

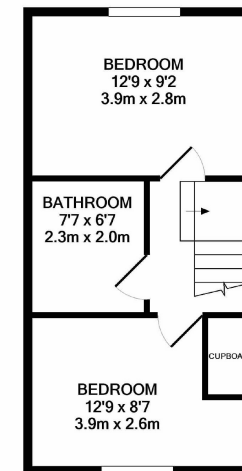

1ST FLOOR
APPROX. FLOOR
AREA 322 SQ.FT.
(29.9 SQ.M.)

TOTAL APPROX. FLOOR AREA 644 SQ.FT. (59.8 SQ.M.)
Whilst every attempt has been made to ensure the accuracy of the floor plan contained here, measurements of doors, windows, rooms and any other items are approximate and no responsibility is taken for any error, omission, or mis-statement. This plan is for illustrative purposes only and should be used as such by any prospective purchaser. The services, systems and appliances shown have not been tested and no guarantee as to their operability or efficiency can be given
Made with Metropix ©2021