



Middlesborough Close

Stevenage | SG1 4TJ

Agent Hybrid



# Middlesborough Close

Stevenage | SG1 4TJ

Guide Price £250,000 - £260,000



Agent Hybrid welcomes to the market, a well presented, Two Bedroom Mid Terrace Home located on the fringe of Great Ashby. An ideal first time or investment purchase, accommodation briefly comprises of; A newly fitted front door entering a good sized, front facing Lounge. From here a door leads to a Modern Shaker Style Kitchen/Diner. Stairs from the lounge rise to the first-floor landing, where doors lead to Two Double Bedrooms and the Bathroom. Heating comes by way of electric storage heaters. Windows have been upgraded to UPVC throughout. The current occupier previously had approved plans to build a porch to the front of the property. Externally, the property benefits from a Private Rear Garden and Parking Space to the front. Viewing comes highly recommended.

- Lounge 15'6 x 11'11
- Kitchen/Diner 11'11 x 9'3
- Bedroom 1: 11'11 x 9'1
- Bedroom 2: 11'11 x 7'3
- Bathroom



## Ground Floor

Approx. 26.8 sq. metres (288.5 sq. feet)

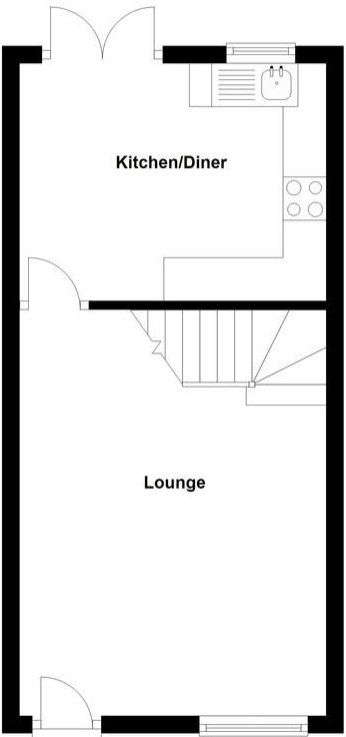

## First Floor

Approx. 26.8 sq. metres (288.5 sq. feet)

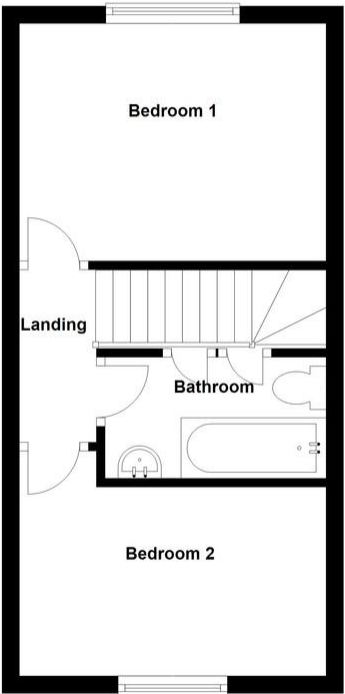

Total area: approx. 53.6 sq. metres (577.0 sq. feet)

IMPORTANT: we would like to inform prospective purchasers that these sales particulars have been prepared as a general guide only. A detailed survey has not been carried out, nor the services, appliances and fittings tested. Room sizes should not be relied upon for furnishing purposes and are approximate. If floor plans are included, they are for guidance only and illustration purposes only and may not be to scale. If there are any important matters likely to affect your decision to buy, please contact us before viewing the property.

### Agent Hybrid

57 High Street, Stevenage, Hertfordshire, SG1 3AQ  
Tel: 01438 870673 | enquiries@agenthybrid.co.uk  
www.agenthybrid.co.uk

# Agent Hybrid