

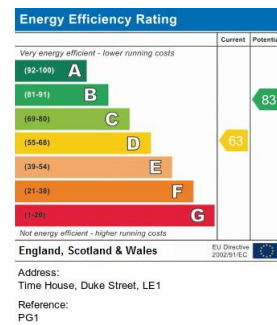

# Property Summary

This neatly presented first floor one bedroom apartment is situated in the City Centre set within the desirable Time House Development. The accommodation comprises of communal entrance lobby and access to stairs and main private entrance hallway, open plan living space with fitted kitchen and Juliet balcony, bathroom, bedroom. Contact agent for further details on Lease and Service Charges.

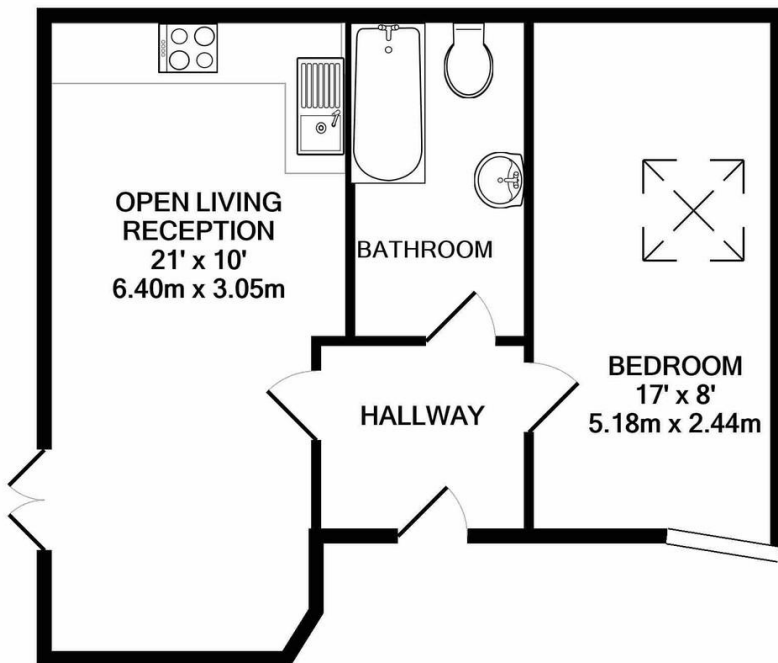

- City Centre Apartment
- One Bedroom
- First Floor
- Desirable Location
- Communal Lobby Access
- Open Plan Living Reception
- Bedroom With Skylight Window
- Neatly Presented

PHILLIPS GEORGE LTD  
TOTAL APPROX. FLOOR AREA 443 SQ.FT. (41.2 SQ.M.)

Whilst every attempt has been made to ensure the accuracy of the floor plan contained here, measurements of doors, windows, rooms and any other items are approximate and no responsibility is taken for any error, omission, or mis-statement. This plan is for illustrative purposes only and should be used as such by any prospective purchaser. The services, systems and appliances shown have not been tested and no guarantee as to their operability or efficiency can be given  
Made with Metropix ©2021

phillips george | sales & lettings

Agents Note: Whilst every care has been taken to prepare these sales particulars, they are for guidance purposes only. All measurements are approximate and for general guidance purposes only and whilst every care has been taken to ensure their accuracy, they should not be relied upon and potential buyers are advised to recheck the measurements

46 Long Street, Wigston, Leicestershire, LE18 2AH

info@phillipsgeorge.co.uk  
0116 216 8178

