



2 Rotherlade Road

Langland, Swansea, SA3 4QN

£435,000



3



null



null



Dawsons
all things property

GENERAL INFORMATION

Located within this sought-after residential area, close to the bays of Rotherlade and Langland we present an unmissable opportunity to acquire a brand-new, purpose built apartment.

Occupying the entire first floor of this select development of just three luxury dwellings, Plot 2 offers 2/3 bedroom accommodation measuring approximately 110sq m (1184 sq ft) comprising a spacious open plan Living room/kitchen, a shower room and an ensuite to the master bedroom. Allocated parking for two cars.

Specification

Kitchen
Range of high gloss Cashmere® handleless wall and base units with Quartz worktops and upstands incorporating drainer-grooves and undermount composite 1.5 bowl sink with feature Hot Water Tap'
Neff® eye-level hide and slide' oven with
Neff® combination microwave oven and grill above



FULL DESCRIPTION

FLOOR PLAN

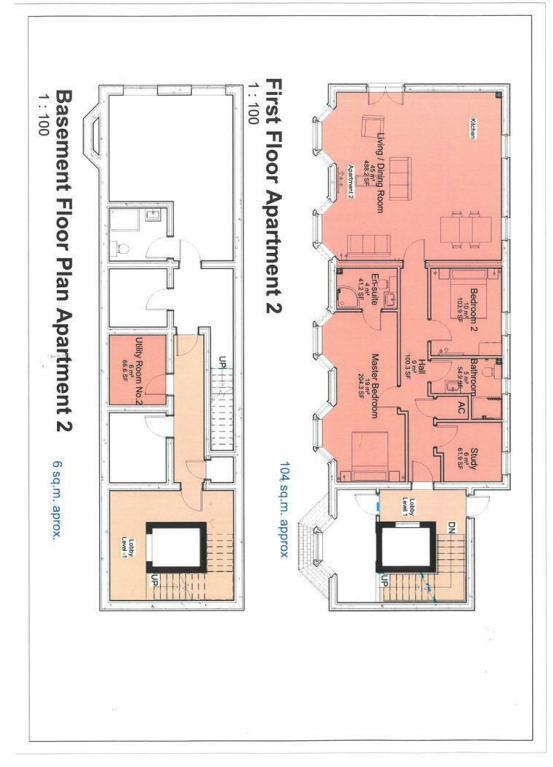

EPC

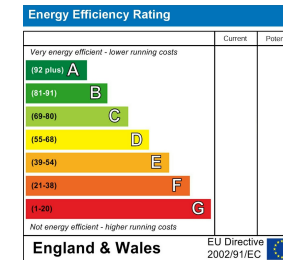

These particulars, whilst believed to be accurate are set out as a general outline only for guidance and do not constitute any part of an offer or contract. Intending purchasers should not rely on them as statements or representations of fact, but must satisfy themselves by inspection or otherwise as to their accuracy. No person in this firm's employment has the authority to make or give any representation or warranty in respect of the property.

Unit A Meridian Bay, Swansea, SA1 1PG
T 01792 653 100 E jharris@dawsonsproperty.co.uk
W dawsonsproperty.co.uk

